

Double-end tenoners FPL 260

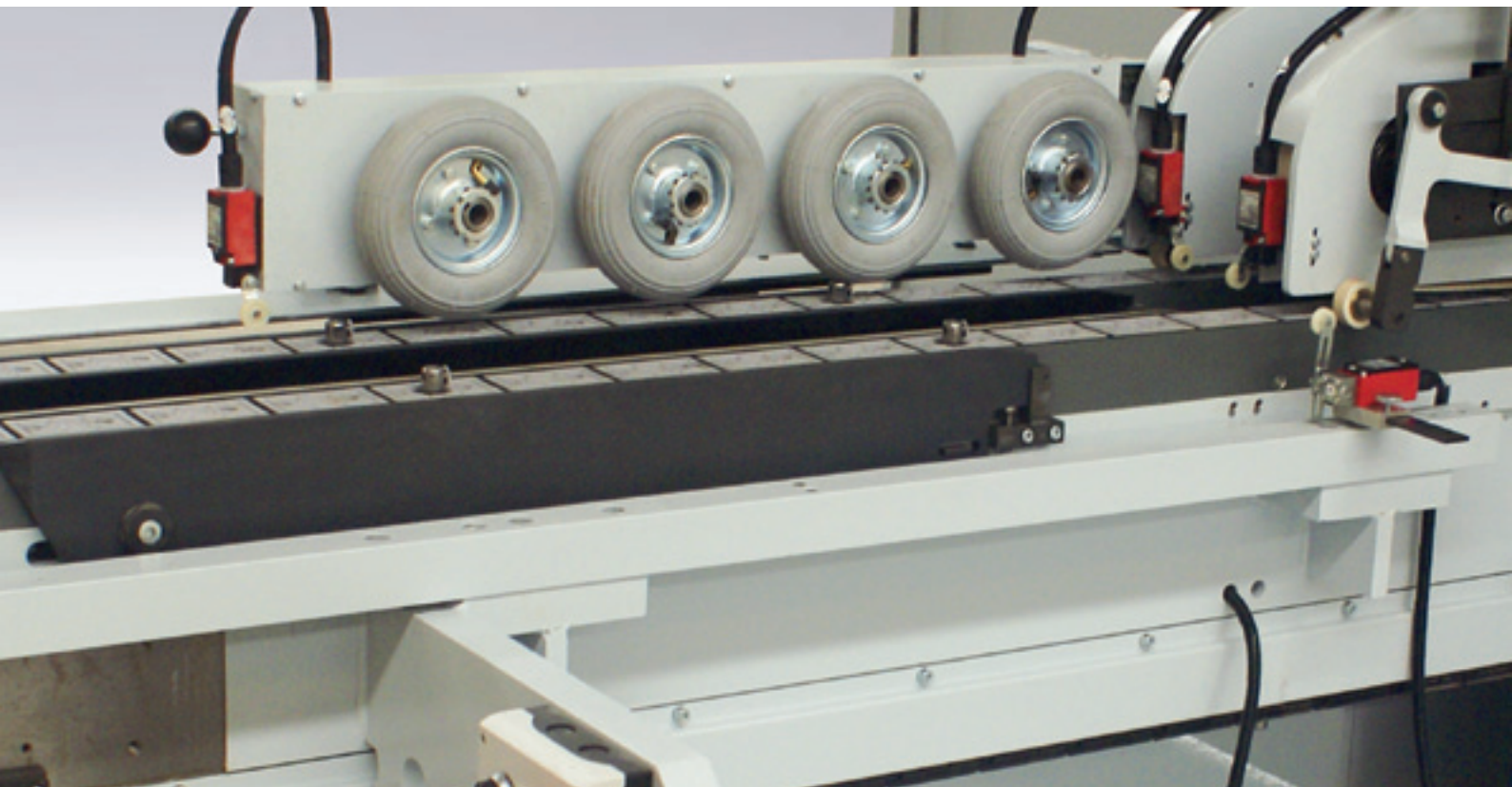

**Powerful, compact and versatile for the sizing
of furniture parts**

Is top class quality a priority to you? Then you are on the right track with HOMAG!

The production of premium-quality furniture demands premium-quality machines. HOMAG double-end tenoners are powerful, compact and reliable machines for free configuration of tasks of all kinds: Angular or inclined cuts, profiling, rebating, grooving, sanding and corner processing. Their robust construction, low wear technology and high availability make them the ideal choice for the production of doors, fronts and panels. Customers benefit from innovative and convincing products in first class quality.

For more information, go to:

www.homag.com

www.youtube.com/homaggroup





Solid wood processing

Intermittent control with synchronous and opposite movement for tear-free solid wood processing. Clear joint sealing for counter profiles through precise profile trimming.



Robust and low vibration

Highly rigid consoles for precise sizing and profiling processing.



Flexible

Double-sided profiling and sanding up to a minimal panel width of 85 mm.

Highly precise

Rolling block link chain for highest repetitive accuracy and low wear.



Exact

Narrow chain for exact processing of narrow parts in longitudinal processing.

The units – equipped for all tasks

HOMAG hogging and trimming units are experts in removing projecting material and sizing. Whether with panel overhang after a coating plant, crosswise veneer or solid wood – HOMAG units are perfectly suited to your requirements.

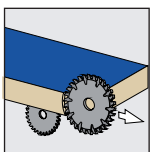
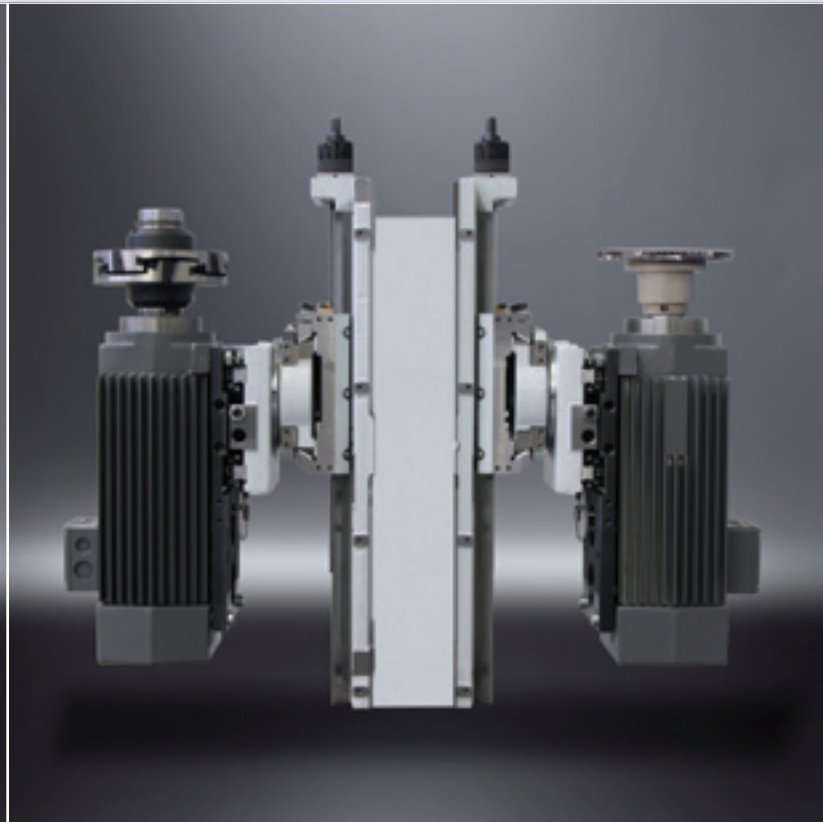

Scoring / hogging

Perfect sizing without tearouts, even for coated and veneered boards. Prescoring unit optionally with lift-off device. Hogging unit with cross support and suction hood.

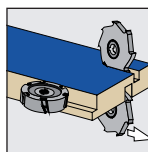

Standard trimming unit SF20

With this unit you are grooving and rebating at the highest level. Optionally also available with intermittent control for tear-free solid wood processing.

Finish belt sanding – always on top form

Whether straight edges, chamfers or radii of solid wood or wood materials: You can trust your HOMAG belt sanding units.

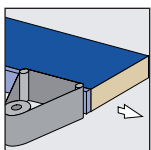
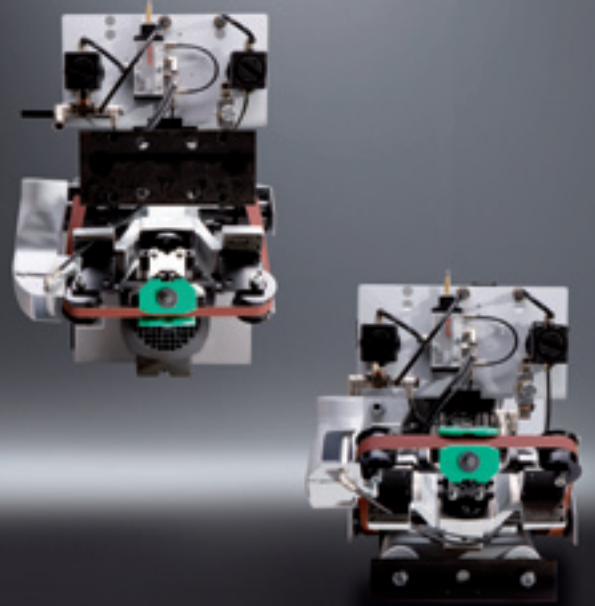
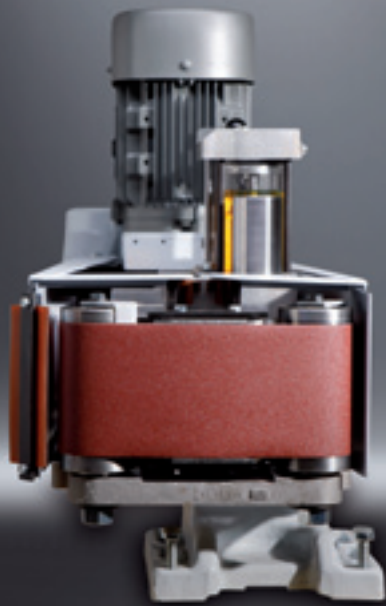

Belt sanding unit KS10

For sanding straight edges of solid wood and MDF boards. In the standard equipment with oscillation.

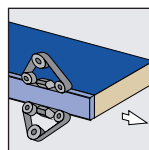

Chamfer/radius sanding unit PS41/PS42

For sanding of chamfers and radii top/bottom on wood-based, veneer and solid wood edges.

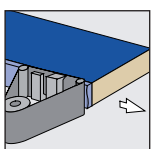

Belt sanding unit PS20

For sanding profiles, rebates and straight edges of solid wood and MDF boards. In the standard equipment with oscillation.

Application examples



Coated wood-based boards

- Removing projecting material of wood-based boards/doors after a coating plant
- Sizing of coated chip boards with controlled prescoring and hogging for optimum angle accuracy
- With the following controlled trimming in synchronous and opposite movement the edge will be jointed without tearouts

Veneered wood-based boards

- Sizing and jointing of veneered chip boards with two hogging units for optimum angle accuracy and glue joint quality

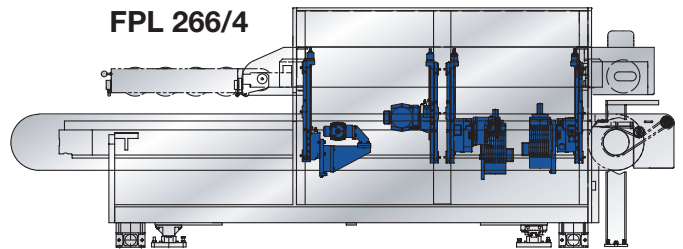

Solid wood panels

- Sizing, profiling and sanding of wood-based material and solid wood boards, e.g. for door fillings

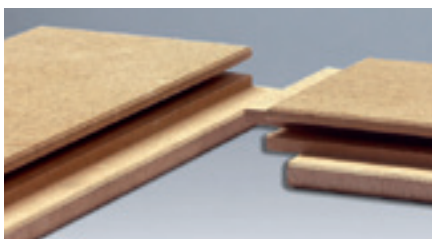
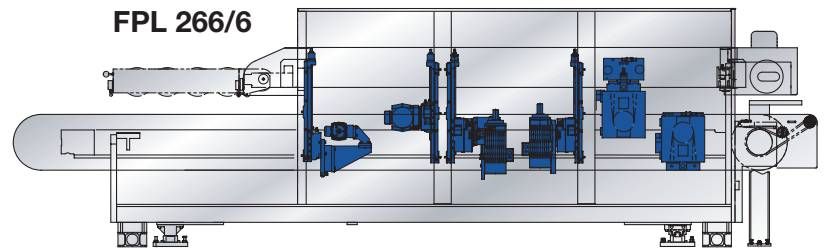

Frame doors solid wood/MDF

- Profiling and sanding of frames with counter profile
 - First throughfeed – profiling of the face side of the frames
 - Second throughfeed – single-sided profiling of the inside of the frames
 - Third/fourth throughfeed – sizing and profiling of the outside of the frame

Insulation materials

- Sizing and profiling of insulation boards from wood soft fiber, glass wool, cement and gypsum

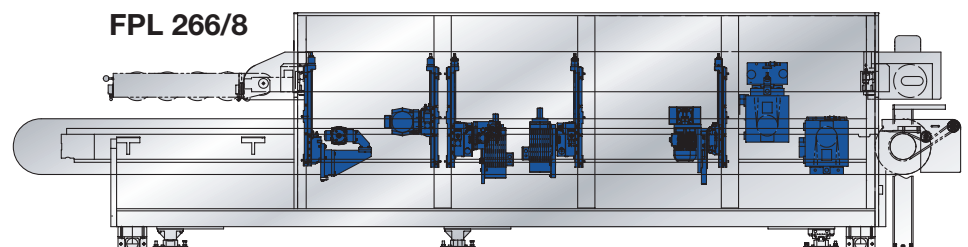

Technical data

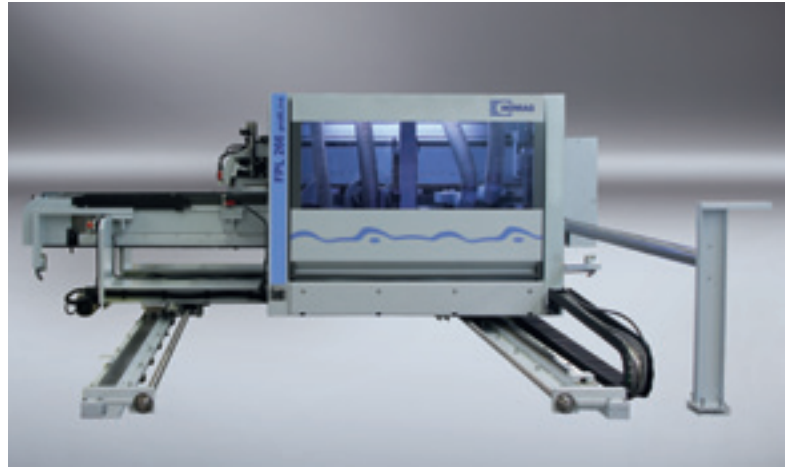

	FPL 265/4 / FPL 266/4	FPL 265/6 / FPL 266/6	FPL 265/8 / FPL 266/8
	Type specific machine dimensions		
Overall length [mm]			
• FPL 265	3 650	4 650	5 650
• FPL 266 single machine	4 650	5 650	6 650
• FPL 266 line execution	4 880	5 880	6 880
Free space for units [mm]	1 900	2 850	3 800
	Further machine dimensions		
Overall width [mm] Hood closed	Working width + 1 880		
Overall width [mm] Hood opened	Working width + 1 360		
Total height [mm] Hood closed	1 685		
Total height [mm] Hood opened	2 130		
	Working dimensions		
Workpiece width min. [mm]	155 (for panel overhang 10 mm)		
Workpiece thickness [mm]	12–60 (optional 110 mm)		
Working height [mm]	950		
Feed [m/min]	15–45		
	Connected loads		
Pneumatic system [bar]	6		

Content, technical data and photos are not binding in every detail.
We reserve the right to make changes.



**Choose the Original
Choose Success!**

For the Success of Original Technology
A VDMA Campaign



Member of the HOMAG Group



HOMAG Holzbearbeitungssysteme GmbH

Homagstrasse 3-5
72296 SCHOPFLOCH
GERMANY

Tel. +49 7443 13-0
Fax +49 7443 13-2300
info@homag.de
www.homag.com