

Cutter unit 1826

HOLZ-HER[®]
Spezialmaschinen

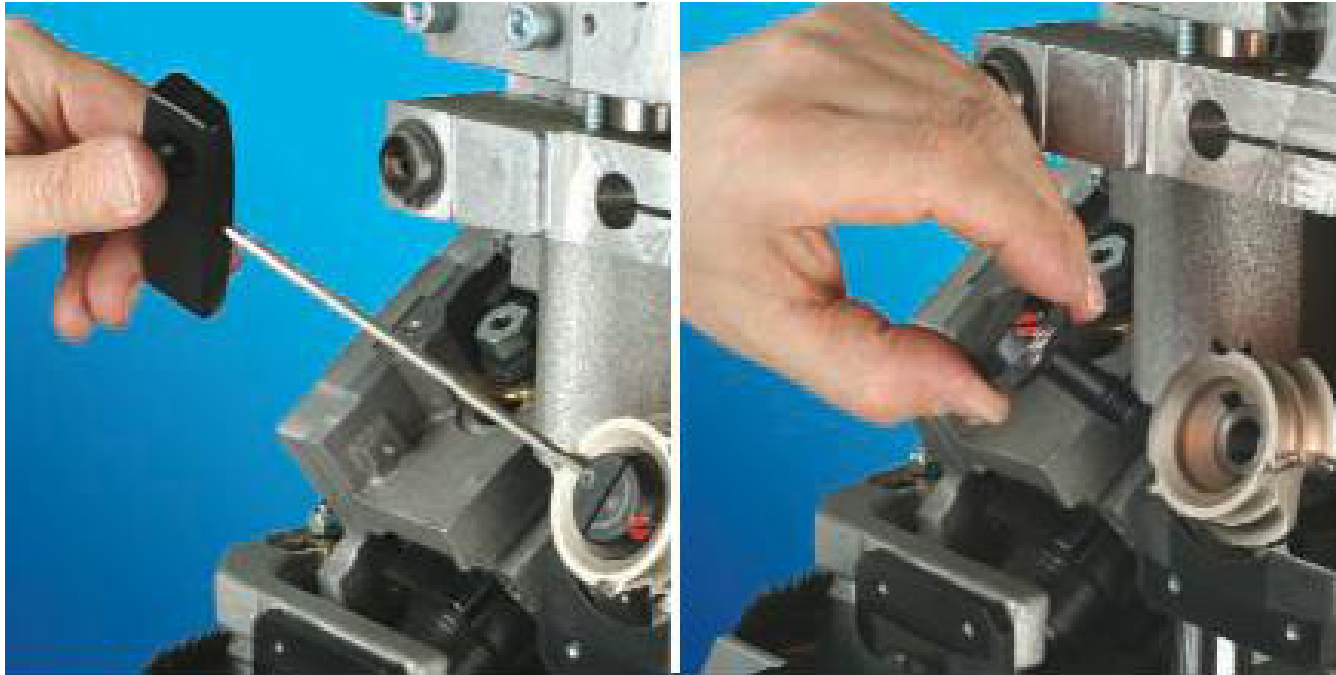

- **PRO-LOCK screw-in spanner for easy and quick tool change**



Flush up to 8 mm edging thickness

HOLZ-HER[®]
Spezialmaschinen

- Special tool available on request (radius/radius, radius/chamfer, chamfer/chamfer)

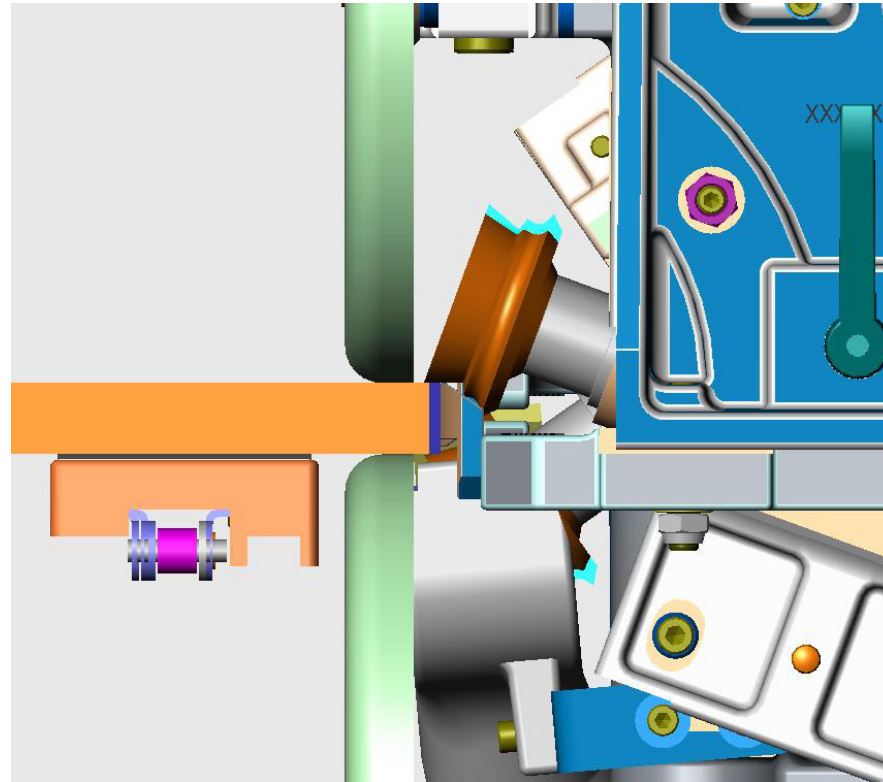

1826 radius R1, R2, R2.5, R3 and R5

HOLZ-HER[®]
Spezialmaschinen

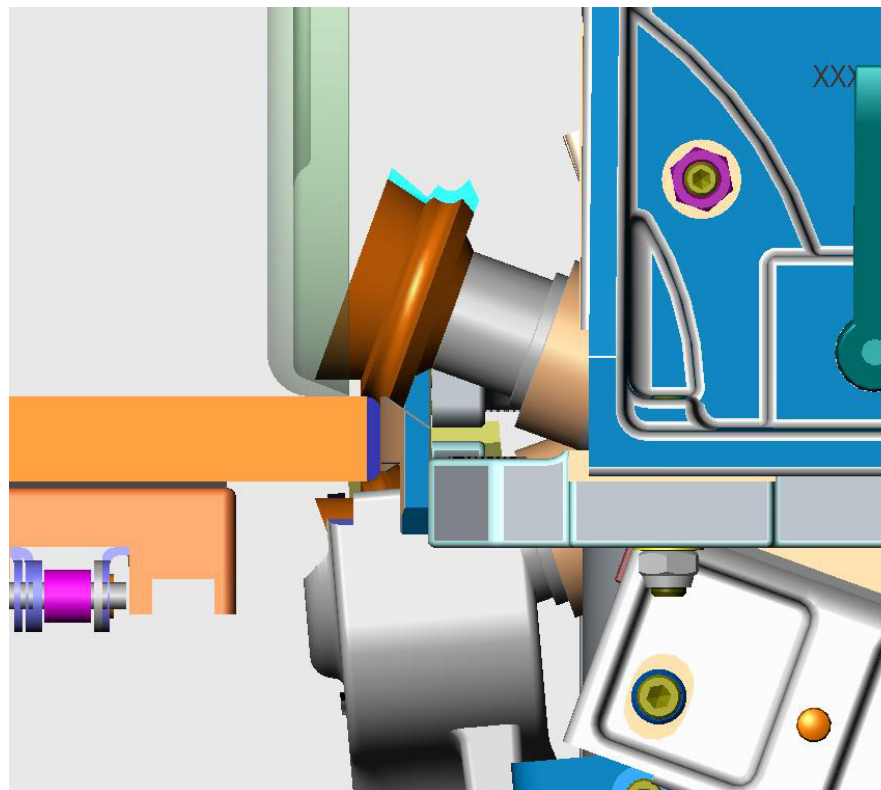

1826 chamfer up to 6 mm edging thickness

HOLZ-HER[®]
Spezialmaschinen

