

Double-end tenoner FL 10 - FL 20

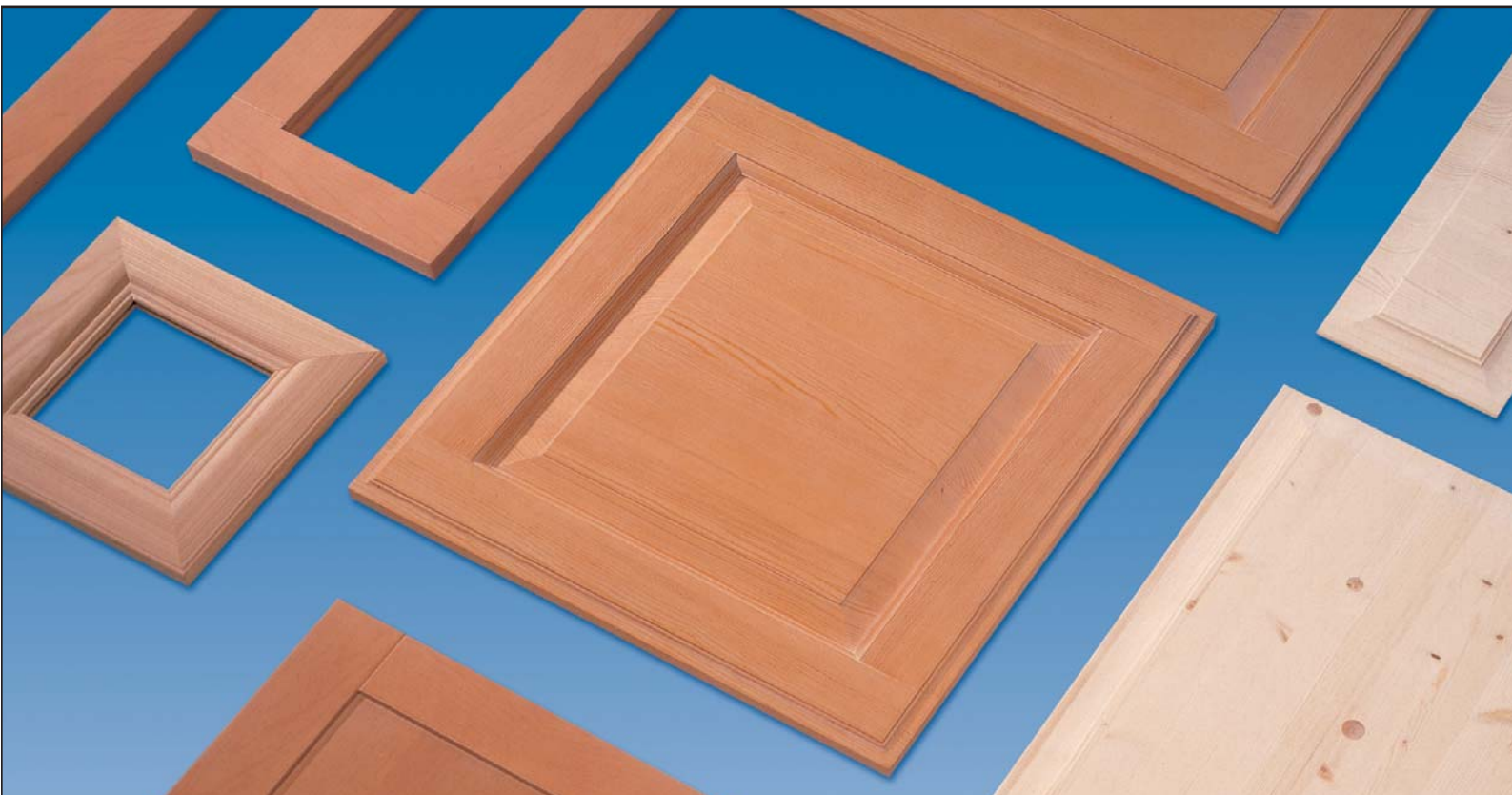

Optimat | profi line | power line



Homag double-end tenoner: "Workhorses" for wide-ranging requirements

Double-end tenoners offer the ideal solution when it comes to the manufacture of furniture, doors, door panels, fronts, frame components, wall and ceiling panelling, flooring elements...

Fitted from an extensive range of modular system units, the compact Homag **double-end tenoner range FL 10 to FL 20** copes reliably with a wide range of processing tasks. And as you would expect from Homag: the mechanical, electrical, electronic and control systems used in these machines are of the very finest modern technology has to offer.



Wide application range

The Homag double-end tenoners can be used to process panel-shaped workpieces – such as directly coated boards, MDF, coreboard, solid wood, plywood, plastic, hard foam, cork, postforming or cement-bonded fibreboard – in a wide variety of different ways:

- Parallel cuts
- Angular cuts
- Bevelled cuts
- Sizing
- Profiling
- Rebating
- Grooving
- Corner and contour processing





High-speed production

A wide range of transverse and longitudinal work steps can be completed in just two passes. Automating your production by series connection of the two passes makes for an even greater increase in productivity – through to the high-performance line with continuous material flow, including feeding and stacking. In extreme cases, the control system and unit technology even permit high-speed resetting in throughfeed – which means high-volume output even for minimal or frequently changing batch sizes.

Secure investment

With many thousands of sizing and edge banding machines to its name, Homag has become the most important manufacturer of machines for the panel furniture industry today. Our experience and know-how offer the assurance of absolute reliability – for you and your production.

Profit with parquet

Your double-end tenoner can be fitted with a magazine for parquet blocks, and – for even greater output – with a transport chain featuring short dog spacing. These additions can open up scope for you to enter a new and lucrative business field.

Durable, precise, efficient – with extreme convenience built in

Homag double-end tenoners have everything going for them:

- Unbeatable feed rates
- Maximum productivity
- Extreme precision
- Outstanding repeat accuracy
- Long service life
- High availability
- Durable, low-wear, low-maintenance engineering

Impressive results

The precise Homag workpiece transport system guarantees minimal tolerances for sequentially linked work processes.

The infinitely variable feed system can be adjusted precisely to tool and material requirements. And the cardan drive systems used for width and height adjustment as well as the easy-running linear guidance systems take care of maximum repeat accuracy when resetting measurements.

Simple operation

All resetting operations can be performed quickly and without major exertion of force (linear guides). The position can be precisely read at the digital counters. The machines are easily accessible and extremely low-maintenance.



Unique: Shaped components in throughfeed

A revolutionary Homag development: With special units controlled by means of digital servo axes, attractively shaped curved parts can be produced from rectangular workpieces in throughfeed.

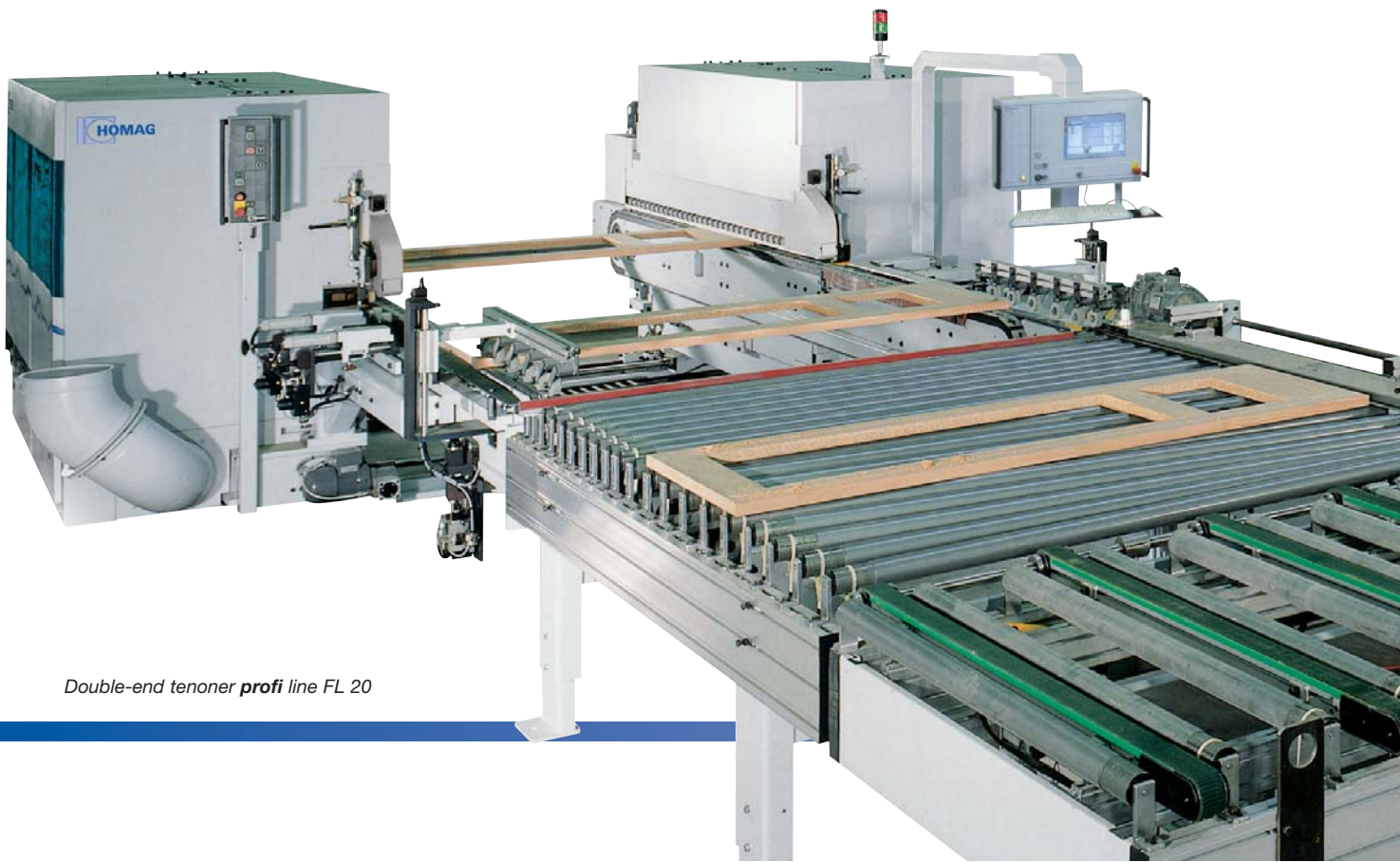
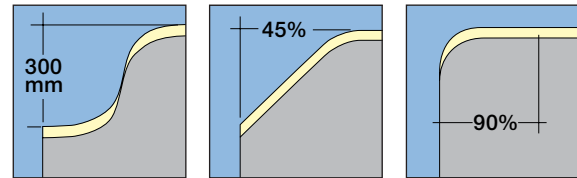

Double-end tenoner **profi** line FL 20



Flexible longitudinal and transverse processing

When workpieces have already been sized to the unfinished fixed or finished dimension, they are automatically fed at high speed in any optional sequence for multiple-side processing.

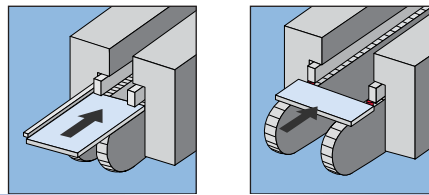

1) Longitudinal processing

The workpieces are inserted at the infeed fence and cut precisely to size.

2) Transverse processing

Here, the workpieces rest against the dogs of the transport chain. The stop dogs are steplessly adjustable and capable of transporting even profiled or softforming parts gently and securely through the machine.

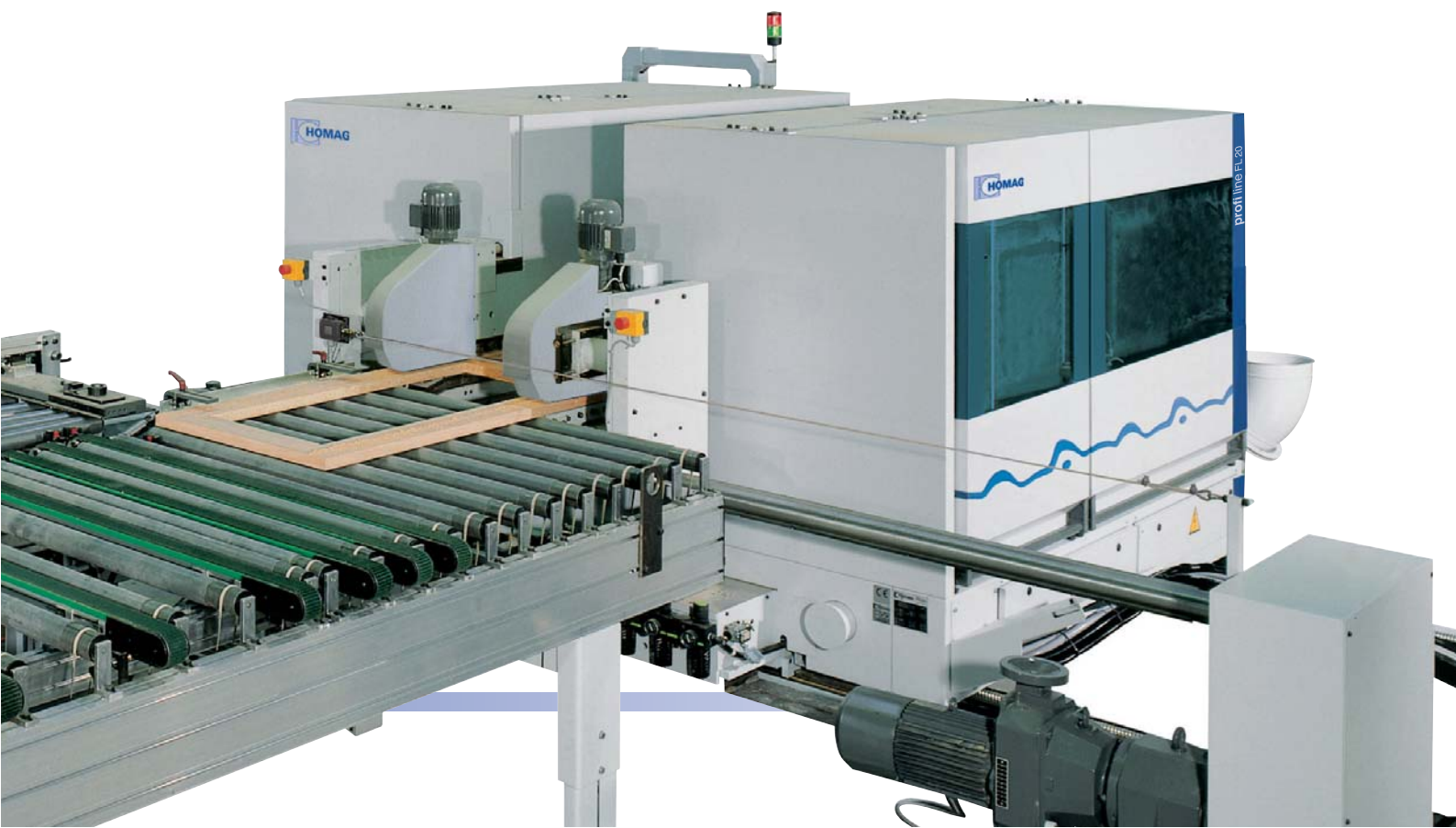

The modular processing units – always up to date

We offer a comprehensive range of units for widely different processing operations. The range of modular processing units is being upgraded and extended all the time. We recommend getting in touch with us for details.

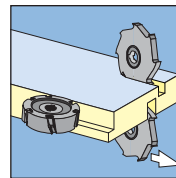
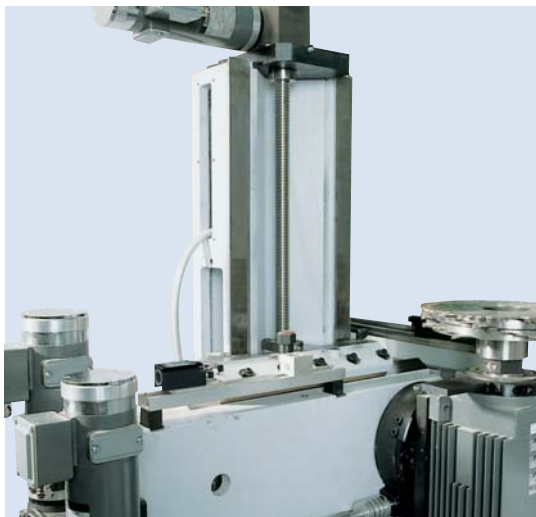

Standard trimming unit

For finish trimming, rebating, profiling, grooving etc. Electropneumatic control facility, swivel range 90 degrees, cross support and reversing switch for tool direction. Option: automation capability, for example by stepless horizontal, vertical or swivel axes.

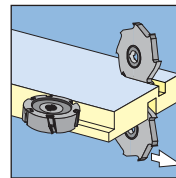

SF 62 trimming unit with automatic 8-slot tool changer

Tool clamping operations are solved by the control system. With a maximum diameter of 200 mm and two profiles per exchange slot, tools are automatically exchanged using the 8-slot plate changer. This allows 16 different profiles to be exchanged. The processing motors of the tool changers are fitted with HSK 63 F interfaces. All motor and changer movements are controlled by servo axes.

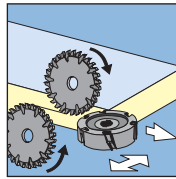
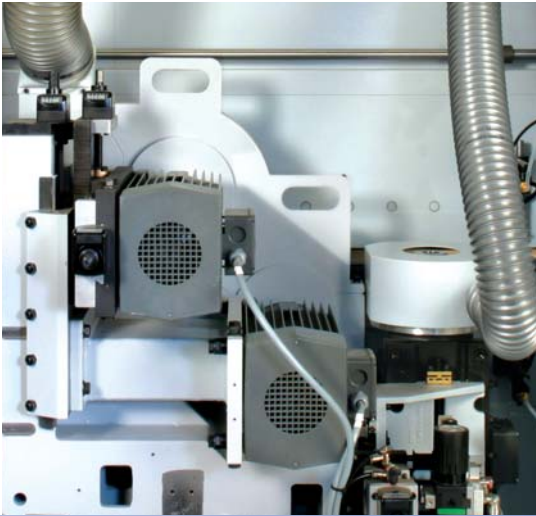

Double hogging unit

System for splinter-free processing of veneered and plastic-coated panels. This modern, efficient double hogging system guarantees top quality and long service life coupled with even tool wear.

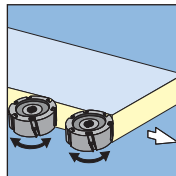

Exchange trimming unit

Unit for finish trimming plastic-coated panels. The first motor cuts in counter-rotation before lifting off from the workpiece. The second motor then operates in synchronous rotation, guaranteeing splinter-free processing. The unit is also used for transverse profiling of solid wood panels.

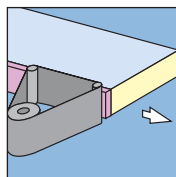

Belt sanding unit KS 10

For sanding straight veneer and solid edges.

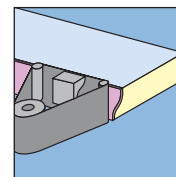

Profile sanding unit PS 10/PS 20

For sanding profiles and straight edges. PS 20 using dual sanding pad technology.

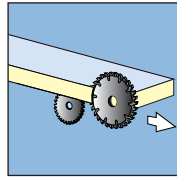
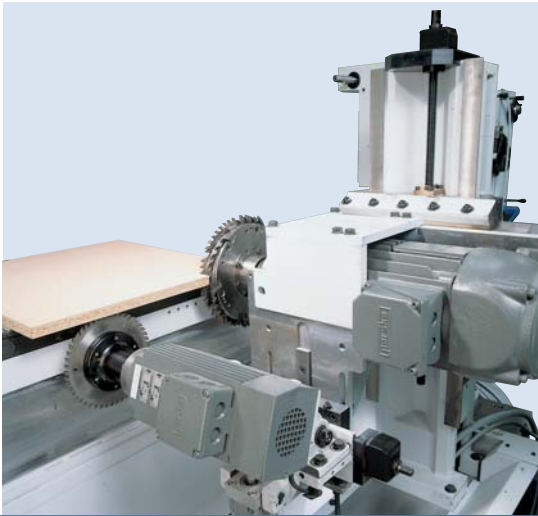

Scoring/hogging

Perfect sizing without splinters – even when working with coated substrate panels. Pre-scoring unit with lift-off device. Hogging unit with 15 degree swivel action featuring cross support and extractor hood.

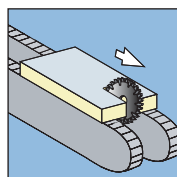
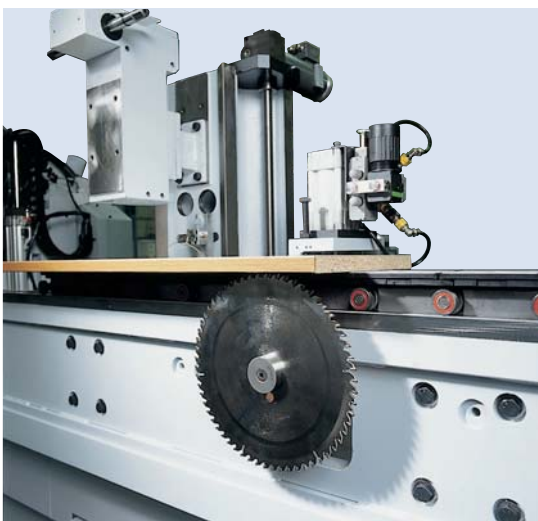

Central cutting device

Device for dividing and grooving workpieces between the chain tracks. The central flange is guided through a recess in the chain track and connected to a standard motor.

The control system: user-friendly, fast, reliable

Guarantee of high productivity

Almost all resetting operations can be executed conveniently from the control desk. Resetting times are no longer an issue and even minimal batch sizes can be produced with maximum economy.

Operation: simple and reliable

Programming and operation of an edge banding machine is now "child's play". The new, convenient control system with flat colour screen and dust-proof PC keyboard makes life easier for every machine operator.

The system is based on the widespread Windows standard familiar around the world through everyday use of the PC. Using a simple, self-explanatory user prompting system, familiar procedures and thought processes can be implemented directly when processing a workpiece. Supplementary transport systems can be integrated without problems into the existing control system.

Remote diagnosis prevents machine standstill

By responding quickly to direct error messages on screen (e.g. "protective cover open"), it is possible to eliminate standstill times. And if you are unable to solve a problem yourself, Homag remote diagnosis will often save you the expense of a service call-out.

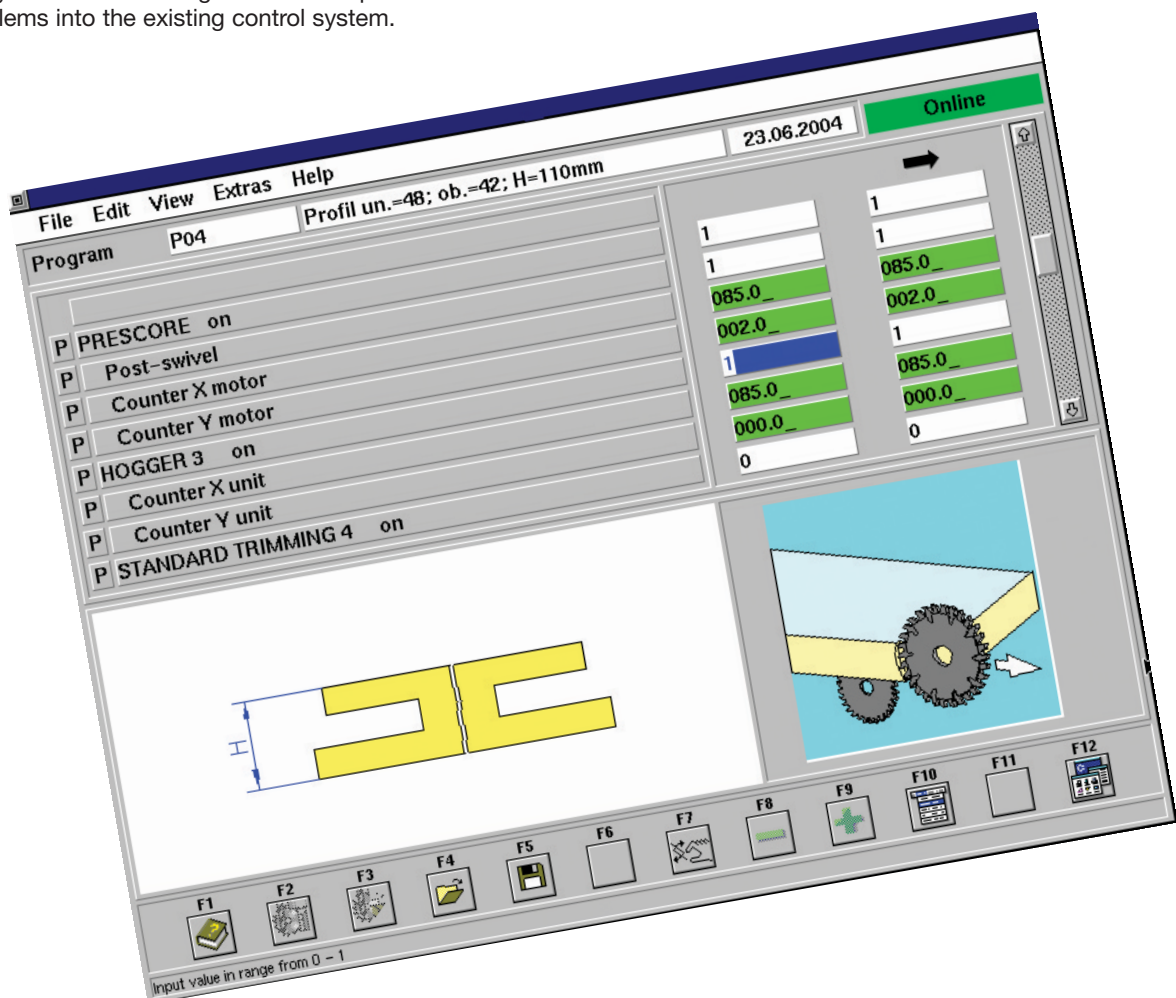

Perfect as a stand-alone machine – unbeatable in a production line

Our double-end tenoners are designed for simple extension into a production or high-performance production line. We offer the ideal, perfectly coordinated integral solution to meet your specific needs – which is your guarantee of maximum economy and optimum results.

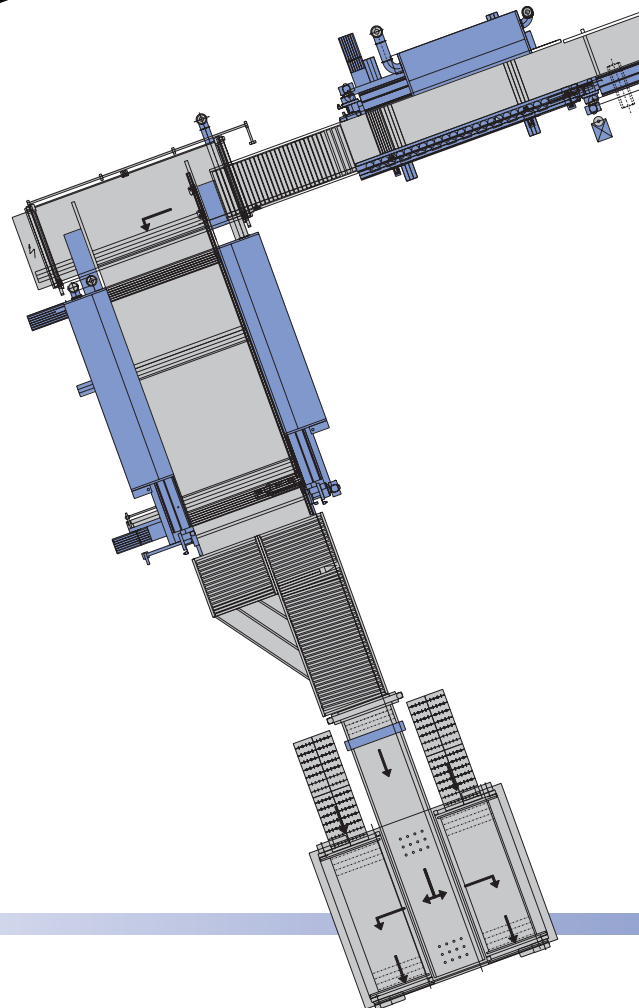
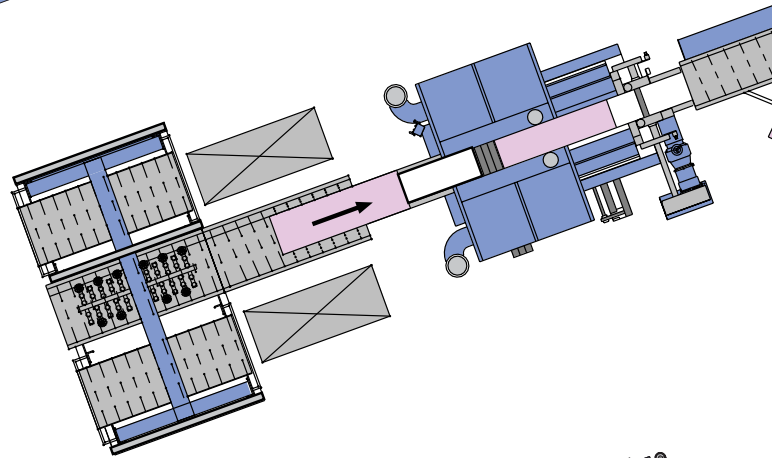
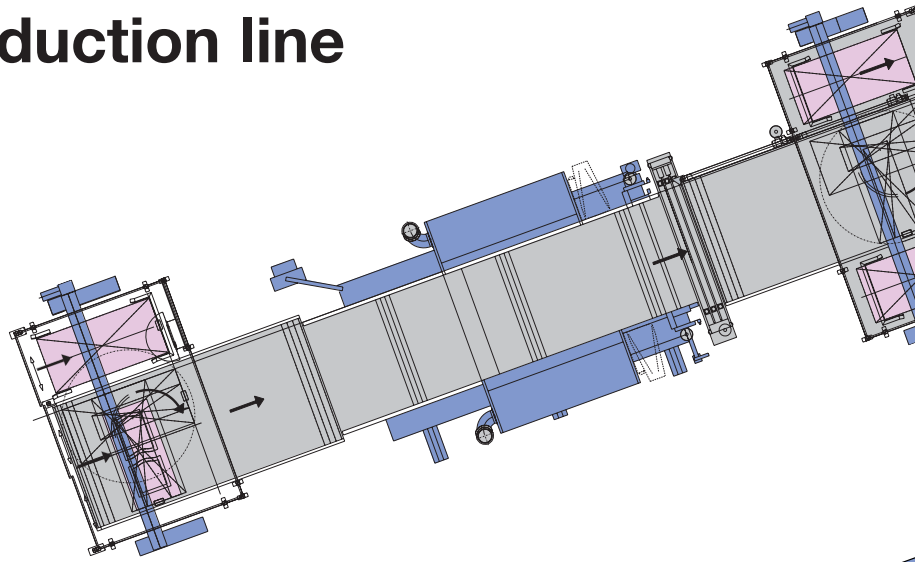

Pooled expertise, concentrated know-how

The Homag project team will take charge of complete project processing for your plant. The close ties which exist between the Homag Group members guarantee access to the pooled expertise of the entire Group. Which permits trouble-free interlinking of all individual components (also of other makes) or their integration into higher-level systems. An impressive portfolio of completed highly efficient production lines for complete processing testifies to the outstanding competence of our project team.

One for all

You purchase practically the entire plant from a single manufacturer. We take responsibility for everything: From formulation of the terms of reference through concept-finding, quotation, installation and commissioning to the regulation of commercial, legal and technical details.

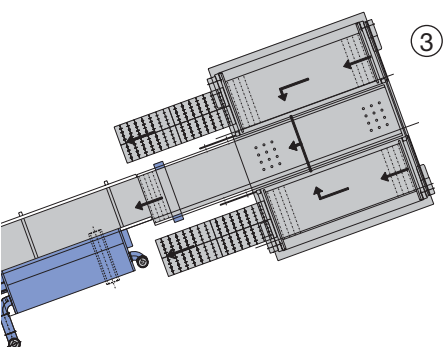
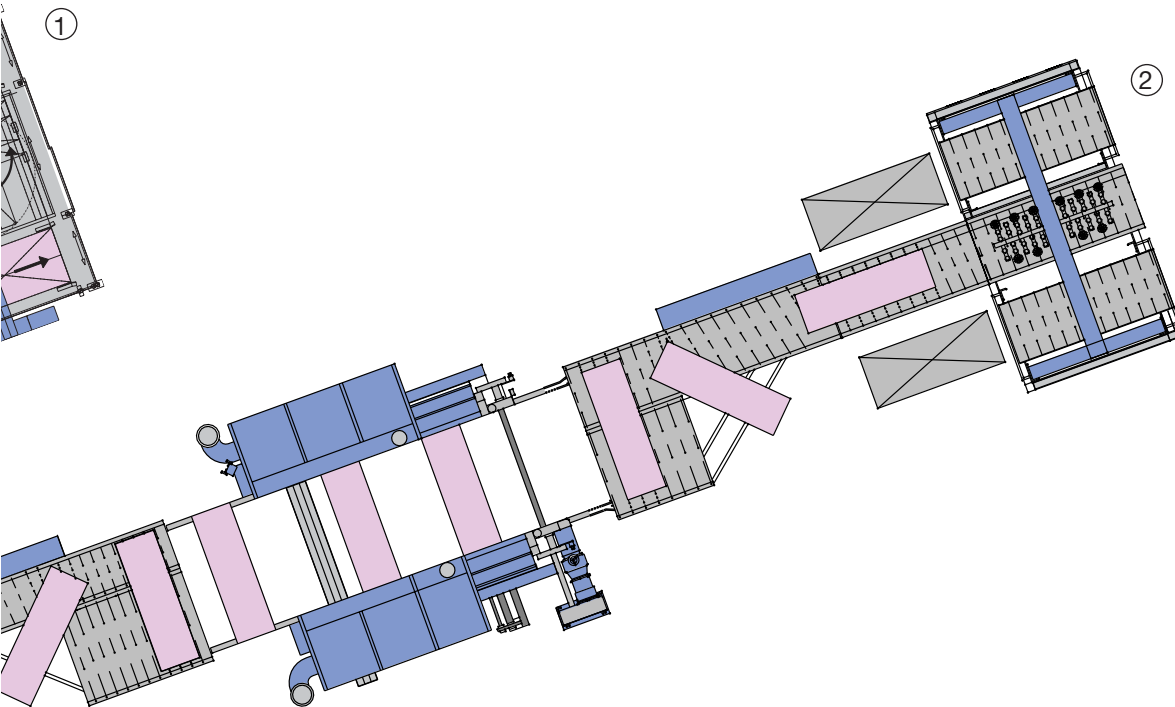

1) Free-standing machine with automatic feeding station and minimal space requirement. Longitudinal and transverse processing in two passes. The rotary station is integrated in the feeding and stacking equipment.

2) Complete production line for longitudinal and transverse processing with automatic feeding, longitudinal processing, longitudinal/transverse rotary station, transverse processing, transverse/longitudinal rotary station and stacking station.

3) Complete production line for the manufacture of narrow parts through to big-sized formats. Automatic stacking, longitudinal processing in the tandem version, angular transfer using an intermediate magazine, transverse processing, transverse/longitudinal rotary station, stacking.

The Homag service program: The all-round convenience package for your machine

Because our versatile range of services has been tailored consistently to the needs of our customers, it guarantees optimum all-round support – from the project planning phase through sales to after-sales.

Planning/advice: working together towards the perfect solution

To provide you with the best and most economical solution to your requirements, we offer a sound and competent advisory service – right from the earliest planning phase of your project.

Financing/leasing: a straightforward solution at favourable rates

We also offer attractive financing arrangements to help keep your equity base intact. Benefit from our range of flexible financing offers.

Installation/commissioning: getting things moving

Our highly skilled and experienced specialists will be in charge of installation and commissioning – making sure that your production gets underway quickly without any hitches.

Practically-oriented training: Fast track to full productivity

We will prepare your staff for safe, efficient machine operation with a choice of selective training events on wide-ranging topics.

Production support/optimization: Long-term efficiency

We will provide sound on-site support and ensure that you fulfil the maximum possible potential of your machine – and so achieve continuous high productivity.

Maintenance/inspections: for maximum availability

Only machines which are producing will return a profit. By performing regular preventive inspections we can help effectively prevent machine standstill.

Modifications/overhauls: the economic alternative

We will adapt your existing machine quickly and cheaply in line with new or changed requirements – to enhance the value and output of your plant and help you make considerable savings.



Remote diagnosis/video diagnosis help reduce costly call-outs

This diagnostic facility helps cut down costs spent for on-site callouts, and offers scope for selective deployment planning and spare part supplies – so providing effective support for your own staff.

Spare part processing: fast and reliable

Many of the components used in our machines are identical. This not only simplifies the stocking of spare parts and ensures fast part availability, but also simplifies operation and maintenance and reduces costs.

World-wide service: Homag is everywhere

The global Homag Service Network guarantees customer proximity and worldwide availability of our services.



lifeline | service

Our **lifeline** | service ensures economical production over the entire life cycle of your machine. If you need us, you can rely on us to be there: From plant planning and installation through to employee training, in-process support and high-speed supply of spare parts – around the world, when and where you need us.

Specifications

Machine dimensions

Overall length	mm depending on machine type	
Working height	mm	950 (37,401")
Noise protection covers		
Overall width closed/open	mm	2300/3830 (90,551"/150,787")
plus the relevant working width		
Overall height closed/open	mm	1840/2480 (72,441"/97,638")

Connected loads

Operating voltage	400 V/50 Hz	
Control voltage	220 V or 24 V	
Total extraction capacity	m ³ /h	depending on equipment
Air speed (dust extraction)	m/sec.	28 (91,863 ft.p.sec.)
Pressure loss	mm/w.g.	250 (9,842 in./w.g.)
Supply line female thread	depending on equipment	
Compressed air connection	bar	6 to 8
Compressed air consumption	SL/min.	depending on equipment

Working dimensions

Workpiece width		
min. double sided	mm	220 (8,661")
max. doppelseitig	mm	1000 to 4000 (39,37"-157,48")
(graduations)	mm	500 (19,685")
Workpiece thickness	mm	min. 8 (0,315") - max. 90 (3,543")
Workpiece overhang	mm	min. 20 (0,787") - max. 100 (3,973")
(special dimensions)	mm bis	300 (11,811")

Miscellaneous

Feed	m/min.	10 to 40
		(32,808-131,233 ft.p.min.)
Width adjustment speed		
standard	m/min.	2,6 (8,530 ft.p.min.)
Machines with servo axis	m/min.	20 (65,617 ft.p.min.)
Dog spacing (standard)	mm	1000 (39,370")
Dog height/standard	mm	11 (0,433")
Option stepless dog height	mm	up to 25 (0,984")

Certain details of the provided specifications and photos may deviate from the supplied product. We reserve the right to make changes in the interest of progress.

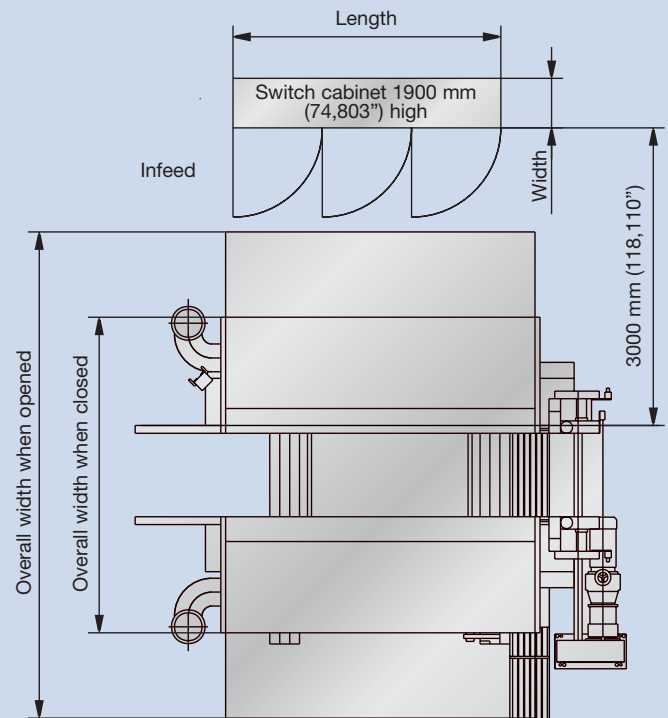
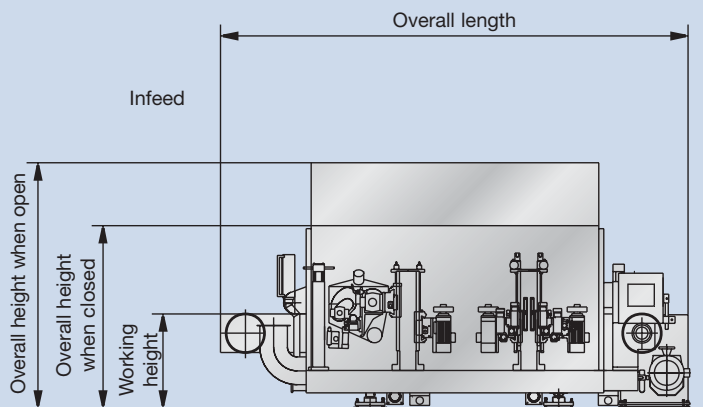



A member of the Homag Group



Homag Holzbearbeitungssysteme AG

Homagstraße 3-5
72296 SCHOPFLOCH
GERMANY

Tel.: +49 7443 13-0
Fax: +49 7443 132300
E-Mail: info@homag.de
Internet: www.homag.com

