



BIMA 810 / 810 V

Bearbeitungszentrum / machining centre

CNC-Komplettbearbeitung

Flexibel und rationell

Complete CNC processing

Flexible and efficient

NEU · NEW



CNC-Bearbeitungszentrum BIMA 810/810 V

CNC machining centre BIMA 810/810 V

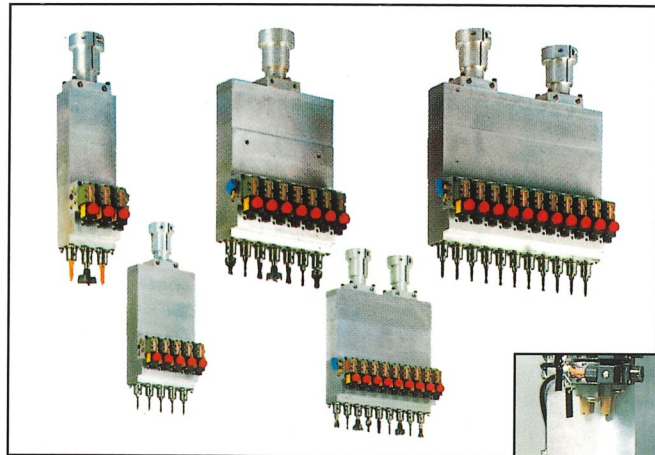

Vertikal-Bohrgetriebe
Vertical boring units

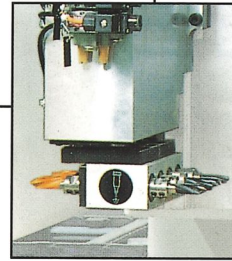

Horizontal-Bohrgetriebe
Horizontal boring units

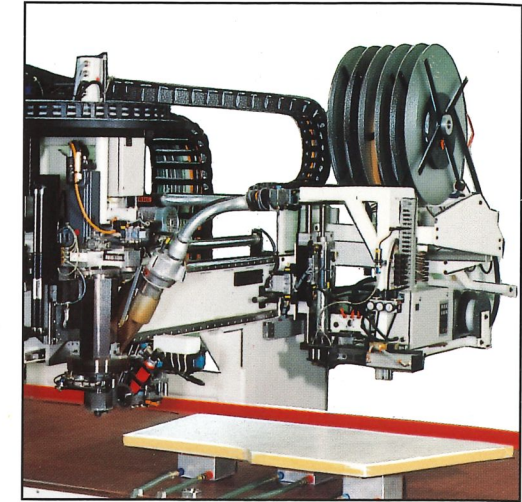

Kantenanleimaggregat 360°
360° edge banding unit

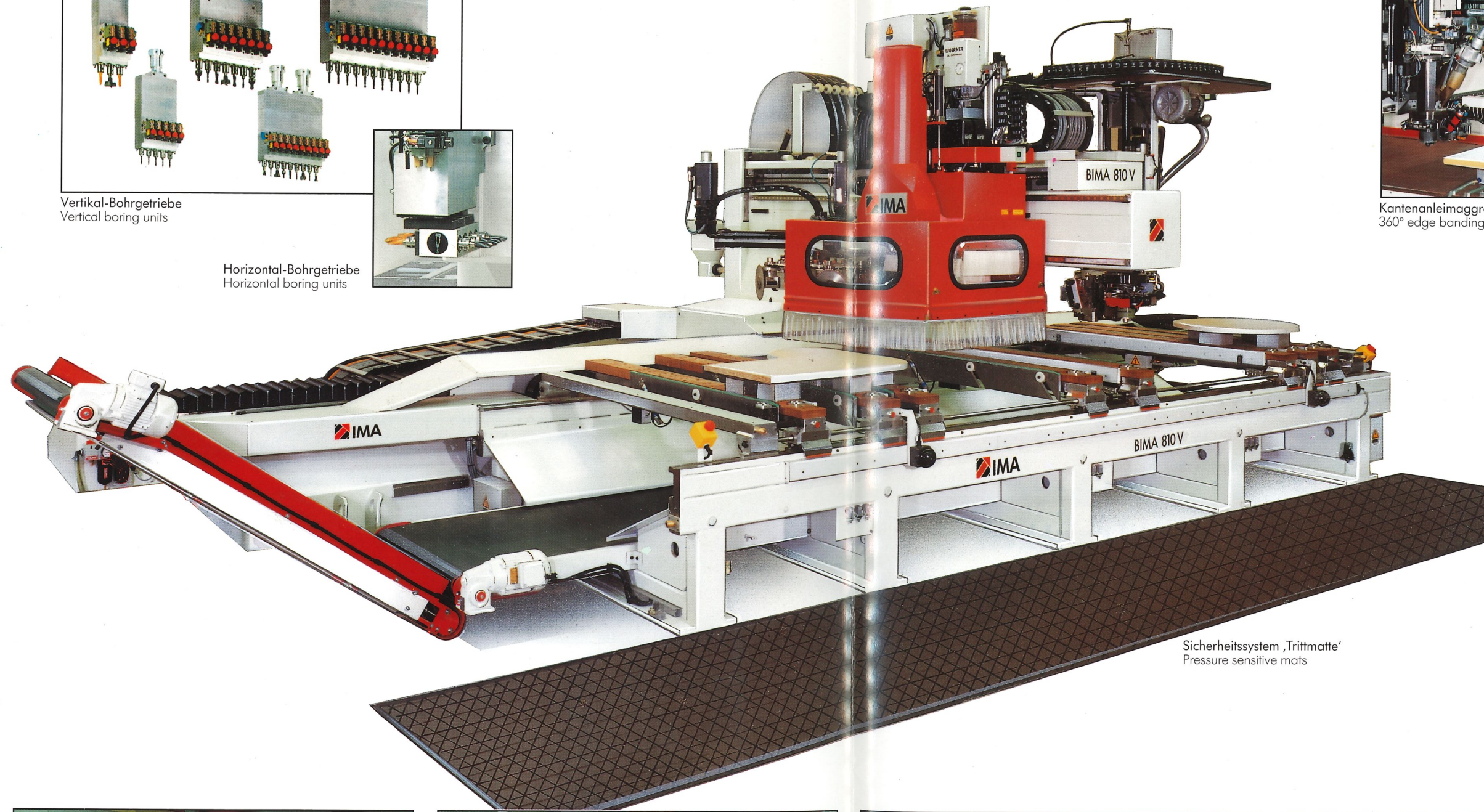

Sicherheitssystem 'Tritmatte'
Pressure sensitive mats

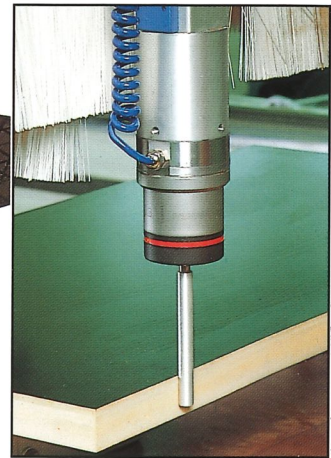

Elektronischer Meßtaster
Touch-trigger probe

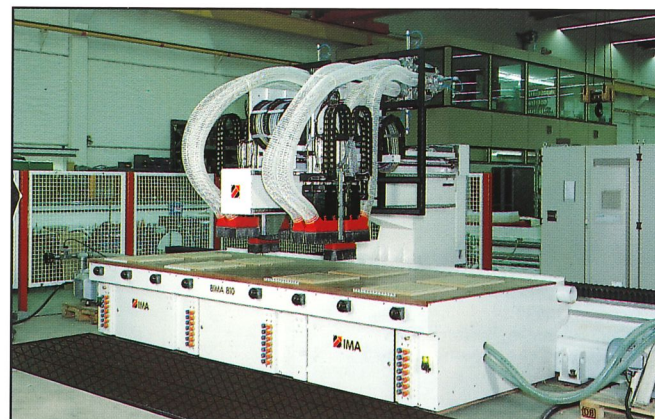

BIMA 810 mit Tischplatte und Mehrfach-Belegung
BIMA 810 with worktable and multi-panel loading



Standard-Tisch mit Option LED-Rüsthilfe
Standard worktable with LED aided setting (optional extra)

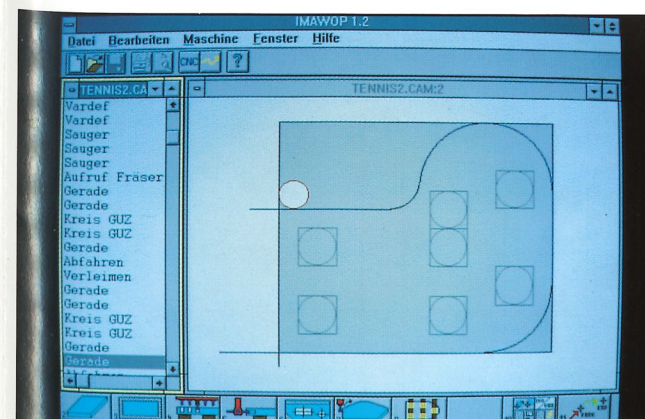

IMAWOP / Darstellung mit Saugerpositionierung
IMAWOP / graphic representation with vacuum block positioning



BIMA 810 V mit fahrbarem Bedienpult
BIMA 810 V with mobile control panel

Ausführungsvarianten

Variable designs

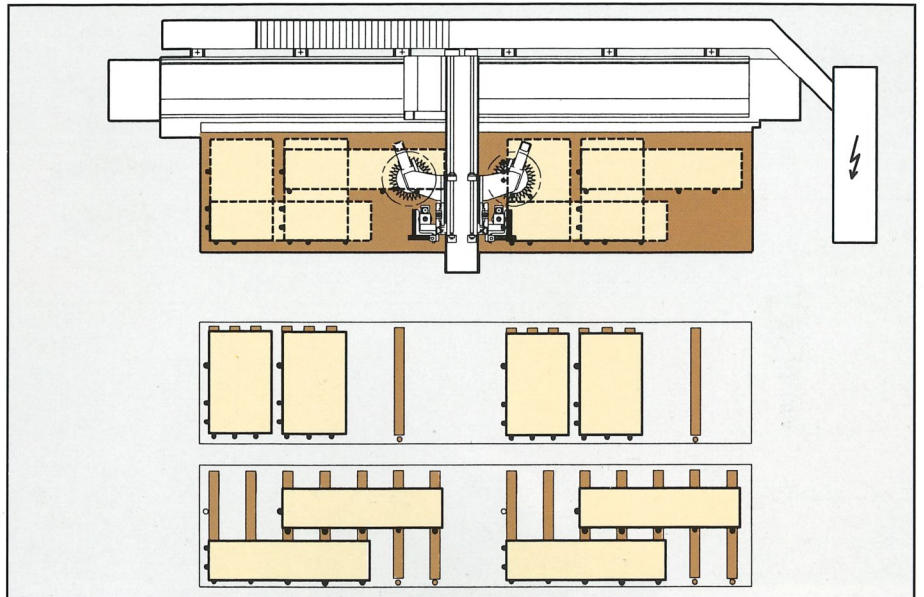

BIMA 810 –
Belegung im Parallelbetrieb
BIMA 810 –
Panel loading in parallel mode

Automation

Automation



BIMA 810 V
mit NC-Rüsttisch
BIMA 810 V
with NC setting worktable



BIMA 810 V
im Durchlaufbetrieb
BIMA 810 V
in through-feed mode

Werkzeuge und Aggregate / Tooling and units

Werkzeuge mit Spann- zangenfutter HSK F 63 Tools with HSK F 63 chuck



Schafffräser
Shank type cutter



Formfräser
Form cutter



Schleifkörper
Sanding stone

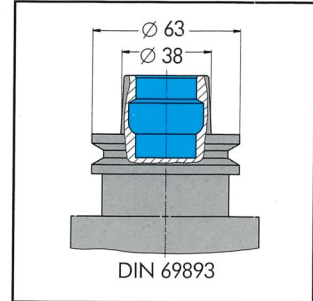

Hohlschaftkegel HSK F63
Hollow shaft cone HSK F63

DIN 69893

Adapter-Aggregate Adaptor units



360° NC

Alle Aggregate 360° drehbar
All units rotatable through 360°

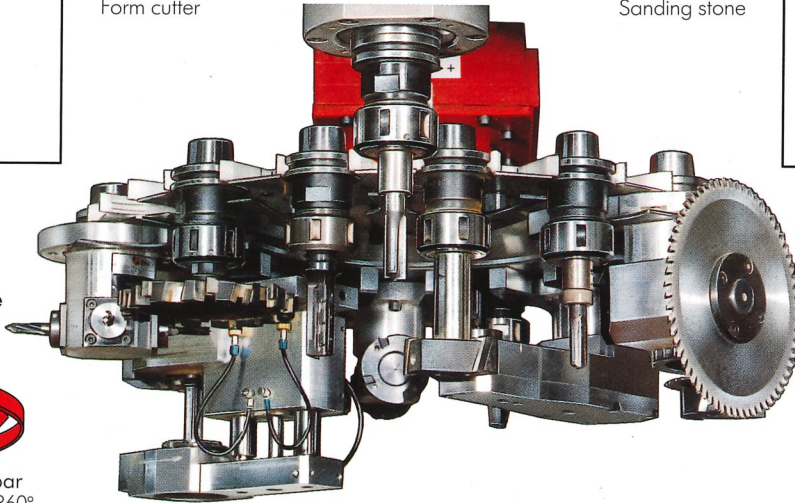

Universal Werkzeuge-
u. Aggregate-Wechsler
(18 Plätze)
Universal tool and unit
changer (18 positions)

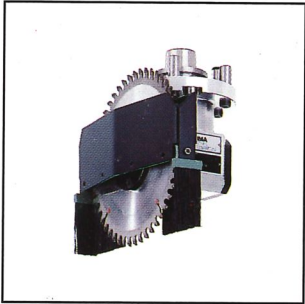

Säge, 90°
Saw, 90°



Säge, 0°-100°
Saw, 0°-100°



Horizontalbohr/-fräskopf
Horizontal drill/cutter



Horizontalbohrer, 7°
Horizontal drill, 7°



Horizontalbohrer, 0°-100°
Horizontal drill, 0°-100°

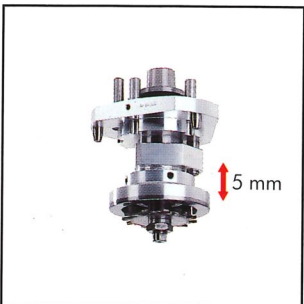

Horizontalnutsche (Tastring)
Horizontal grooving saw
(tracer wheel)



Horizontalnutsche (Tastkufe)
Horizontal grooving saw
(tracer shoe)

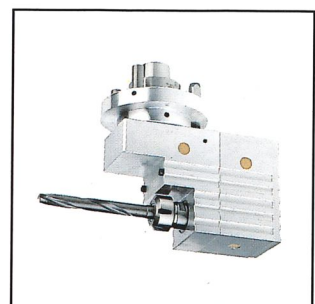

Horizontalfräser
Horizontal cutter

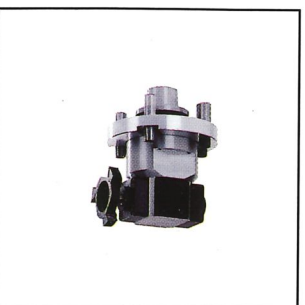

Eckenfräser
Corner router



Unterfräser
Bottom router

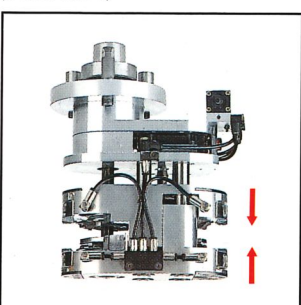

Bündigfräser und Ziehklinge
Flush milling unit and scraper

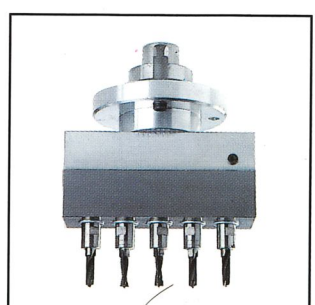

Universal-Bohrertriebe
Universal boring unit

Technische Daten / Technical data

BIMA 810 (BIMA 810 V)

Standardausstattung / Standard equipment

Bearbeitungsbereich / Processing range

X-Achse / X axis 4700 (4200) mm*
 Y-Achse / Y axis 1400 bzw./or 1600 mm

Wechselfeldbearbeitung /

Alternate working field area 2 x 1600 (2 x 1350) mm

Eilganggeschwindigkeiten / Rapid traverse speed

X-Achse / X axis 60 m/min.
 Y-Achse / Y axis 50 m/min.
 Z-Achse / Z axis 20 m/min.
 Beschleunigung / exeleration 2 m/s²

Vorschubgeschwindigkeit / Feed speed

(Bahnbetrieb /
 contouring operation) max. 48 m/min.

Hauptantrieb / Main drive (AC-Motor)

Leistung / power output 8,5 kW
 Drehzahl, programmierbar / 1500-18000 min⁻¹/
 programmable rotational speed r.p.m.

Autom. Werkzeugwechselmagazin / Automatic tool changer magazine

Anzahl Magazinplätze /
 number of magazine positions 18

Absaugung / Extraction

Absauggeschwindigkeit / extraction speed 28 m/s
 Absaugvolumen / extraction volume 4950 m³/h

Elektrik / Electric

Betriebsspannung / operation voltage ... 3 x 400 V, 50 Hz
 Anschlußwert / connected value ... ca. (approx.) 45 KVA

Druckluft / Compressed air

min. Druck / min. pressure 6 bar
 Verbrauch / consumption ca. (approx.) 200 NL/min.

Maschinengewicht / Machine weight

ca. / approx. 13900 kg

* Erweiterung in 1000 mm-Abständen /
 Extension in 1000 mm steps.

Technische Änderungen vorbehalten / All rights for technical modification withheld.

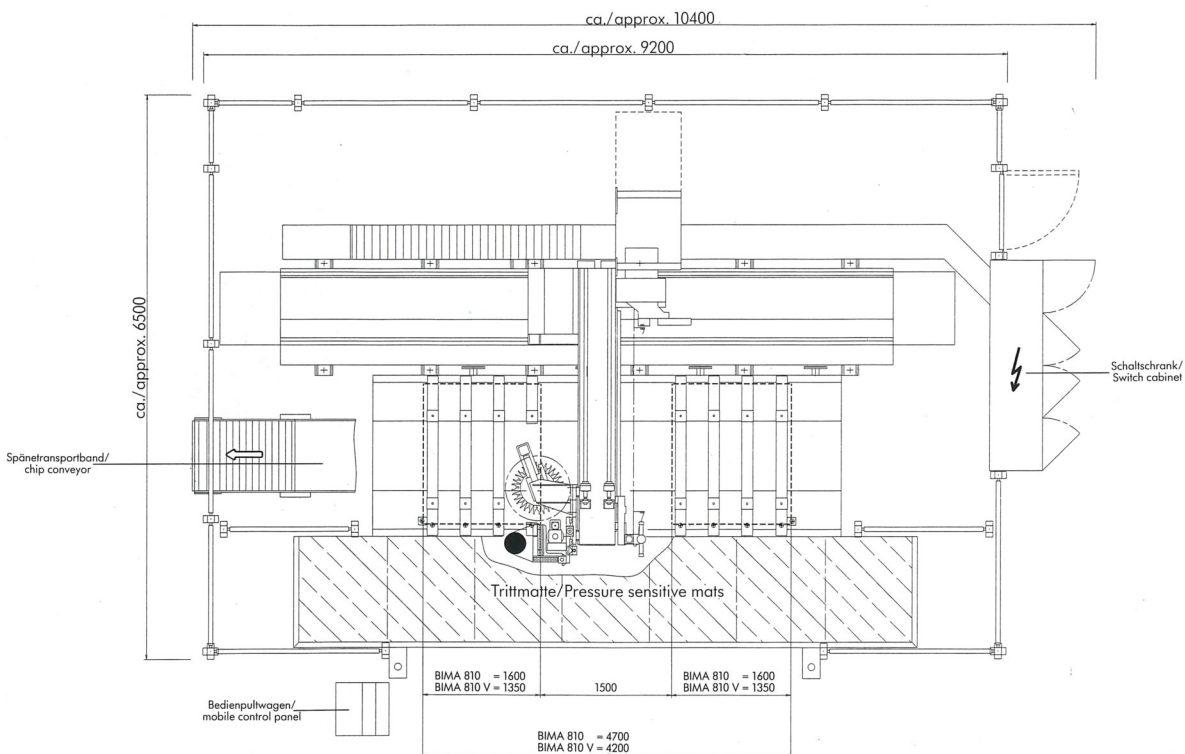

IMA Maschinenfabriken
 Klessmann GmbH
 D-32292 Lübbecke, Postfach 1246
 D-32312 Lübbecke, Industriestraße 3
 Telefon 05741/331-0
 Telefax 05741/4201