

CONCEPT *plus*



BIMA P 480 *Concept plus*

the new dimension for routing and edge banding



www.hoechsmann.com



Edge banding machine

Working area

X 1	2 x 2,100 (incl. edge banding)
X 2	2 x 2,400 (routing and drilling only)
Y	1,400 1,800

BIMA P 480 [Routing and drilling only]

Max. panel size [depending on the machine type]

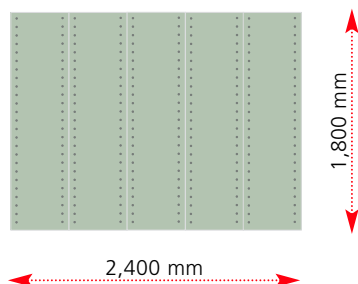

BIMA P 480 V [Edge banding]

Max. panel size [depending on the machine type]

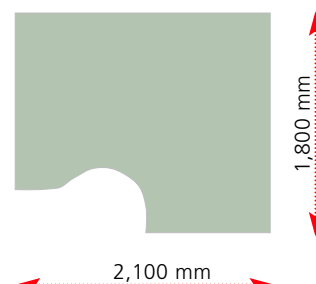

Routing and drilling machine



Edge banding machine

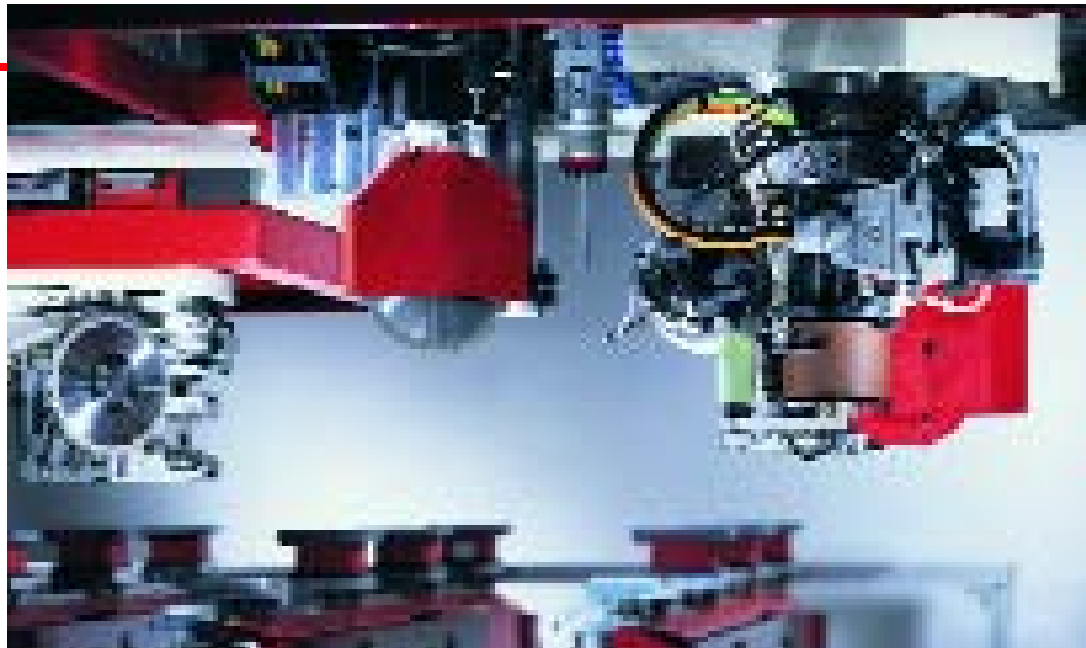

BIMA P 480 **Concept plus**

BIMA P 480 **Concept plus** – processing centre, the powerful alternative for more productivity. The new gantry machine, BIMA P 480 **Concept plus** with a tandem worktable, combines all features of a modern future-oriented stationary CNC processing machine for routing and edge banding.

- ❖ Proven IMA reliability
- ❖ High accuracy and stability
- ❖ Optimum performance and durability



MAIN SPINDLE

- 7.5 kW or 12 kW/24,000 min⁻¹

TOOL CHANGER

- for 8 tools

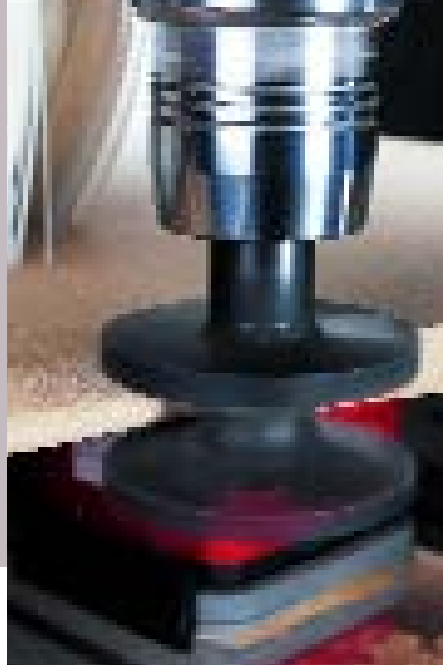

Main spindle with router



Tool changer

Routing and drilling machine

BIMA P 480

❖ ROUTING

❖ DRILLING

For synchronous machining of up to 3 panels.



DRILLING UNIT, L-SHAPED

- 14 or 21 drill spindles with 2 open spaces for additional units



MAIN SPINDLE

- 7.5 kW or 12 kW/24,000 min⁻¹



2nd MAIN SPINDLE

- with 8-station tool changer for synchronous processing of 2 panels

2nd DRILLING UNIT

- 14 or 21 spindles



3rd MAIN SPINDLE

- with 8-station tool changer for synchronous processing of 3 panels

3rd DRILLING UNIT

- 14 or 21 spindles

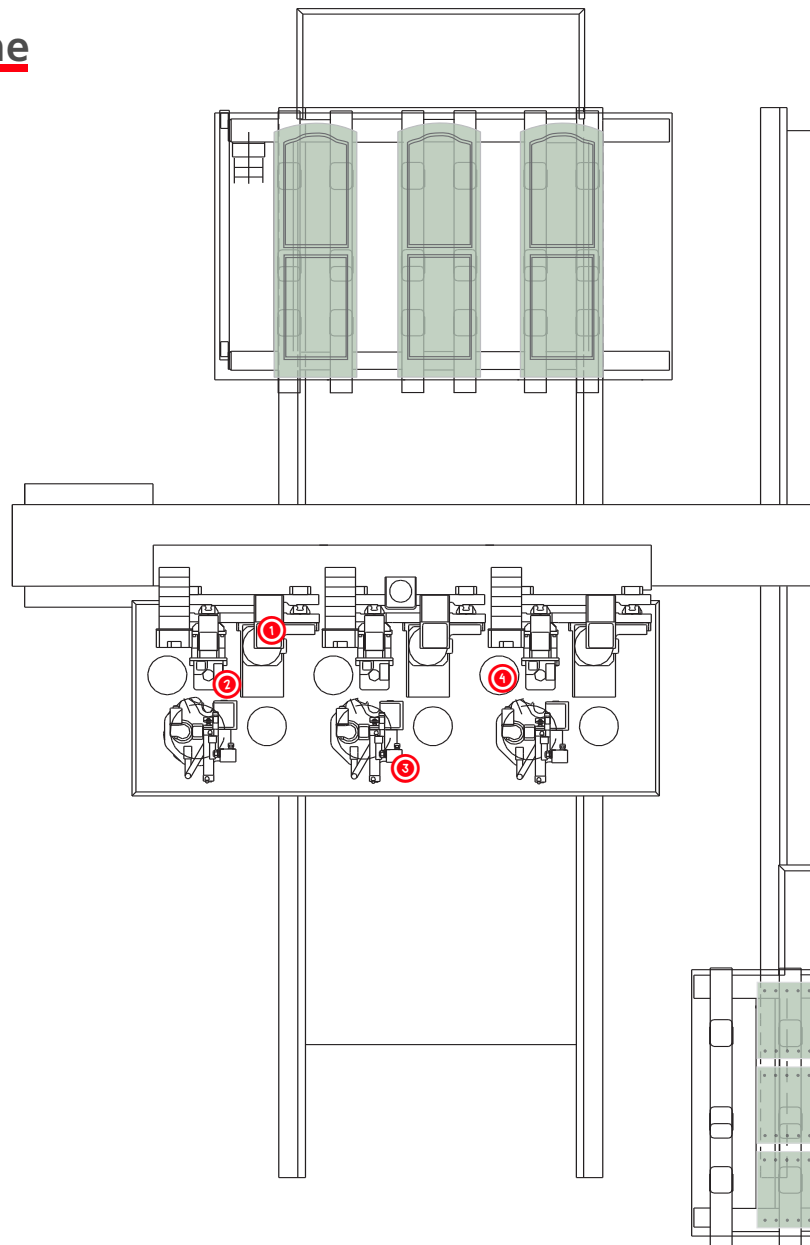



BIMA P 480 **Concept plus**

for your individual machine

BIMA P 480 **Concept plus** – the new concept for stationary
**CNC processing centre, equipped either as an
edge banding or routing and drilling machine**

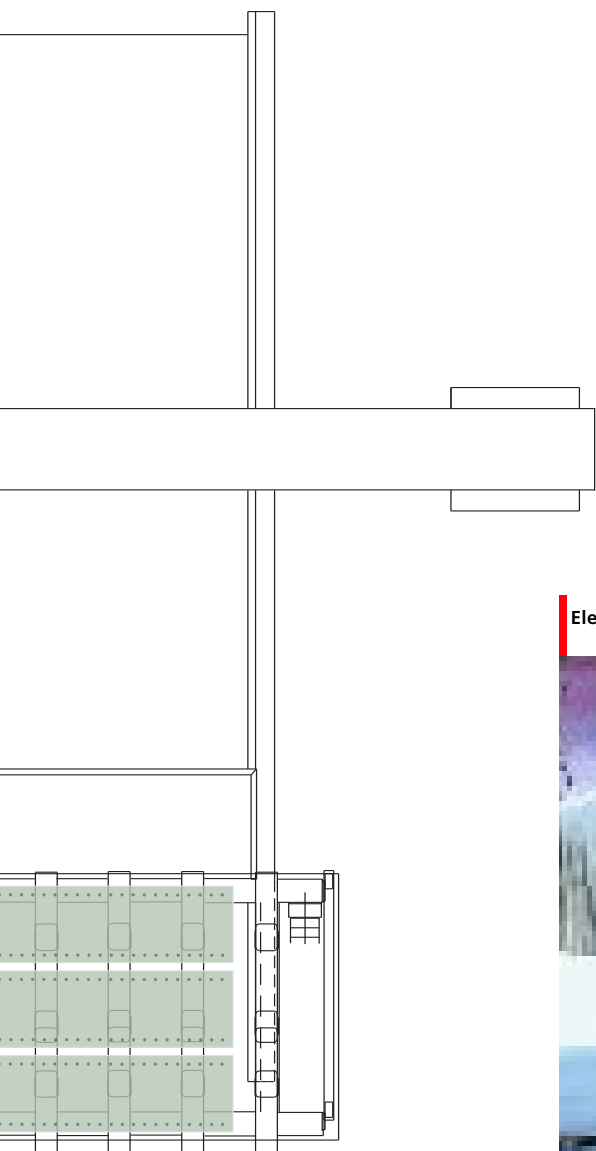

Electronic tracing system [optional]



Dyna-Point working table
Fully automatic set-up of the vacuum cups





DRILLING UNIT

- 14 or 21 spindles

C AXIS

- for adapter units

MAIN SPINDLE

- 7.5 or 12 kW

TOOL CHANGER

- 18 tools

COIL MAGAZINE

- 2 or 6 tape coils

GLUING UNIT



Drilling unit



Gluing unit

Edge banding machine

BIMA P 480 V

❖ ROUTING

❖ EDGE BANDING

❖ EDGE FINISHING

❖ DRILLING

Continuous machining of two panels, i.e. while the edge banding operation is being carried out on the front side of the gantry, the boring and edge finishing processes are taking place on the back of the gantry.

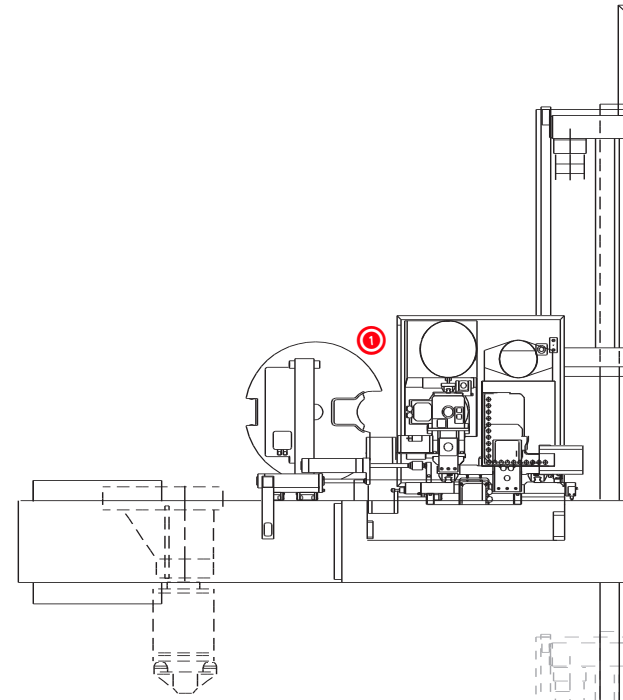

IMAWOP controller for automatic vacuum block positioning



LED-system for vacuum block positioning



End trimming unit

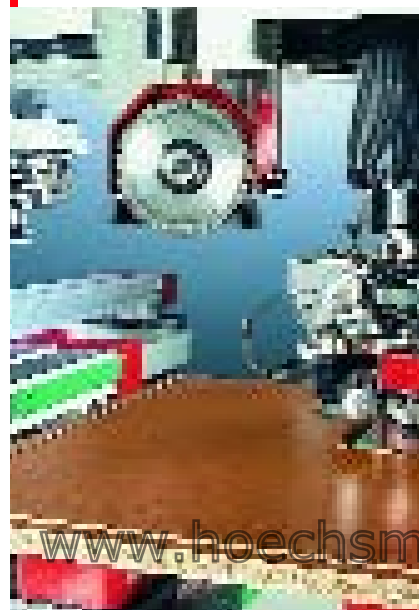



18-station tool changer and main spindle



Coil magazine

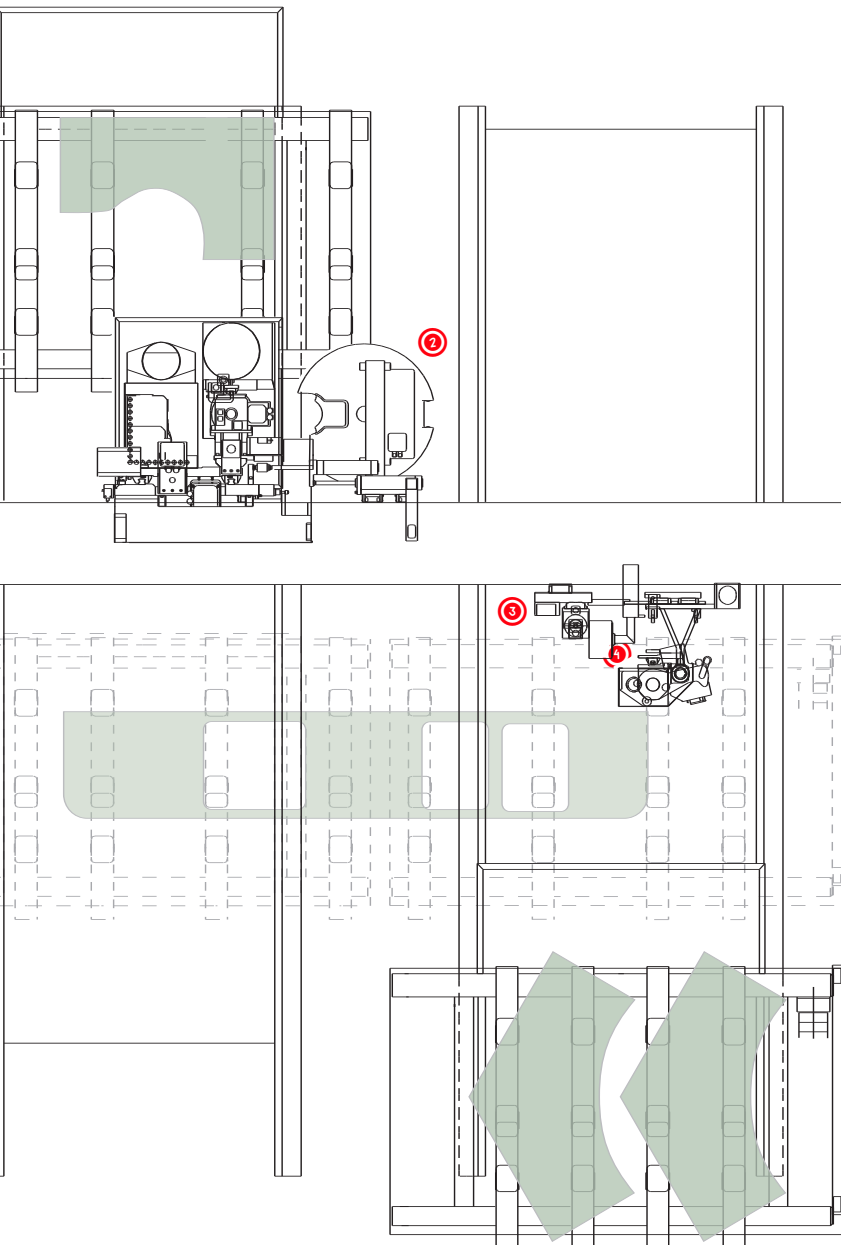

- ① MAIN SPINDLE WITH TOOL CHANGER AND DRILLING UNIT
- ② 2nd MAIN SPINDLE WITH TOOL CHANGER AND DRILLING UNIT [OPTION]

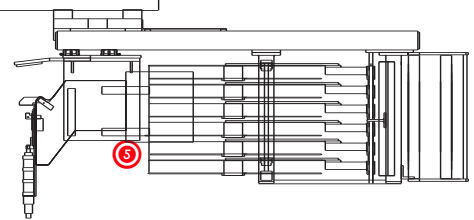

- ③ SEPARATE END TRIM SAW [OPTION]
- ④ GLUING UNIT
- ⑤ COIL MAGAZINE
 - 2 or 6 tape coils



BIMA P 480 **Concept plus**

Main characteristics

	BIMA P 480 Concept plus [Routing and drilling machine]	BIMA P 480 V Concept plus [Edge banding machine]
WORKING AREA		
X	2 x 2,400 mm	2 x 2,100 mm
Y	1,400 / 1,800 / 3,000 mm	1,400 / 1,800 mm
MACHINE		
Main spindle	7.5 kW – 14,5 kW (S1 operating mode 100 % usage)	7.5 kW – 14,5 kW (S1 operating mode 100 % usage)
Toolchanger	8-stations	18-stations
Travelling	x-direction	x-direction
Vertical drilling spindles	14 or 21	14 or 21
		C-axis (360°)
		Edge banding unit
OPTIONS		
	LED-system for vacuum block positioning	LED-system for vacuum block positioning
	Dyna-Point working-table	Dyna-Point working-table
	Chip conveyor belt	Chip conveyor belt
	2 nd or 3 rd main spindle	Various adaptor units
	2 nd or 3 rd tool changer	2 or 6 tape coils

Further options: on request

Subject to technical alterations and developments. The offer, respectively order confirmation are in any case the only relevant machine discription. The photographs may show the machine without complete safety equipment. However safety equipment will be supplied. Photographs may show options, which are not part of the standard execution.

Date 04/2005



IMA Klessmann GmbH
Holzbearbeitungssysteme
P.O. Box 12 46, 32292 Lübbecke
Industriestraße 3, 32312 Lübbecke
Germany
Fon +49 5741 331-0
Fax +49 5741 4201
<http://www.ima.de>
contact@ima.de

www.hoechsmann.com