

edge banders, sizing edge banders

olimpic k 230 evo

compact automatic edge bander



olimpic k 230 evo

compact automatic **edge bander**

Easy-to-use and with all inclusive equipment: olimpik k 230 evo, due to its advanced technological solutions designed to ensure optimal panel finishing, is the perfect edge bander for companies beginning and requiring professional edge banding



OLIMPIC		K 230 EVO
Panel thickness	mm	8 - 50
Edge thickness	mm	0,4 - 3
Feed speed	m/min	9
Compressed air	bar	6



- ▶ cutting
- ▶ **edge banding**
- ▶ boring-routing
- ▶ calibrating-sanding
- ▶ assembling

olimpic k 230 evo

technological advantages

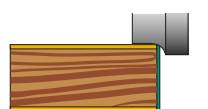

Thin edge

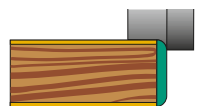

Thick edge

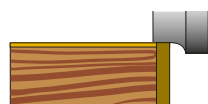

Solid wood

TRIMMING UNIT: 3 DIFFERENT MACHINING

Rapid machining changeover between thin, thick and solid wood edges due to the 3 working positions and the “Combi” tool supplied as a standard feature.



K-2 END CUTTING UNIT: CUT AND “RADIUS” IN A SINGLE OPERATION

Automatic and error free cutting of thick edges due to the particular system with two blades that allows the straight cutting of solid wood edges and the chamfering of the thin edges.



ORION ONE PLUS CONTROL SYSTEM: SIMPLE AND INTUITIVE MACHINE USE

Error-free machining is ensured by the control with its buttons and customised graphics and 4” display allows an easy selection of the main machine functions.

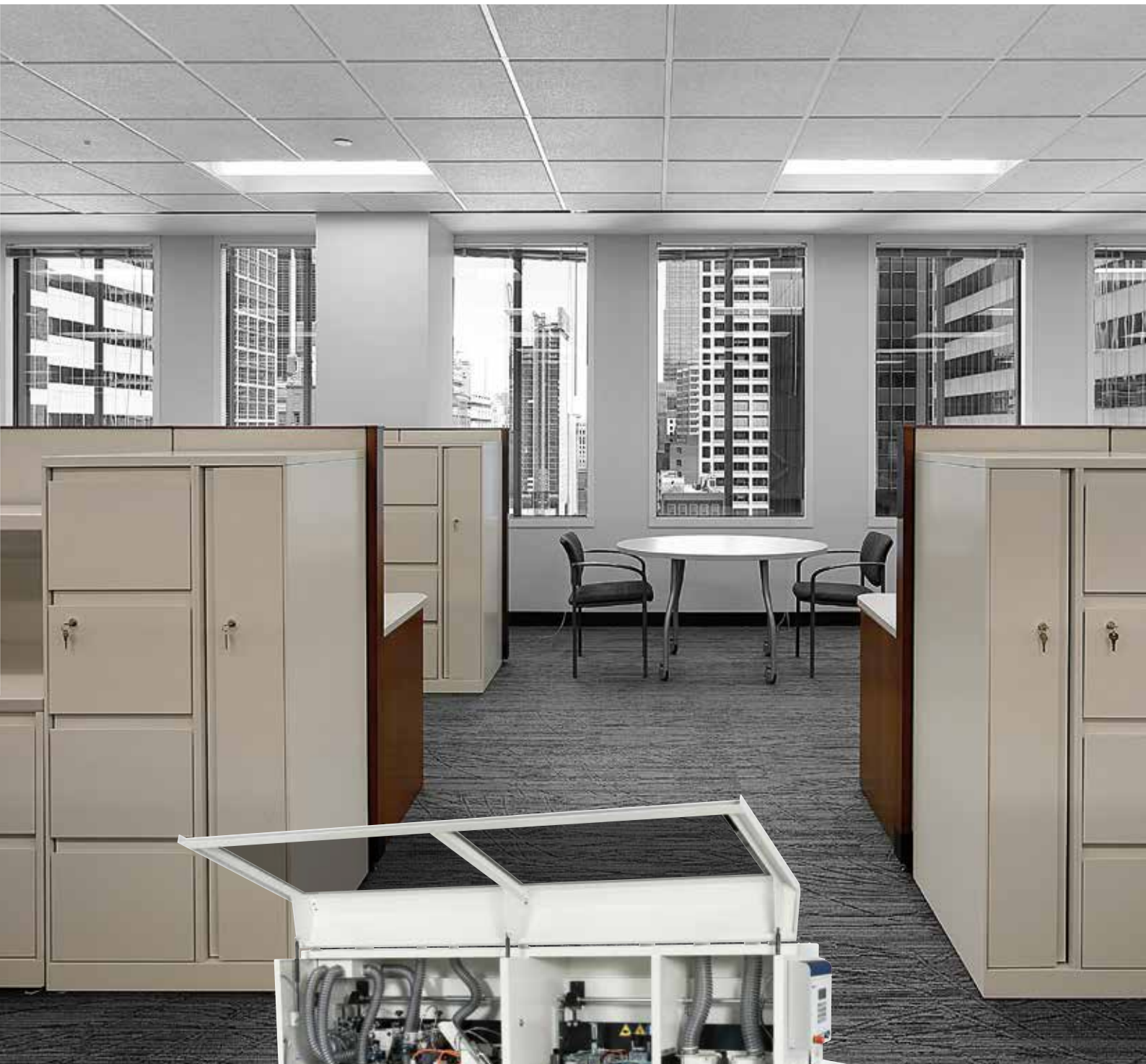

olimpic k 230 evo

operating groups

ORION ONE PLUS CONTROL SYSTEM:

SIMPLE AND INTUITIVE MACHINE USE

Error-free machining is ensured by the control with its buttons and customised graphics and 4" display allows an easy selection of the main machine functions.

- visualisation of the main production data
- diagnostics to obtain a quick solution to any malfunctions



AAR ANTI-ADHESIVE GROUP

The highest level of panel cleaning by utilising spray guns that prevent any sticking of excess glue on the upper and lower panel surfaces (opt.).

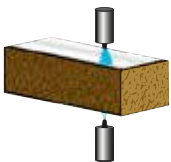

RT-V1 PANEL EDGE TRIMMING GROUP: A PERFECT EDGE JOINT LINE.

Surface without any imperfection on the panel edge before gluing. Utilises 2 motors with opposite rotation and with **large diameter diamond tools (100 mm)**.

- panel edge trimming up to 3 mm thickness
- adjustment of the tool cutting position

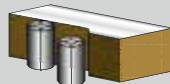

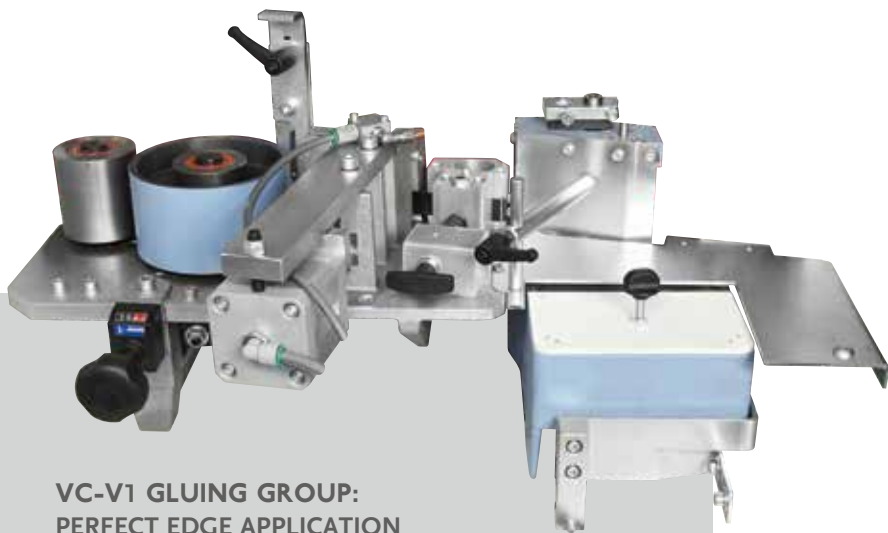

**VC-V1 GLUING GROUP:
PERFECT EDGE APPLICATION**

Optimal edge gluing is guaranteed by a particular glue spreading roller providing a **uniform and optimised glue application** and the absence of excess glue on all types of material. Automatic lowering of the glue temperature after a temporary halt in using the machine. Rapid glue pot substitution and double thermoregulation system for the use of 2 types of glue (option).

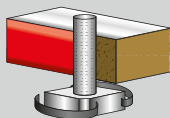

**KIT FOR MACHINING OF EDGES
IN STRIPS**

Automatic loading of edges in strips with thickness 0,4-3 mm (opt.)



**K-1 END CUTTING GROUP
ALWAYS GIVES THE BEST CUTTING QUALITY**

The best finishing quality in all edge banding operations utilising motors sliding on vibration free hardened, ground steel round bars and with the two blades with independent copying devices.



**K-2 END CUTTING GROUP:
CUT AND "RADIUS" IN A
SINGLE OPERATION**

Automatic and error free cutting of thick edges due to the particular system with two blades that allows the straight cutting of solid wood edges and the chamfering of thin edges - group with two motors (optional group supplied to replace the K-1 end cutting group)



olimpic k 230 evo

operating groups

“COMBI” TOOLS

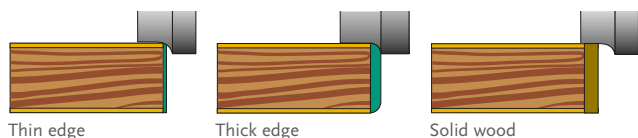

R-K TRIMMING GROUP: HIGH WORKING VERSATILITY

Rapid machining changeover between thin, thick and solid wood edges due to the 3 manually selectable working positions and the “Combi” tool supplied as a standard feature.

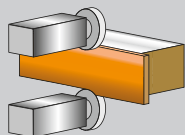

RAS-V EDGE SCRAPING GROUP: FOR PERFECT PVC/ABS RADIUS EDGES

High finishing quality of PVC/ABS edges due to the complete **elimination of any of the marks** left from the trimming group tools (opt.).

- the group is supplied, as a standard feature, with an extraction hood complete with a suitable container and filter for long chips.

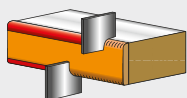



NESTING COPYING DEVICES

The best panel finishing with holes for hinges on the upper side due to the copying devices with 3 rotating contact points.
(optional device for trimming unit and edge scraping unit)

**RC-V GLUE SCRAPING GROUP:
A PERFECT EDGE JOINT LINE**

It eliminates any excess glue on the panel/edge joint.

It allows the removal of any excessive plastic edges (0,1 mm for edges up to 1 mm) (opt.).
- the group is supplied, as a standard feature, with extraction hoods.

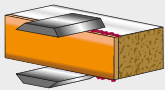

PANELS FEED TRACK

Better holding and movement linearity of the panel due to the large dimensioned industrial chain (1-1/4").

BRUSHING UNIT

Cleaning and polishing of the panel edge (opt.).

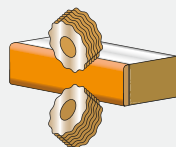

olimpic k 230 evo

OLIMPIC K 230 EVO

dimensions

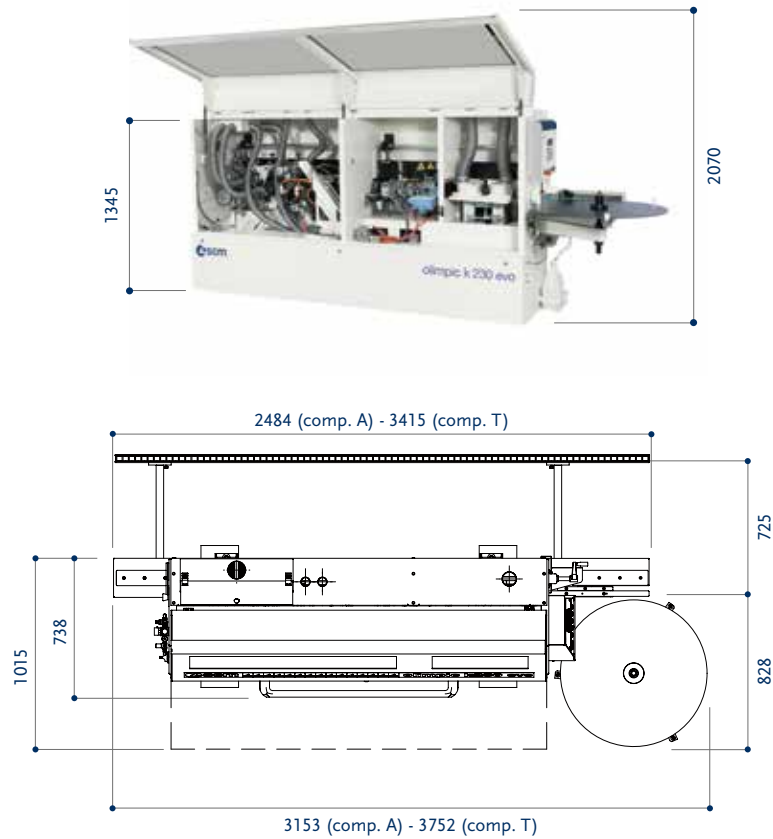

OLIMPIC K 230 EVO

available solutions

A	1/2	1						
T	1/2	1						
OPTIONAL GROUPS	1/2	→			1	→		
			A option	B option			A option	B option

Noise levels according to the reference standard EN 1218-4:2004* A2:2009.



LOWER CONSUMPTION = LOWER COSTS
SavEnergy allows the use of power only when it is required, making things operate only when they are really necessary. It means the machine automatically enters "stand-by" mode when there are no panels to be machined at any particular time. Year saving up to 10% (opt.).

THE STRONGEST WOOD TECHNOLOGIES ARE IN OUR DNA

SCM. A HERITAGE OF SKILLS IN A UNIQUE BRAND

Over 65 years of success gives SCM the centre stage in woodworking technology. This heritage results from bringing together the best know-how in machining and systems for wood-based manufacturing. SCM is present all over the world, brought to you by the widest distribution network in the industry.

65 years history

3 main production sites in Italy

300.000 square metres of production space

17.000 machines manufactured per year

90% export

20 foreign branches

350 agents and dealers

500 support technicians

500 registered patents

In SCM's DNA also strength and solidity of a great Group. The SCM Group is a world leader, manufacturing industrial equipment and components for machining the widest range of materials.

SCM GROUP, A HIGHLY SKILLED TEAM EXPERT IN INDUSTRIAL MACHINES AND COMPONENTS

INDUSTRIAL MACHINERY

Stand-alone machines, integrated systems and services dedicated to processing a wide range of materials.



WOODWORKING TECHNOLOGIES



TECHNOLOGIES FOR PROCESSING COMPOSITE MATERIALS, ALUMINIUM, PLASTIC, GLASS, STONE, METAL

INDUSTRIAL COMPONENTS

Technological components for the Group's machines and systems, for those of third-parties and the machinery industry.



SPINDLES AND TECHNOLOGICAL COMPONENTS



ELECTRIC PANELS



METALWORK



CAST IRON



The technical data can vary according to the requested machine composition. In this catalogue, machines are shown with options. The company reserves the right to modify technical specifications without prior notice; the modifications do not influence the safety foreseen by the CE Norms.



is more



SCM GROUP SPA

via Casale 450 - 47826 Villa Verucchio, Rimini - Italy
tel. +39 0541 674111 - fax +39 0541 674274
scm@scmgroup.com
www.scmwood.com



00L0365465H