



**Optimat  
BP100-140**

Your perspicacity  
into the  
successful direction



# Optimat Processing Centre BP100 up to BP140 – The future orientated All-round Talents



## Optimat Philosophy

The **Optimat** machines from WEEKE are well known for High Tech, legendary quality and reliability.

As these Optimat machines are manufactured in big quantities at our main factory in Herzebrock (Germany), we are able to offer a low cost and compact concept. The machines are manufactured with component and aggregate groups to provide a multiple usability for other machine types. Therefore we ensure a permanent reliability of proven technology.

**B**eneficial  
**P**ractical  
**O**riginal  
**P**recise  
**T**imesaving  
**I**nnovative  
**M**arket orientated  
**A**dvanced  
**T**raditional

## As individual as the Praxis

Boring, grooving, cutting, formatting and profiling in all its varieties whether for the interior design, shop builder or trade fair booth builder, the craftsmen shop or industry- the ideal machine concept for the entry into the Stationary technique is called **Optimat BP100**. This machine series exactly offers the versatile possibilities you need for your daily production. For all kinds of materials: solid wood, particle board, MDF, hard board, plastics, etc.

Your partner for the future.  
A member of the HOMAG-Group  
Certified on  
DIN EN ISO 9001.

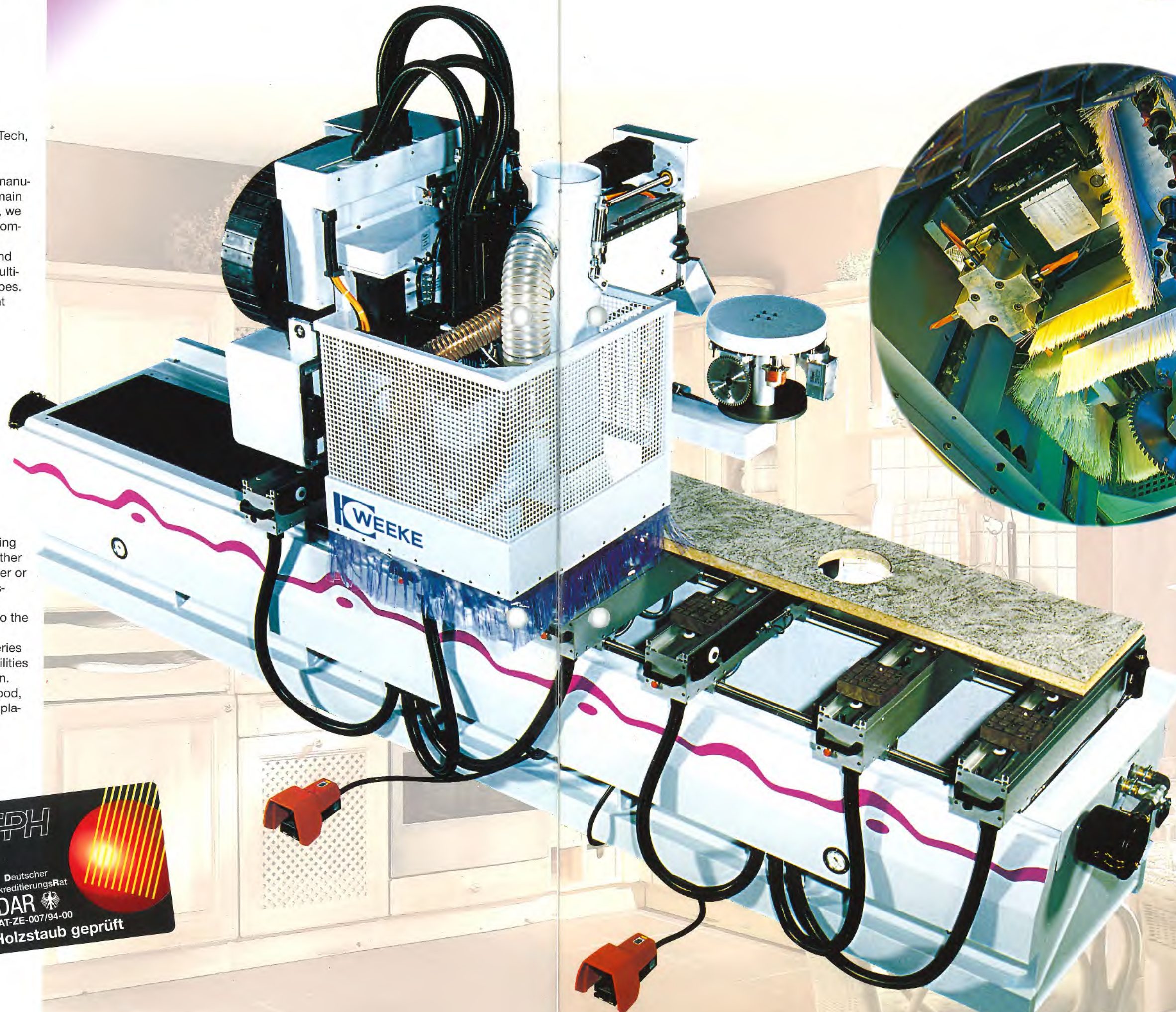

Equipment  
BP140 Optimat



# Variant diversity controls every day work – Technique with ingenuity: The HSK - interface

## The aggregate component group

For versatile processing tasks, the processing aggregates are automatically changed from the tool- and aggregate magazine. The aggregates can be rotated via program by an integrated C-axis from 0 - 360°.

Grooving, boring, cam-box processing or routing aggregates, the usability for the future is guaranteed due to the modular design of the component groups. Different units, components or groups can be added later on. Later equipment of special units or component groups are pre-considered during design and manufacturing of all machines. The optimal solution for unknown future products.

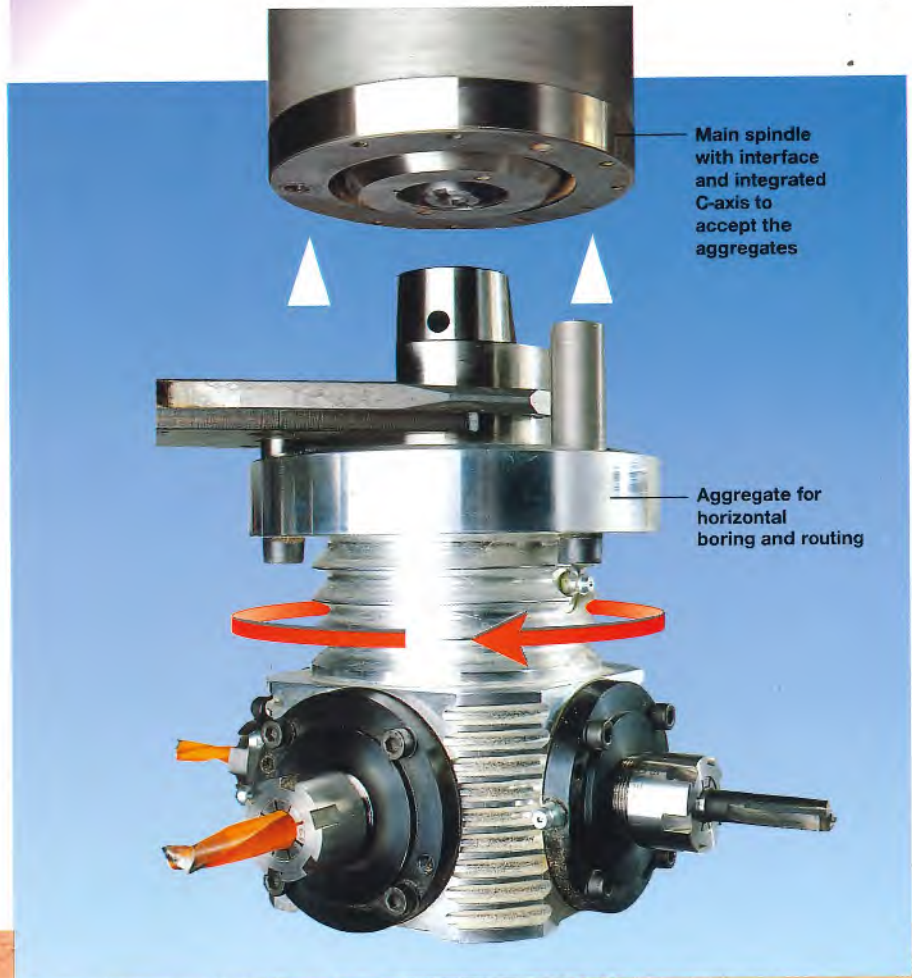

① Aggregate cam box processing



③ Aggregate saw



④ Aggregate saw, inclineable



⑤ Aggregate horizontal boring and routing



② Aggregate high speed routing up to 30.000 Rpm







6

Aggregate boring/routing, inclineable



7

Aggregate corner chamfer



8

Aggregate Routing vertical floating



9

Aggregate horiz. boring

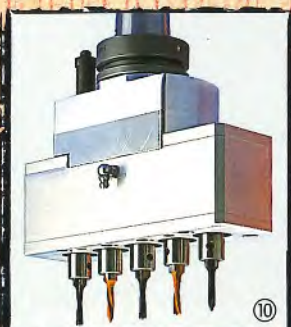

10

Aggregate vertical boring

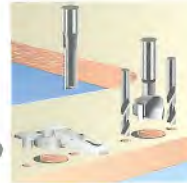
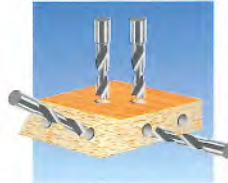



## Tool changer magazine provisioned with 30 tool locations. Tool changing? Times are no issue for us!

Extensive machining processes, e.g. in solid wood, require a great number of aggregates and tools. To meet requirements like these the machine range BP120/BP140 offers a segmented chain tool changer provisioned with 30 tool locations.

The economy of a machining centre depends on short tool changing times - particularly within a processing cycle which requires numerous aggregates and tools.

Taking this into consideration, we decided to use a specialised tool changing system.

Whilst processing, the following tool moves into ready position. The tool which has been replaced is withdrawn into the magazine immediately whilst processing still continues.

As the tool changing is running in the background of the running processing cycle tool changing times have been divided into half in comparison with conventional systems.

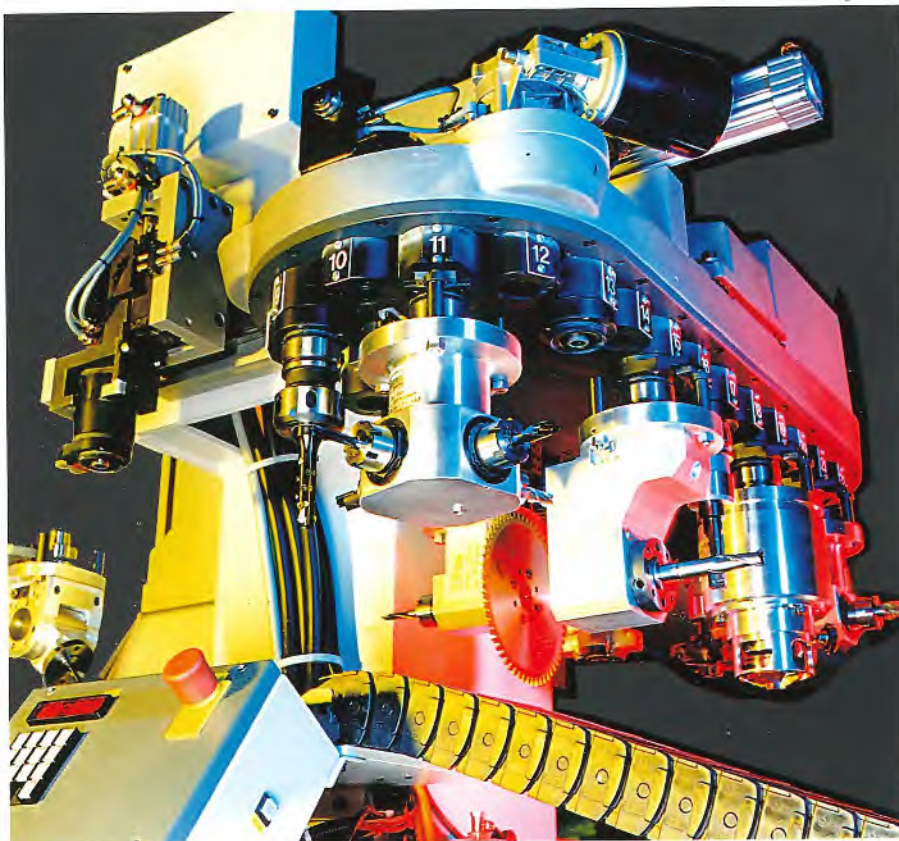

The tool which has been replaced is withdrawn into the magazine immediately whilst processing continues. ▼

▲ While processing, the following tool moves into ready position.

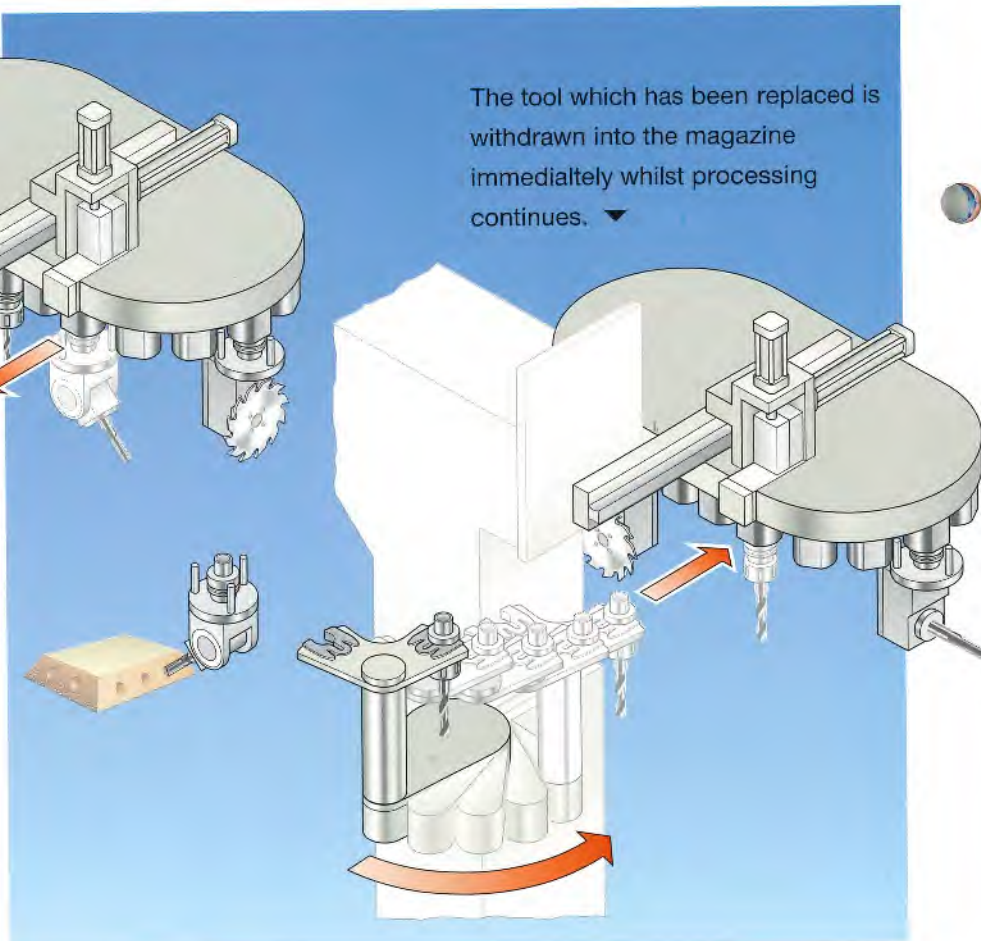



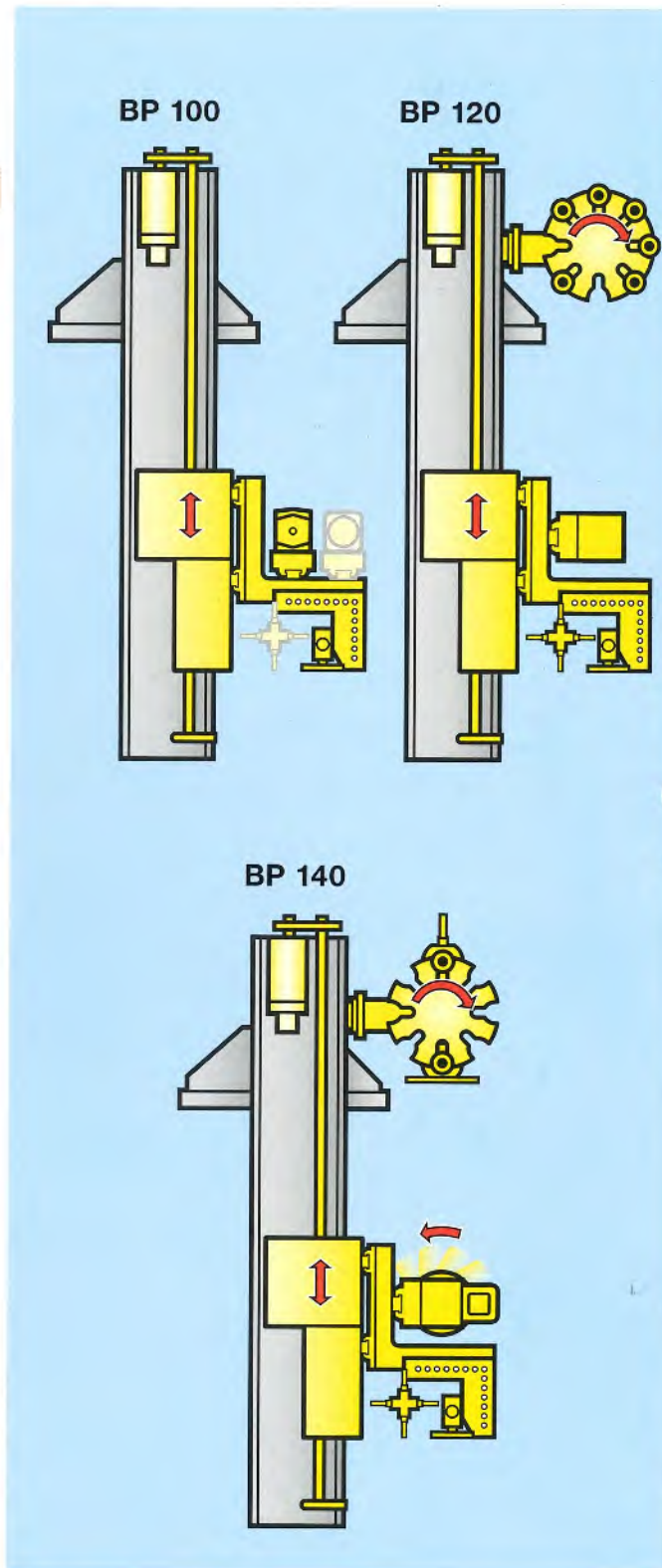
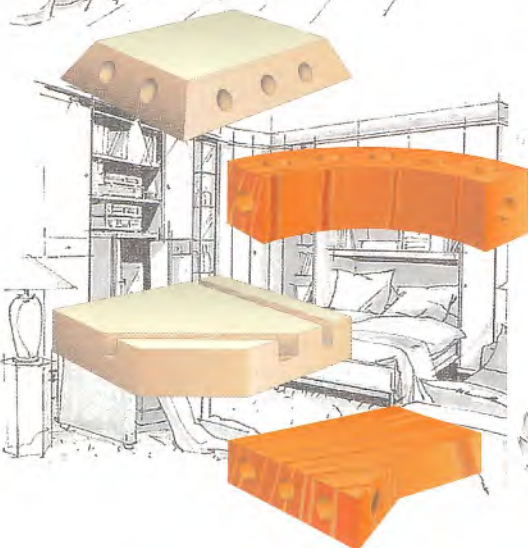
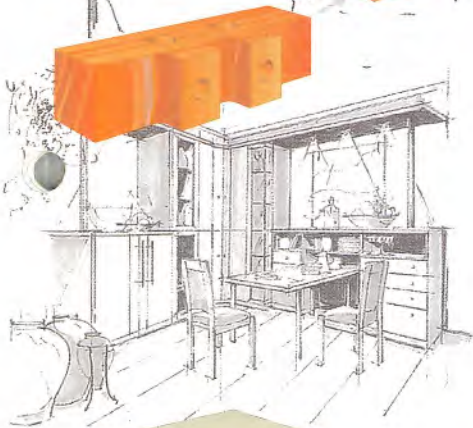
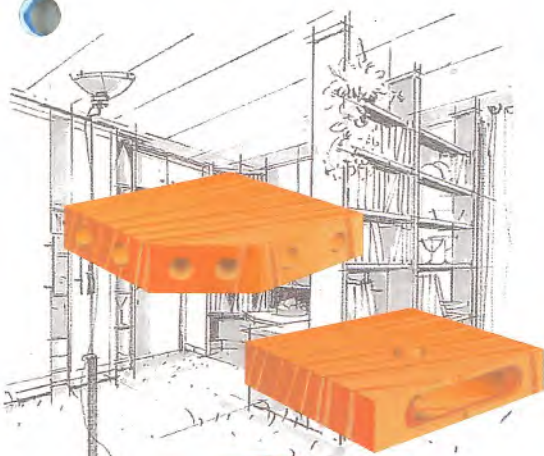
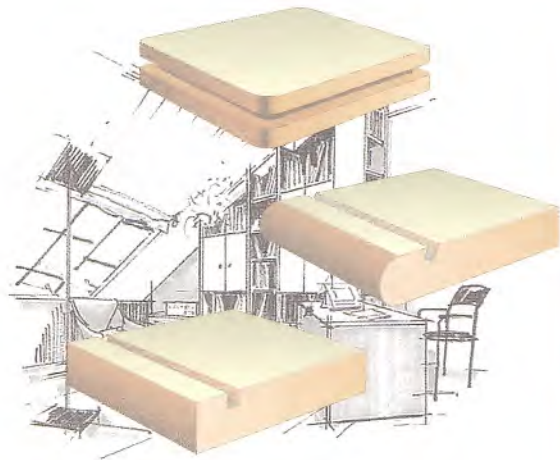



# Where to place Optimat machines? In conventional productions!

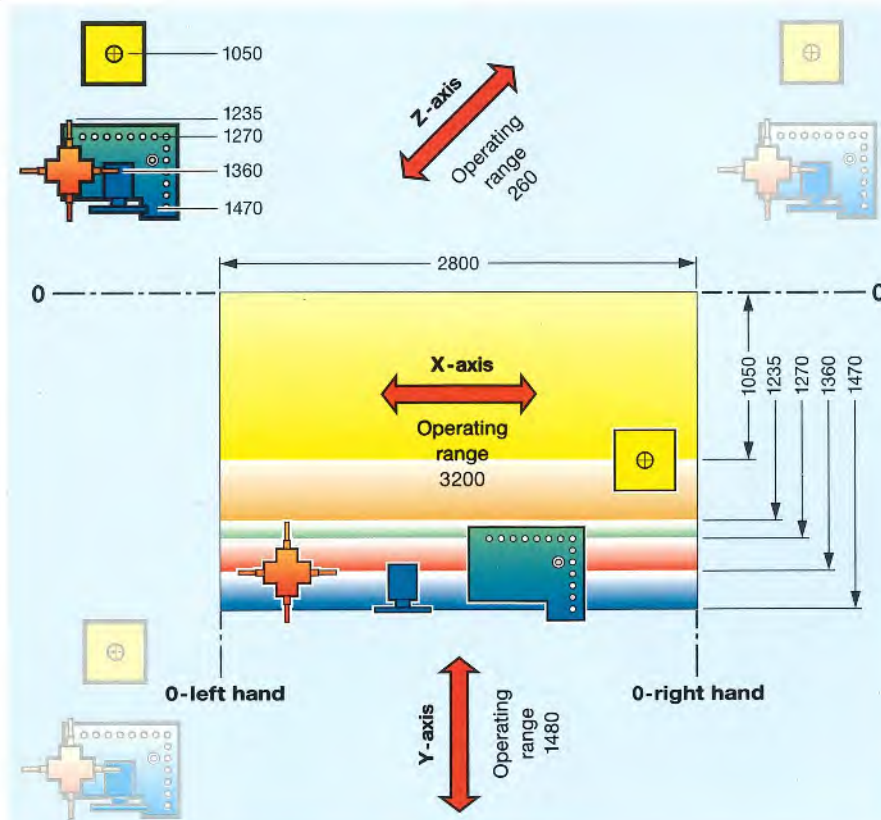
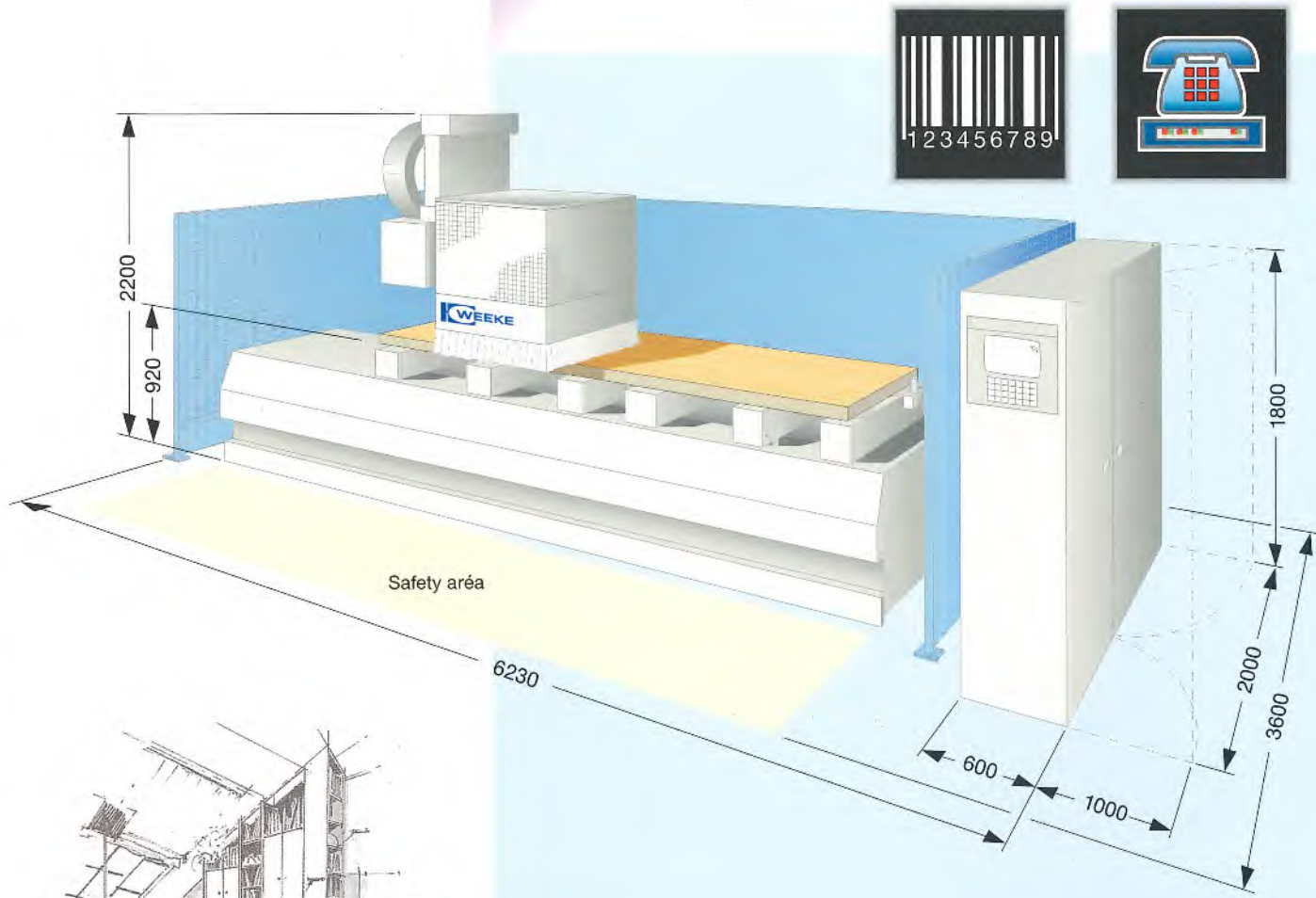

# Highlights in hard- and software

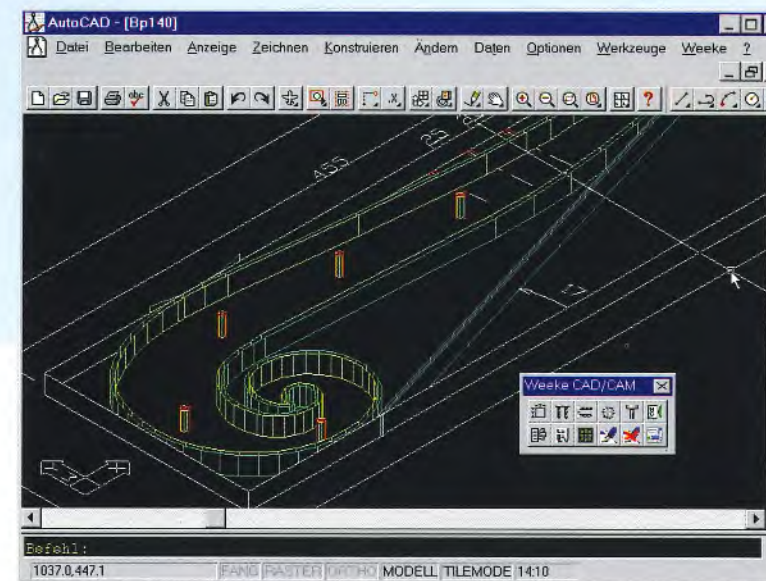
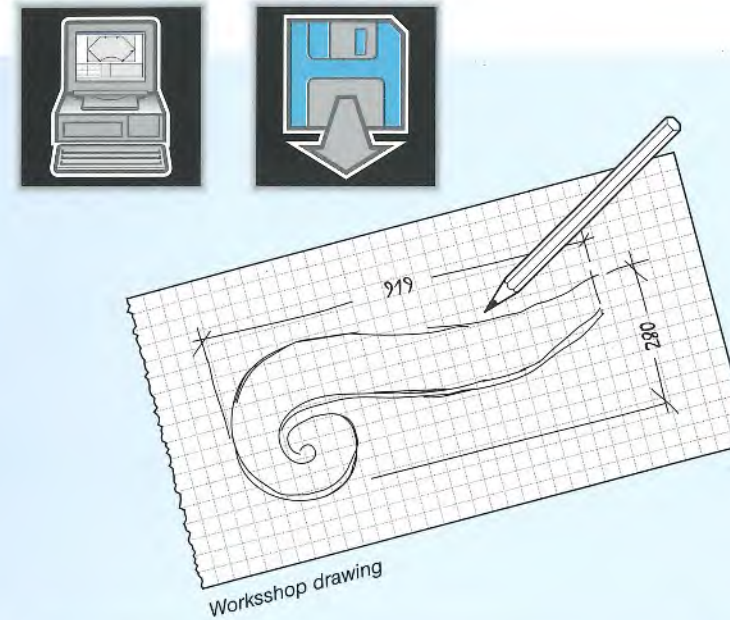

PC-Workstation

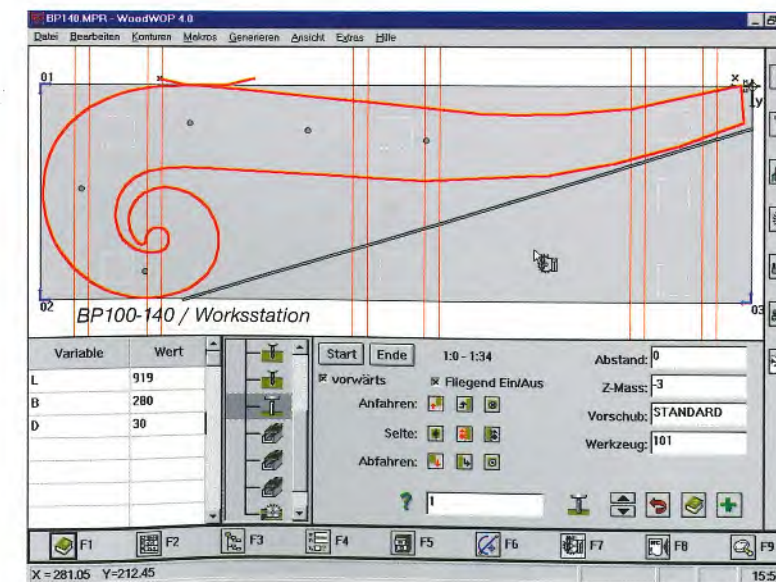

BP100-140 / Workstation

## WEEKE software development

User-friendly interfaces and efficiency are the distinct characteristics of software components which are being used in the CNC processing centre. The components have been developed on the basis of Microsoft-Windows® and therefore offer an easy start into CNC technology.

The workshop orientated programming system WoodWOP for Windows is the basis for the development of workpiece programs. As you use variant programming at the machine or in the office the number of the processing programs is reduced to a minimum. The integrated contour programming handles quickly and precisely the most complicated routing and other processing aggregates.

If you use a CAD system you can choose from AutoCAD® and AutoCAD LT®. You will find the results of years of experience in CAD/CAM systems in both systems - the one for the professional and the absolute beginner.

Next to MDE (machine data entry) for the recording of machine and production data, production lists with a connection to a database gain more and more importance in a modern production company. Furthermore, the processing centre offers a worldwide connection to more than 20 software programs of the wood processing industry.

The options of our machine range include compatibility within computer networks and a bar-code system.

Remote diagnostics via modem optimises the availability of the machine. On top of that we offer customer service including service-Online diagnostics and programming help in our training centre.



**No sunset in our market – Activity on all continents.**

**50 years Weeke**

Gustav WEEKE Maschinenbau has a long tradition in building machines. Since 1945 we have been serving the woodworking industry and craftsmen. In 1986 WEEKE joined the Homag Group of Companies, selling around the world.

The character of a medium-sized company has been maintained for the customer's sake. Best possible cooperation and flexibility are granted.

Innovative technology and high quality are the goals when we develop, design and build machines. Design by means of CAD, production on CNC machining centres, inhouse software development as well as a worldwide service organisation are the foundations which guarantee capacity and reliability of machines and installations to our customers. Joining the Homag Group has distinct advantages for our customers in regard to standardization of design, controls and service in order to increase the productivity of Weeke machines and systems.

Messrs. Gustav Weeke and its representing companies are facing your opinion.

**Quality is the satisfied customer!**

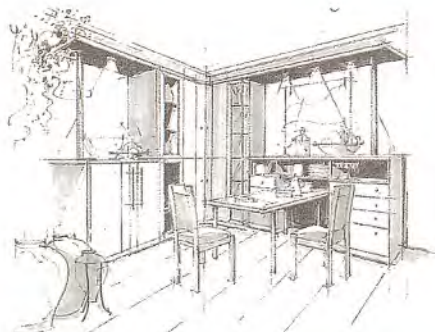

**The challenge**

World-wide the woodworking industry and we the supplier have to focus on increasing competition. Competing means improving and combining the structure of the increasing complexity of processing to keep competitive together with satisfied customers.

New ideas, new ways and new solutions will be the only means to secure our common future.

**Consolidate your competitive advantage by investing into a technology today whilst others only start thinking about it tomorrow.**





No sunset in our m

**Homag**



**Homag**  
DO BRASIL

**Homag**  
ANDERSON CHINA

**FRIZ**

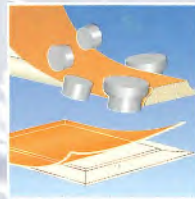

**BARGSTEDT**



**Brandt**

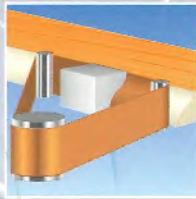

**LIGMATECH**



**HOLZMA**



**Homag**  
ESPANA



**WEEKE**

**Homag**  
AUSTRALIA

**Homag**  
CANADA

**Homag**  
FRANCE

**Homag**  
ITALIA

**Homag**  
SINGAPORE

**HORNBERGER**  
Industrieanlagen

Your contact:



**Gustav Weeke**  
**Maschinenbau GmbH**  
P.O. Box 1355  
D-33441 Herzebrock-Clarholz  
Phone +49-52 45-4 45-0  
Telefax +49-52 45-4 45-39