

Ciclo di lavoro  
Working operation

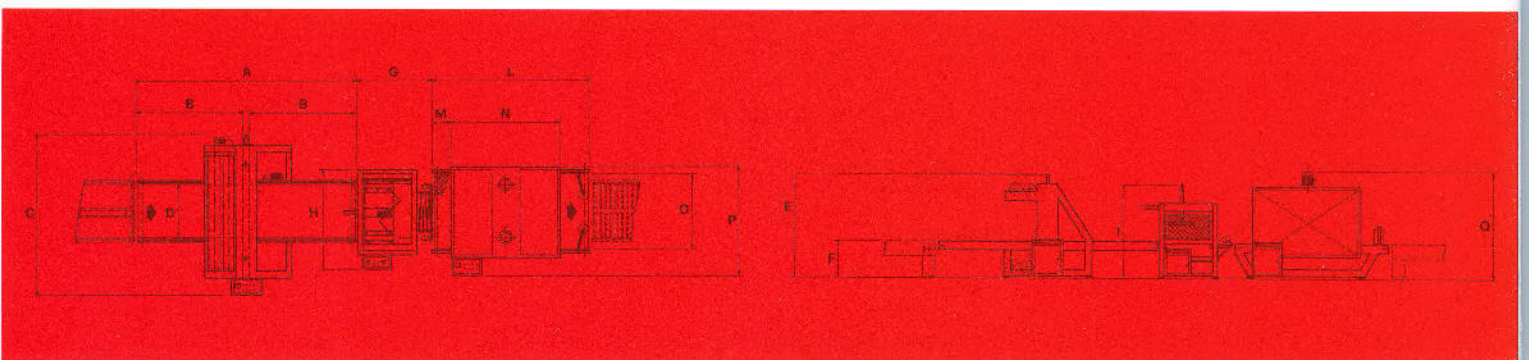
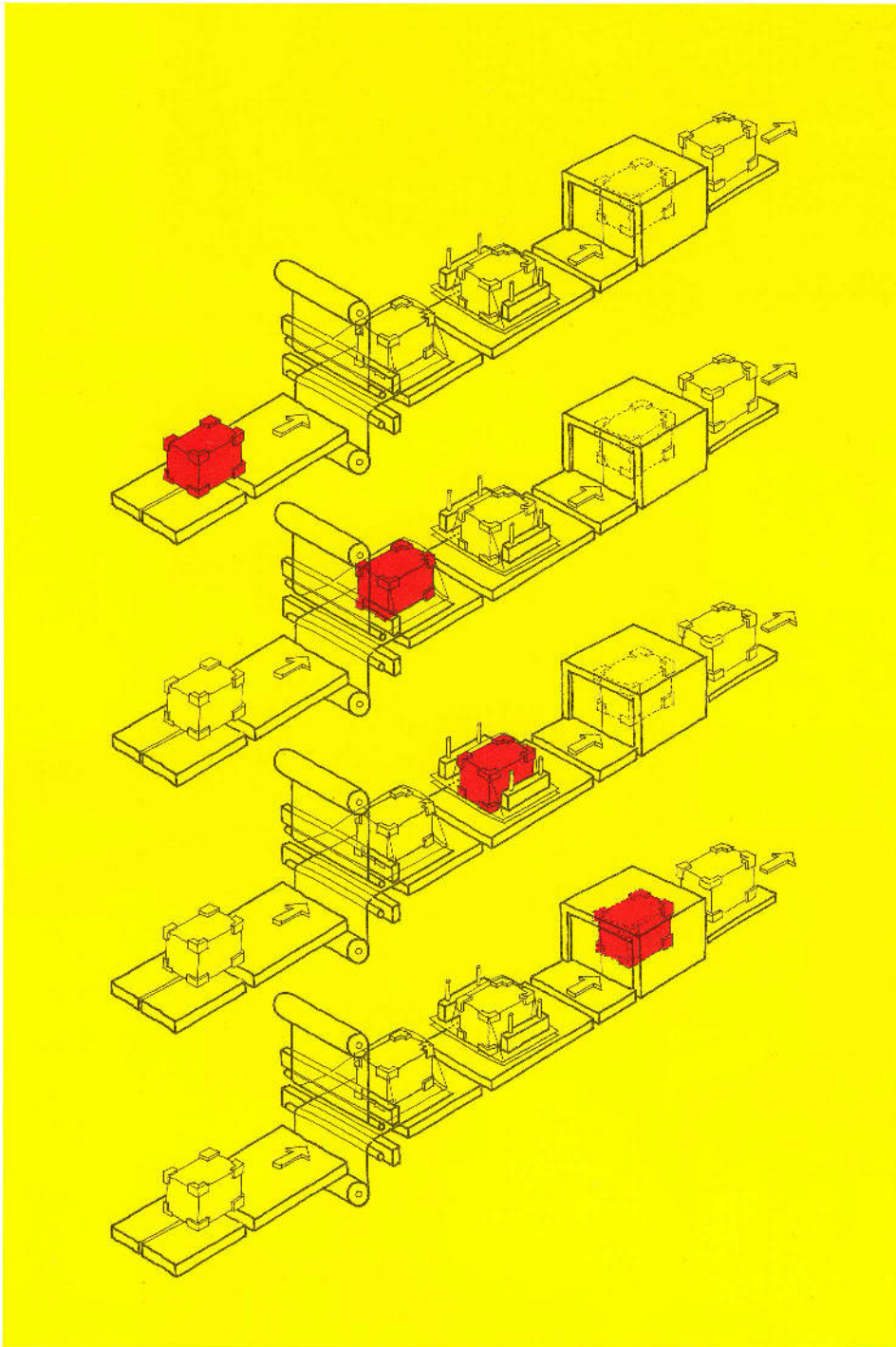

CARATTERISTICHE TECNICHE		STAR 80	STAR 110	STAR 110 L	STAR 150 B	STAR 150	STAR 200	STAR 250	STAR 250 G
Potenza installata	Kw.	17	22	32	43	47	52	52	68
Potenza esercizio	Kw.	11	14	20	28	30	35	35	40
Altezza utile max.	mm.	300	300	300	300	500	700	700	800
Larghezza max. Bobina Sup.	mm.	750	1050	1050	1450	1450	1950	2450	2450
Larghezza max. Bobina Inf.	mm.	750	1050	1050	1450	1450	1450	1450	1450
Spessore max. Polietilene		100 (micron)	100 (micron)	150 (micron)	150 (micron)	150 (micron)	150 (micron)	150 (micron)	150 (micron)
Peso macchina	Kg (N)	700 (6860)	800 (7840)	850 (8330)	900 (8820)	920 (9020)	1000 (9800)	1000 (9800)	1100 (10780)
Peso Tunnel	Kg. (N)	620 (6080)	670 (6570)	750 (7350)	780 (7650)	800 (7840)	1000 (9800)	1000 (9800)	1800 (17640)
Peso max. Pezzi	Kg. (N)	100 (980)	100 (980)	150 (1470)	150 (1470)	150 (1470)	150 (1470)	150 (1470)	150 (1470)
Peso min. Pezzi	Kg. (N)	10 (98)	10 (98)	10 (98)	10 (98)	10 (98)	10 (98)	10 (98)	10 (98)
Produzione (in funzione della lunghezza)	Pezzi/1"	1 + 5	1 + 5	1 + 5	1 + 5	1 + 5	1 + 5	1 + 5	1 + 5
Velocità trasporti	m/1'	3 + 15	3 + 15	3 + 15	3 + 15	3 + 15	3 + 15	3 + 15	3 + 15

TECHNICAL DATA		STAR 80	STAR 110	STAR 110 L	STAR 150 B	STAR 150	STAR 200	STAR 250	STAR 250 G
Installed power	Kw.	17	22	32	43	47	52	52	68
Working power	Kw.	11	14	20	28	30	35	35	40
Max. working height	mm.	300	300	300	300	500	700	700	800
Max. width upper foil roll	mm.	750	1050	1050	1450	1450	1950	2450	2450
Max. width lower foil roll	mm.	750	1050	1050	1450	1450	1450	1450	1450
Max. foil thickness		100 (micron)	100 (micron)	150 (micron)	150 (micron)	150 (micron)	150 (micron)	150 (micron)	150 (micron)
Machine weight	Kg (N)	700 (6860)	800 (7840)	850 (8330)	900 (8820)	920 (9020)	1000 (9800)	1000 (10780)	1100 (10780)
Tunnel weight	Kg. (N)	620 (6080)	670 (6570)	750 (7350)	780 (7650)	800 (7840)	1000 (9800)	1000 (9800)	1800 (17640)
Max. cabinet weight	Kg. (N)	100 (980)	100 (980)	150 (1470)	150 (1470)	150 (1470)	150 (1470)	150 (1470)	150 (1470)
Min. cabinet weight	Kg. (N)	10 (98)	10 (98)	10 (98)	10 (98)	10 (98)	10 (98)	10 (98)	10 (98)
Performance per min. (according to the length)	Pieces/1"	1 + 5	1 + 5	1 + 5	1 + 5	1 + 5	1 + 5	1 + 5	1 + 5
Conveyors speed	m/1'	3 + 15	3 + 15	3 + 15	3 + 15	3 + 15	3 + 15	3 + 15	3 + 15

### CARATTERISTICHE TECNICHE SALDATORI LATERALI MOD. COMET

Potenza installata	kw.	2,5
Altezza utile max.	mm.	800
Larghezza utile max.	mm.	1200
Larghezza utile min.	mm.	300
Larghezza utile a transfer	mm.	1300
Pressione alimentazione	Kg/cm <sup>2</sup>	5 + 8
Consumo medio specifico	dm <sup>3</sup> /ciclo	30
Peso	Kg. (N)	700 (6860)

### TECHNICAL SPECIFICATION SIDE WELDING UNIT MOD. COMET

Installed power	kw.	2,5
Max. working height	mm.	800
Max. working width	mm.	1200
Min. working width	mm.	300
Conveyor working width	mm.	1300
Air pressure	Kg/cm <sup>2</sup>	5 + 8
Average air consumption	dm <sup>3</sup> /cycle	30
Weight	Kg. (N)	700 (6860)

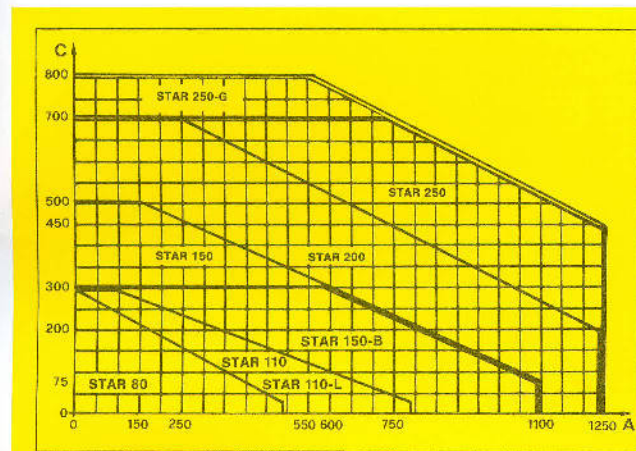

Dimensioni pezzi confezionabili  
Working sizes

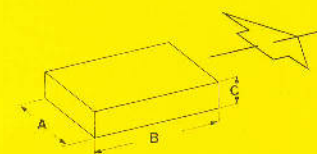

	Bmin.	Bmax.
STAR 80	350	700
STAR 110	350	1200
STAR 110 L	350	2200
STAR 150 B	350	2200
STAR 150	350	2200
STAR 200	350	2200
STAR 250	350	2200
STAR 250 G	350	2200

	STAR 80	STAR 110	STAR 110 L	STAR 150 B	STAR 150	STAR 200	STAR 250	STAR 250 G
A (mm.)	2700	2700	4850	4850	4850	4850	4850	4850
B (mm.)	1300	1300	2400	2400	2400	2400	2400	2400
C (mm.)	1800	1900	1900	2310	2310	2780	3220	3220
D (mm.)	800	900	900	1300	1300	1300	1300	1300
E (mm.)	1890	1890	1890	1890	1890	2190	2190	2190
F (mm.)	800	800	800	800	800	800	800	800
G (mm.)	1720	1720	1720	1720	1720	1720	1720	1720
H (mm.)	2270	2270	2270	2270	2270	2270	2270	2270
I (mm.)	2100	2100	2100	2100	2100	2100	2100	2100
L (mm.)	2350	2350	3500	3500	3500	3700	3700	4800
M (mm.)	200	200	250	250	250	250	250	400
N (mm.)	1400	1400	2500	2500	2500	2700	2700	3500
O (mm.)	700	1000	1000	1250	1250	1500	1500	1750
P (mm.)	1380	1680	1680	2340	2340	2390	2390	2490
Q (mm.)	1750	1750	1750	1850	1975	2165	2165	2390