

Edge Banding Machines Ambition Series 2200



www.hoechsmann.com

A member of the HOMAG Group AG



HOMAG Holzbearattungssysteme AG
Homagstraße 3-5
72296 SCHOPFLOCH
GERMANY
Tel.: +49 7443 13-0
Fax: +49 7443 13-2300
E-Mail: info@homag.de
www.homag.com

HOMAG AG best GB 2009 05

The HOMAG Group — Through partnership to success!

Fast, flexible and efficient production is essential to succeed in a highly competitive market. The HOMAG Group has a worldwide presence with sales partners in over 80 countries and is an ideal partner for your business. Strong partners are more important than ever, and we can ensure your success with our extensive expertise.

The companies of the HOMAG Group offer you unbeatable benefits, allowing you to build a competitive company and secure long-term success for your business. Utilise the innovative power of a globally successful group. To choose the HOMAG Group is to choose quality. Benefit from the decades of experience of the inventor of the hot-melt edge banding machine.

Ambition Series Perfect edges for demanding customers

For the Ambition series, we created a uniform, practical equipment standard: a belt-type top pressurebeam made of steel for precise work-piece guidance, all tools with I-system for optimum chip disposal and processing quality, variable feedspeed of 18–25 m/min for high productivity. The performance and functionality of the ambition series is tailored to the needs of industry and craft trade. The result: even the basic version of the machine covers 90% of all applications. It goes without saying that all machines in the Ambition series can be fully automated, are energy-efficient and environmentally friendly



"You and your products are number one with the HOMAG Group. A Partner that you can count on!"



One series — many materials

With the Ambition series, you can process edge materials such as rolls or strips or solid wood strips, e.g.:

- Melamine
- PVC
- ABS
- Multi-layer veneer edges
- Veneer edges (with FF12)



0,4 mm melamine



2 mm PVC



20 mm strip material



Veneer

Everything as standard

The most important features of the Ambition

To ensure efficient, high-quality production, all HOMAG Ambition machines have many standard features.



Feed speed 18–25 m/min

Stepless, controllable feed for high productivity. Your jobs will be processed faster

Belt-type top pressure beam

Steel with dual V-drive belts for accurate workpiece guidance and highest HOMAG processing quality

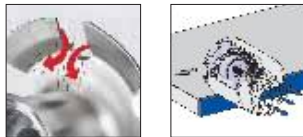

I-system — perfect quality and longer machine life

Revolutionary technology for controlled chip acquisition—chips are already extracted in the machine interior and fed directly to the suction hood.

- No uncontrolled flying chips as with conventional tools
- No more chips on tools during trimming or jointing
- Increased efficiency and service life thanks to reduced wear



Quickmelt incl. granulate material container

Optimizes glue application on narrow surfaces. Changes to the workpiece thickness do not require resetting of the glue application roller.

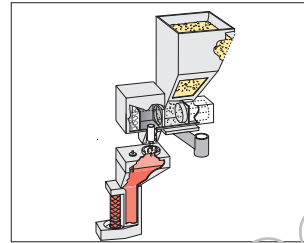

Pre-melting unit - melting unit with granulate material container

With melting performance of 6–12 kg/h, you will always have sufficient hot-melt glue.



and lower service costs
• Lower costs resulting from reduced Extraction speed.

HSK interface

With the hollow shaft cone tool interface (HSK), the tool and motor shaft are connected to each other with positive locking. Tolerances between the motor shaft and tool are zero. This ensures the best possible trimming quality thanks to the vibration-free and concentricity of the tool.

Your advantages at a glance:

- Robust construction
- Processing of all material types
- Optimum edge quality
- Increased availability thanks to maintenance-friendly machine layout
- Enhanced efficiency due to minimized Extraction requirements
- Low energy consumption
- Ergonomic control functions
- Optimum price/performance ratio

Operation and Control

As ergonomic as it is efficient — to ensure optimum use of the machine's capabilities, simple operation and safe control are of the utmost importance. The Ambition series uses a control solution tailored to the operator, which keeps manual interventions during machine operation to a minimum.



Standards

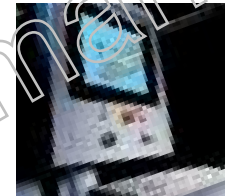

powerControl PC22

This modern, highly flexible control solution ensures that your machine is always ready for production:

- Simple and safe operation
- User-friendly menu navigation based on Windows XP standard
- Large 19" display provides overview of all machine functions
- Clear plain-text error messages in your own language

Touchscreen

Ease of use and simple operation — the operator merely has to "touch" the display to select all important functions, thus ensuring fast and safe production. Program selection, selection of edges and workpiece height changes are just some of the possibilities of this innovative control method.

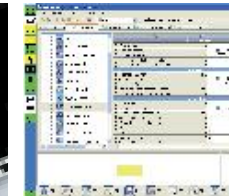

woodCommander

The programming system for all HOMAG throughfeed machines. Exceptionally user-friendly thanks to graphical input screens for simple navigation and menu guidance.



Schuler MDE basic

The recording of quantities and actual operating times on your machine provides clear information on its productivity. Integrated maintenance instructions ensure that necessary maintenance work is performed in line with the maintenance schedule.



Option : diagnostic system woodScout professional

In addition to the plain-text error messages, this powerful diagnostic system graphically indicates the malfunction location on the machine. Customers can store their own troubleshooting measures in woodScout, thus enabling continuous enhancement of the expertise already supplied with the diagnostic system.



USB port

Data input and storage on external USB memorystick enable simple data handling while securing the operational readiness of the machine.

Options

Option : TeleServiceNet

Fault finding analysis and diagnosis via Internet technology enable fastest possible service and support. A single connection provides access to all machines right down to the last link in the control chain.

Option : additional hard drive

For external data storage and faster recommissioning.

Option : remote control for single-sided machines

For easy adjustment of units, e.g. after tool sharpening

Ambition 2220

Big power in a small package

Ambition 2220 may be the smallest machine in the 2200 series, but it is certainly not short on technology. It enables gluing, precise snipping and finishing of edges up to 1 mm thick. The buffing unit on the outfeed provides the optimum quality. As an option, a joint trimming package consisting of a separating agent sprayer and joint trimming can also be fitted.

Coil edging materials (mm)	
a	at b = 22: min. 60 at b = 40: min. 105
b	12 (opt. 8) / 40 (opt. 60)
c	0,3 - 1,0
d	45 (option al 65)

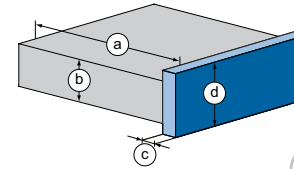

Buffing unit

Fine trimming unit 0.4 kW

Snipping unit HL81

Quickmelt

Hot-melt gluing unit A3

PC22 control unit with touchscreen

I-System + HSK interface

Free space Separating agent sprayer

Free space Jointing Trimming

Automation package no. 4009	Ambition 2220
Automatic chamfer/straight snipping motor adjustment	✓
Automatic chamfer or chamfer/radius adjustment for fine trimming (Servo)	✓ several chamfers
Electronic height adjustment	✓



Ambition 2240

More than just trimming

In addition to Ambition 2220, Ambition 2240 offers a profile scraper as well as a free space. It enables gluing, precise snipping and finishing of edges up to 3 mm thick. The buffing unit on the outfeed provides the optimum quality. The free space can be used either for a glue joint scraper or a universal trimming unit for grooving. The choice is yours. You also have the option of increasing the feed speed to 32 m/min.



	Coil edging materials (mm)
a	at b = 22: min. 60 at b = 40: min. 105
b	12 (opt. 8) / 40 (opt. 60)
c	0,3 - 3
d	45 (option al 65)
e	max. 25

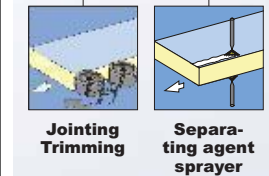
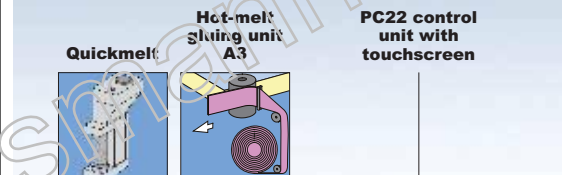
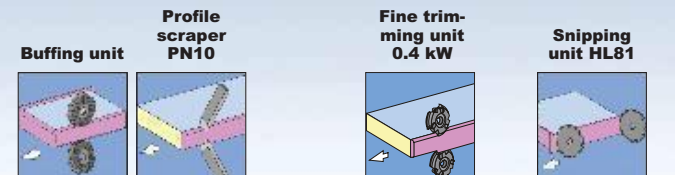
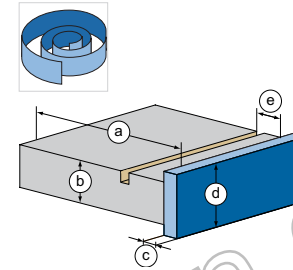

Automation package No. 4014	Ambition 2240
Automatic pressure zone adjustment (Servo)	✓
Automatic chamfer/straight snipping motor adjustment	✓
Automatic chamfer or chamfer/radius adjustment for fine trimming (Servo)	✓ Chamfer/ radius
Pneumatic adjustment of PN10 and FA11	✓
Electronic height adjustment	✓



Ambition 2250

Everything you need!

Ambition 2250 also features a profile trimming unit. It allows you to glue and finish edges up to 3 mm thick including the corner rounding. The buffing unit on the outfeed provides the optimum quality. The free space can be used for a universal trimming unit for grooving. The choice is yours. You also have the option of increasing the feed speed to 32 m/min.

	Coil edging materials (mm)
a	at b = 22: min. 60 at b = 40: min. 105
b	12 (opt. 8) / 40 (opt. 60)
c	0,3 - 3,0
d	45 (optional 65)
e	max. 25

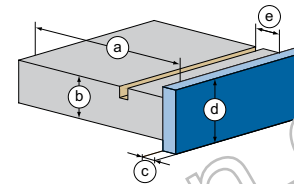

Finishing unit FA11
Profile scraper PN10

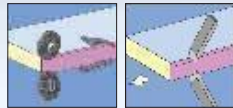

Fine trimming unit 0,4 kW

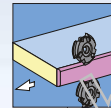

Quickmelt
Hot-melt gluing unit A3

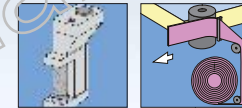

PC22 control unit with touchscreen



Automation package No. 4010	Ambition 2250
Automatic pressure zone adjustment (Servo)	✓
Automatic chamfer or chamfer/radius adjustment for fine trimming (Servo)	✓ Chamfer/radius
Automatic chamfer/radius adjustment for profile trimming (Servo)	✓
Pneumatic adjustment of PN10 and FA11	✓
Electronic height adjustment	✓



0,4 mm melamine



2 mm PVC



Veneer



I-System + HSK interface

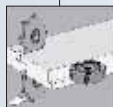

Free space Universal trimming unit UF10



Profile trimming unit FF12

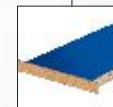

Servo-controlled edge feeding



Jointing Trimming

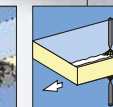

Separating agent sprayer

Ambition 2260

Edge finishing without compromise

Ambition 2260 enables gluing, precise snipping and refinishing of edges up to 3 mm thick, as well as corner rounding. The finishing unit on the out-feed removes any glue residue and provides the optimum quality. Ambition 2260 offers excellence in all areas—technology, quality, performance, function and design—and soon it will pay for itself.

	Coil edging materials (mm)
a	at b = 22: min. 60 at b = 40: min. 105
b	12 (opt. 8) / 40 (opt. 60)
c	0,3 - 3,0
d	45 (option al 65)

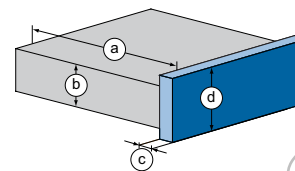

Finishing unit FA11



Profile scraper PN10



Fine trimming unit 0.4 kW

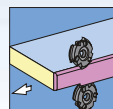

Snipping unit HL81

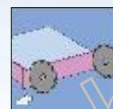

Quickmelt



Hot-melt gluing unit A3

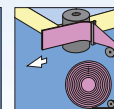

PC22 control unit with touchscreen

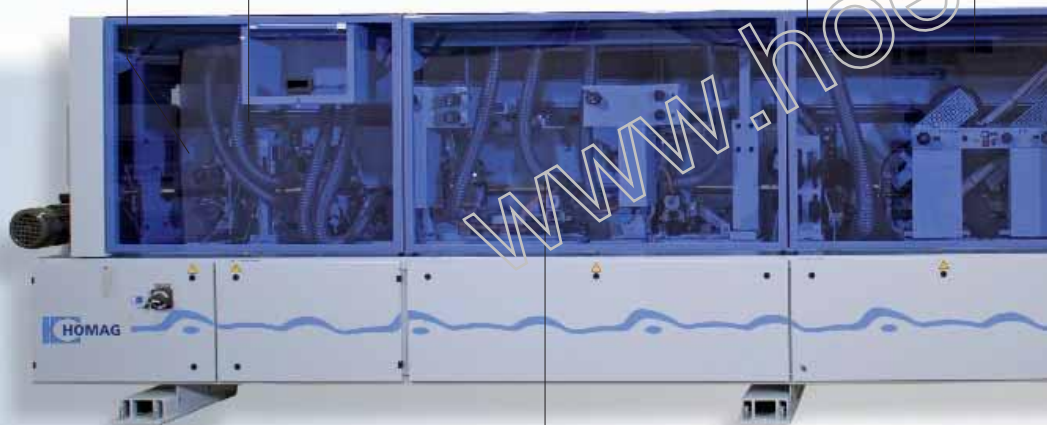

I-System + HSK interface



Profile trimming FF12

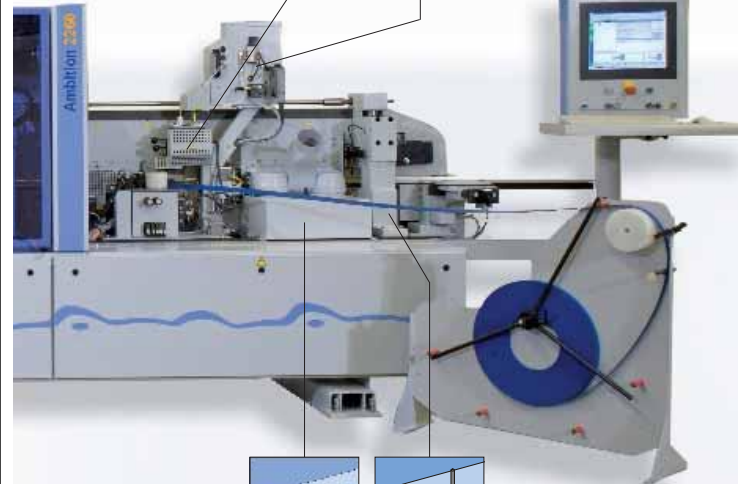

Jointing Trimming

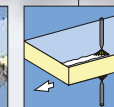

Separating agent sprayer

Automation package No. 4012	Ambition 2260
Automatic pressure zone adjustment (Servo)	✓
Automatic chamfer/straight snipping motor adjustment	✓
Automatic chamfer or chamfer/radius adjustment for fine trimming (Servo)	✓ Chamfer/radius
Automatic chamfer/radius adjustment for profile trimming (Servo)	✓
Pneumatic adjustment of PN10 and FA11	✓
Electronic height adjustment	✓



0.4 mm melamine



2 mm PVC



Veneer

Ambition 2262

6 mm strips? No problem!

Ambition 2262 enables gluing, precise snipping and refinishing of edges as well as corner rounding. The finishing unit on the outfeed removes any glue residue and provides the optimum quality. Gluing of solid strips up to 6 mm is not a problem. You also have the option of using PU. Avoid compromise and choose Ambition 2262. Did we mention the excellent price/performance ratio?

	Solid (mm)	Coils (mm)	Strips (mm)
a	at b = 22: min. 60 at b = 40: min. 105		
b	12 (opt. 8) / 40 (opt. 60)		
c	0,6 - 6	0,3 - 3,0	0,3 - 3,0
d	45 (option al 65)		

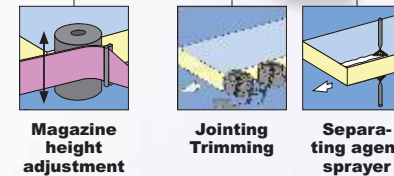
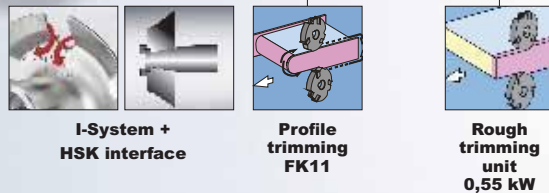
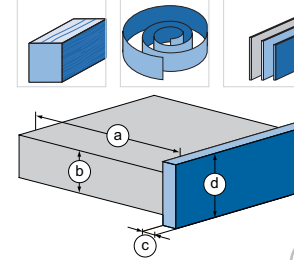

Automation package No. 4016 + 4017	Ambition 2262	
	4016	4017
Automatic pressure zone adjustment (Servo)		✓
Automatic chamfer/straight snipping motor adjustment	✓	
Automatic chamfer/radius adjustment for profile trimming (Servo)		✓
Pneumatic adjustment of PN10 and FA11	✓	
Electronic height adjustment	✓	



Ambition 2264

Standard for 20 mm strip material

Ambition 2264 enables gluing, precise snipping and refinishing of edges, as well as corner rounding. The finishing unit on the outfeed removes any glue residue and provides the optimum quality. Gluing solid strips up to 20 mm does not pose any problems. You also have the option of using PU. Avoid compromise and choose Ambition 2264. With its patented profile trimming solution, profile changes made dead easily.

	Solid (mm)	Coils (mm)	Strips (mm)
a	at b = 22: min. 60 at b = 40: min. 105		
b	12 (opt. 8) / 40 (opt. 60)		
c	0,6 - 20	0,3 - 3,0	0,3 - 3,0
d	45 (option al 65)		

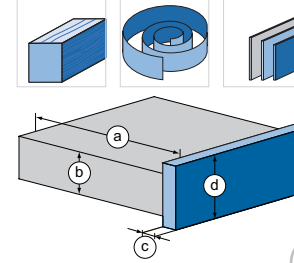

Finishing unit FA11

Profile scraper PN10

Snipping unit HL84

Quick clamping system

I-System + HSK interface

Profile trimming FK11

Rough trimming unit 1,5 kW

Quickmelt

Hot-melt gluing unit A20

PC22 control unit with touchscreen

Magazine height adjustment

Jointing Trimming

Separating agent sprayer

Automation package No. 4013	Ambition 2264
Automatic infeed fence adjustment (Servo)	✓
Automatic pressure zone adjustment (Servo)	✓
Automatic chamfer/straight snipping motor adjustment	✓
Automatic flush/overhang snipping motor adjustment	✓
Automatic chamfer/radius adjustment for profile trimming (Servo)	✓
Pneumatic adjustment of PN10 and FA11	✓
Electronic height adjustment	✓

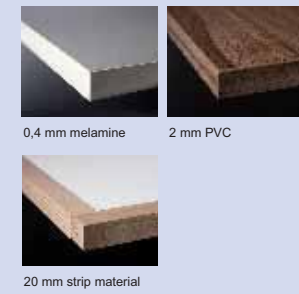

Ambition 2270

Edge banding with many variations

Ambition 2270 enables gluing, precise snipping and finishing of edges, as well as corner rounding. The finishing unit on the outfeed removes any glue residue and provides the optimum quality. Gluing solid strips of up to 20 mm does not pose any problems. You also have the option of using PU. Ambition 2270 allows you to attach a universal trimming unit. With the four-motor profile trimming unit, even veneer edges can be processed.

	Solid (mm)	Coils (mm)	Strips (mm)
a	at b=22: min. 60 at b=40: min. 105		
b	12 (opt. 8) / 40 (opt. 60)		
c	0,6 - 20	0,3 - 3,0	0,3 - 3,0
d	45 (option al 65)		
e	max. 25		

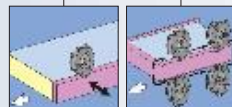
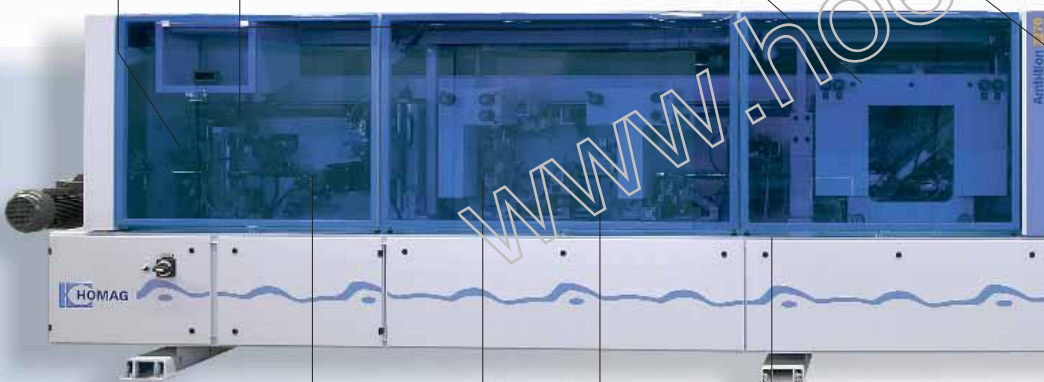
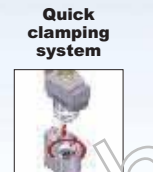
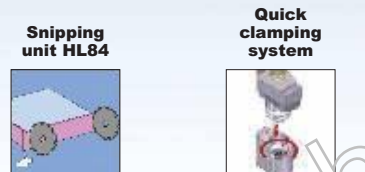
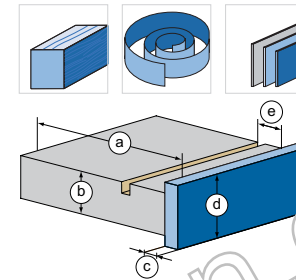

Profile trimming FF12
incl. continuous trimming

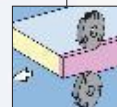

Rough trimming unit 1,5 kW

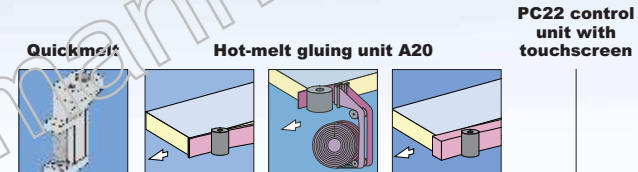

PC22 control unit with touchscreen

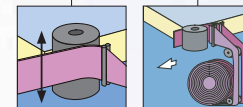

Magazine height adjustment
2 roll edge feeding

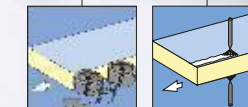

Jointing Trimming
Separating agent sprayer

Automation package No. 4011	Ambition 2270
Automatic infeed fence adjustment (Servo)	✓
Automatic pressure zone adjustment (Servo)	✓
Automatic chamfer/straight snipping motor adjustment	✓
Automatic flush/overhang snipping motor adjustment	✓
Automatic chamfer/radius adjustment for profile trimming (Servo)	✓
Pneumatic adjustment of PN10 and FA11	✓
Electronic height adjustment	✓

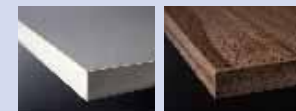

0,4 mm melamine 2 mm PVC

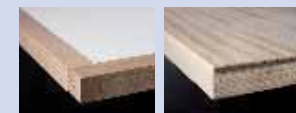

20 mm strip material Veneer

Ambition 2272

Efficiency for the highest demands

The highlight of the series is Ambition 2272. It enables gluing, precise snipping and refining of edges, as well as corner rounding. The finishing unit on the outfeed removes any glue residue and provides the optimum quality. Gluing solid strips of up to 20 mm does not pose any problems. You also have the option of using PU. Even in its basic version, Ambition 2272 enables automatic switching between different profiles, e.g. 2 mm radius and 3 mm radius.



	Solid (mm)	Coils (mm)	Strips (mm)
a	at b = 22: min. 60 at b = 40: min. 105		
b	12 (opt. 8) / 40 (opt. 60)		
c	0,6 - 20	0,3 - 3,0	0,3 - 3,0
d	45 (option at 65)		

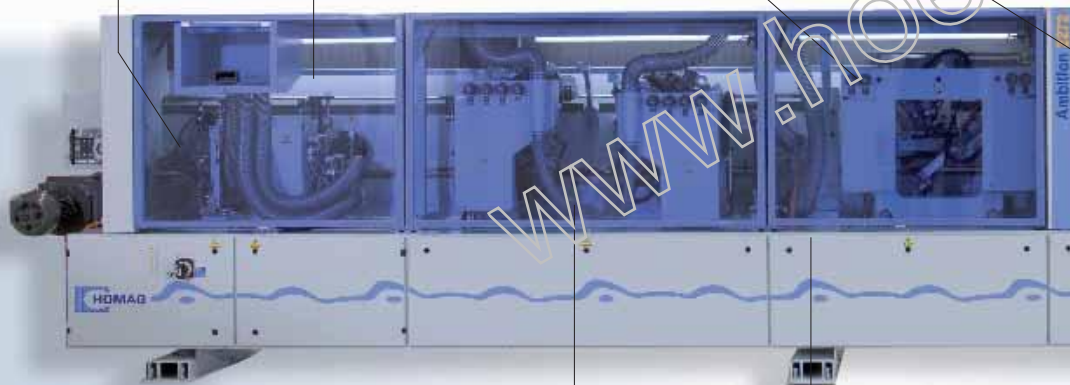
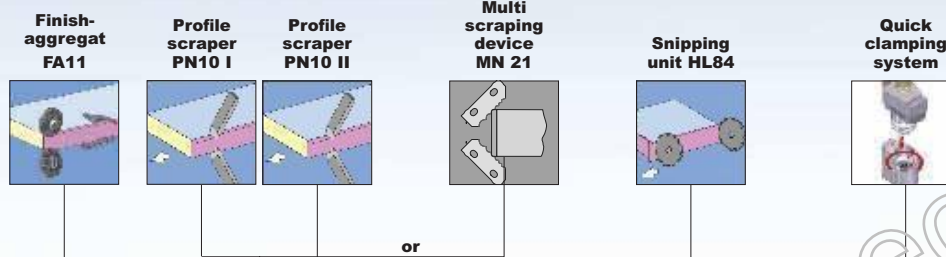
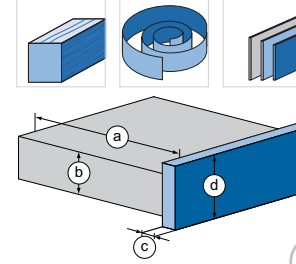

I-System + HSK interface

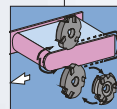

Profile trimming unit FK13

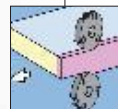

Rough trimming unit 1,5 kW

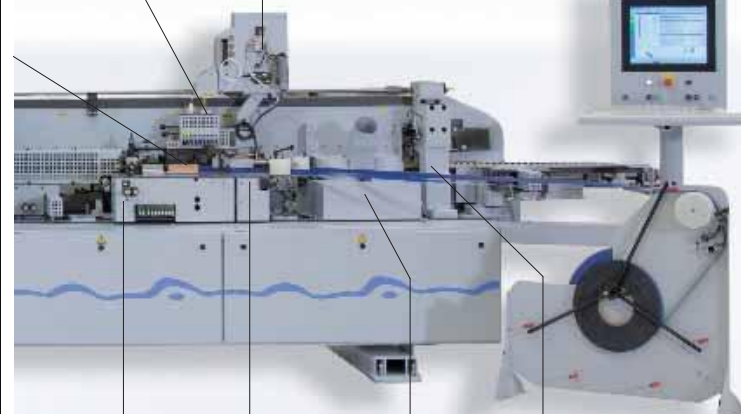
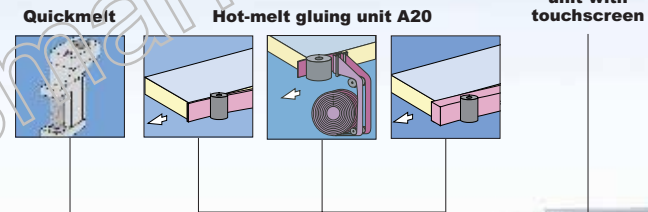

PC22 control unit with touchscreen

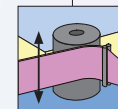

Magazine height adjustment

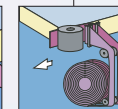

2 roll edge feeding



Jointing Trimming

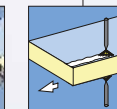

Separating agent sprayer

Automation package no. 4015	Ambition 2272
Automatic infeed fence adjustment (Servo)	✓
Automatic pressure zone adjustment (Servo)	✓
Automatic chamfer/straight snipping motor adjustment	standard
Automatic flush/overhang snipping motor adjustment	standard
Automatic chamfer/radius adjustment for profile trimming (Servo)	✓
Multi scraping device MN21 (Servo)	✓
Pneumatic adjustment of PN10 and FA11	✓
Electronic height adjustment	✓



0,4 mm melamine



2 mm PVC



20 mm strip material

Gluing units

4 variations for optimum edge quality

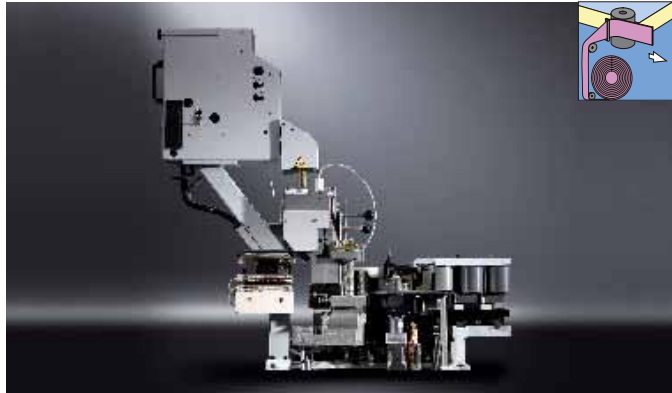

Hot-melt gluing unit A1

For processing coil edging materials from 0,3 - 1 mm

Hot-melt gluing unit A3

For processing coil edging materials from 0,3 - 3 mm

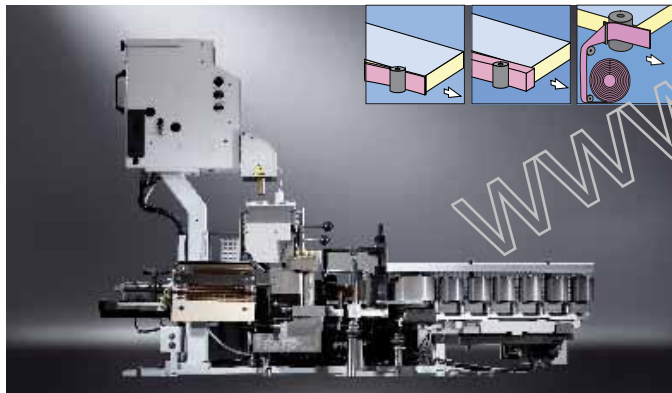

Hot-melt gluing unit A6

Zur Verarbeitung von
Für processing coil edging materials from 0,3 - 3 mm and solid wood strips up to 6 mm

Hot-melt gluing unit A20 (option : 2 roll edge feeding)

For processing coil edging materials from 0,3 - 3 mm and solid wood strips up to 20 mm

Your advantages at a glance:

- Optimum glue application on narrow surfaces.
- Changes to the workpiece thickness do not require resetting of the glue application roller.
- Magazine with 2 rollers for quick and easy edge changes, even with single edge infeed
- Gluing roller lift-off in case of feed stop, to prevent wastage
- Easily accessible granulate container with glue level control
- Pre-melting unit for melting hot-melt glue as required — automatically or manually
- Sensor for glue level control of application unit
- Gluing roller with integrated heater guarantees a constant temperature and viscosity for all workpiece thicknesses
- Electro-pneumatic clamping of gluing roller and container prevents glue contamination on the rear edge of the workpiece
- Single drive for gluing roller and pressure roller synchronized with feed
- Guiding shoe prevents wear to application roller
- Simple removal of application unit by quick-release
- Easy access to all functions from the front. This facilitates the maintenance process, e.g. greasing
- Edge monitoring sensor prevents application of hot-melt to the workpiece. If no edge is present contamination of the pressure rollers is avoided.
- Gluing unit A6 and A20 for solid wood edges: manual height adjustment of magazine.

Equipment

in the gluing area

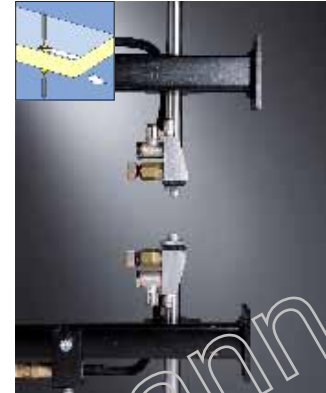

Separating agent sprayer

Prevents the adhesion of glue residue to the top and bottom of the workpiece.

- Better workpiece quality

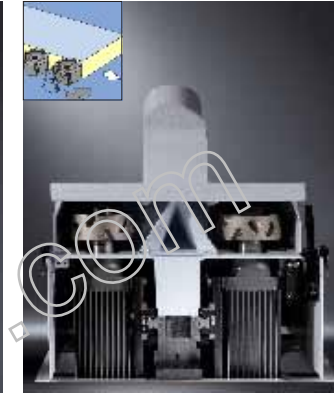

Joint trimming unit

This unit allows you to process with high precision. The tool diameter is 125 mm.

- Extremely robust unit for increased tool life
- Splinter-free glue joints

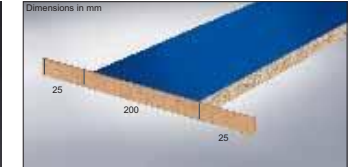

Previous gluing technology

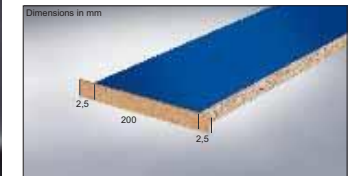

Optimized gluing technology with servo edge feed

Servo-controlled edge feeding

Edge feed with an accuracy of +/- 2 - 3 mm at the front and rear edges.



Quick clamping system

Fast, tool-free change of application unit

- Simple changing, e.g. between different hot-melt colors.
- No separate change of the container and gluing roller is required

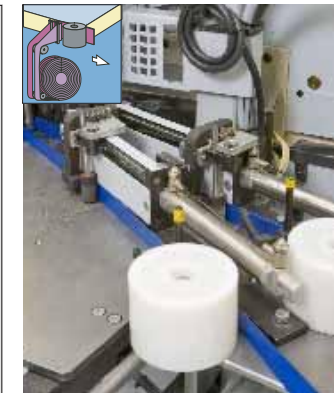

2 roll edge feeding

Automatic change of coil edging materials for fast change

- Supply and feed of 2 coils instead of 1
- Residual length monitoring

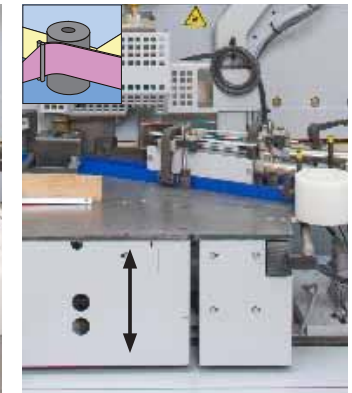

Magazine height adjustment

Edge materials of different heights can be processed with the same workpiece thickness

Solid strips are often not straight. This necessitates a magazine height adjustment when gluing

Equipment

Highest quality with HOMAG units:

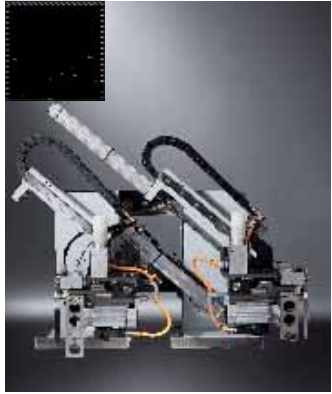

Snipping unit HL81

For accurate snipping of overhangs on the front and rear workpiece edges.

- Snipping unit with drawing stop for clean snip cuts



Snipping unit HL84

For accurate snipping of overhangs on the front and rear workpiece edges with stationary snipping stop. Ripping cut for best possible cut quality of snipping saw.

- Sensitive workpieces are not damaged
- Minimum workpiece gap = 400 mm

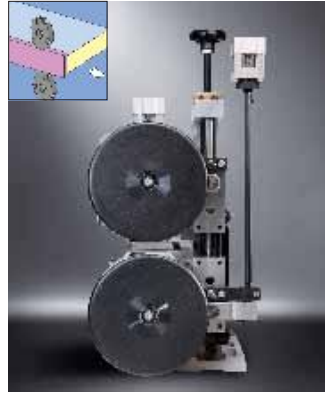

Rough trimming unit 0,55 or 1,5 kW

For pre-trimming of upper and lower edge overhangs.

- Equipped solely with I-tools.
- High processing quality
- Long tool life
- HSK interface

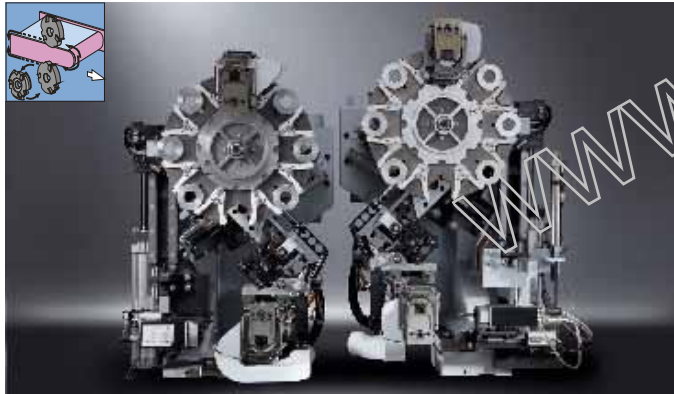

Profile trimming unit FK13

For processing edge overhangs as well as trimming front and rear edges. With 8-fold tool changer.

- Automatic change between 8 profiles
- HSK interface



Changing device FK

Standard equipment for all Ambition with FK.

Snipping and Trimming



Fine trimming unit 0.4 kW

For trimming chamfers or radii with manual adjustment.

- Equipped solely with I-tools.
- High processing quality
- Long tool life
- HSK interface



Profile trimming unit FK11

For rounding front and rear workpiece edges at the top and bottom. With manual or automatic adjustment of lateral tracing for trimming without tool change.

- Quick manual changeover of different profiles
- HSK interface



Profile trimming unit FF12

For rounding front and rear workpiece edges at the top and bottom. With manual or automatic adjustment of lateral tracing for trimming without tool change.

- HSK interface

Ambition 2270:

- incl. continuous trimming
- Moving out of working position FF12 for solid strips



Changing device for FF12

Standard equipment for all Ambition with FF12

Equipment

Perfect finishing and grooving

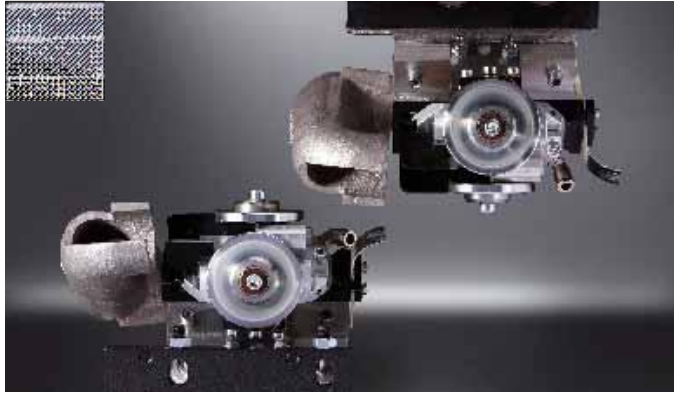

Profile scraper PN10

Smooth trimmed edges for a perfect visual appearance.

- Quick manual changeover of different profiles



Top and bottom buffing unit

Provides optimum quality

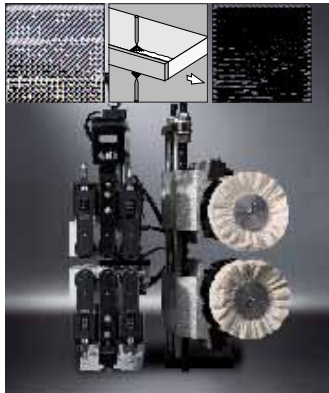

Finish unit FA11

Consisting of a glue joint scraper and buffing unit for glue residue removal on PVC edges; option al cleaning agent application

- Does away with post-processing



Free space for UF10 or FA10

3-way coil tracing for panels with transversal grooves

- Universal trimming unit UF10

For grooving, rebate trimming and profiling

- Finish unit FA10

Consisting of a glue joint scraper for glue residue removal on top and bottom of PVC edges

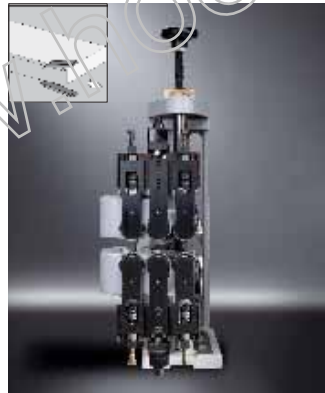

Additional equipment on demand

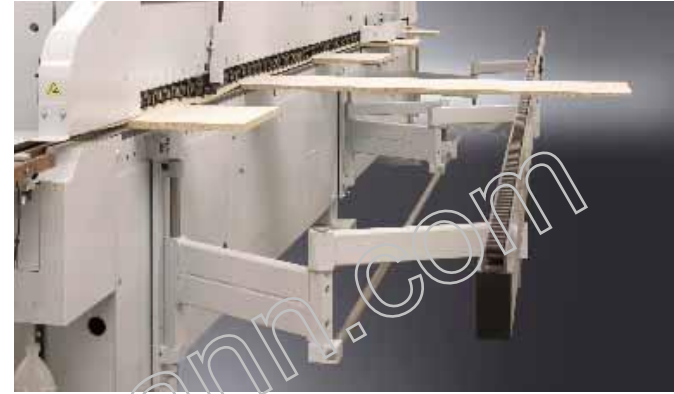

Panel support scissor-type execution

The scissor-type support can be fitted instead of the standard workpiece support. This enables a great reduction of the machine's space requirements when not processing large workpieces. Provides more space around machine when not in use.

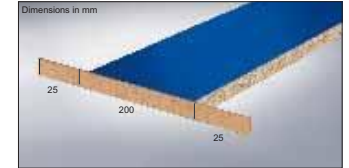

Previous gluing technology

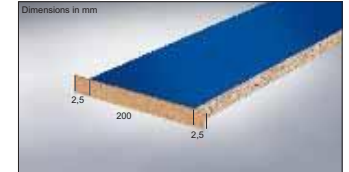

Optimized gluing technology with servo edge feed

Servo-controlled edge feeding

Edge feed with an accuracy of +/- 2 - 3 mm. at the front and rear edges.



QA glue roller front part for exchange

For quick changes between different hot-melt types

QA glue roller front part for exchange for PU

Teflon-coated



PU melting unit

For melting of 2 kg PU drums

- Melting capacity 6 kg/h

- No nitrogen gassing required



Horizontal roller plate

Faster handling of Coil edging materials

Additional equipment on demand



Application of detergent

Spraying unit for applying cleaning agent to top and bottom of workpiece.

Mounted in front of the buffing unit.



Universal trimming unit UF10

For grooving, rebate trimming and profiling.



Changing device for FK

Quick, precise changeover of trimming heads for FK

Side tracer possibilities:

- Not adjustable
- Manually adjustable
- Automatically adjustable



Workpiece guide for FK device

Additional clamping rollers for processing short workpiece lengths from 120–240 mm



Changing device for FF12

For changing the entire block (tool with motor and motor bracket) instead of the tool.

Options:

- Manually adjustable
- Automatically adjustable



I-System DIA-radius/chamfer cutter 15° R = 1,5 - 3

for FF12:
Z = 6 or Z = 4

I-System DIA-radius/chamfer cutter Satz 15° R = 1,5 - 3

for FK
Z = 4



Quickchanging device PN10

Fast profile changes without adjustment

Options:

- R = 1,5 mm (4524)
- R = 2 mm (4525)
- R = 2,5 mm (4526)
- R = 3 mm (4527)



Remote control

During setting, the feed can be started while the operator is at the processing unit.

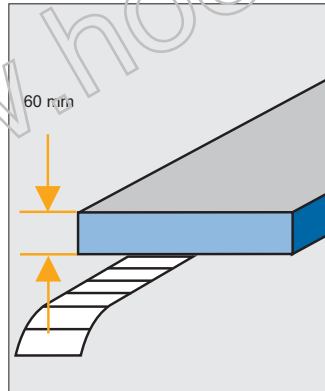

Increase of workpiece thickness up to 60 mm

with jointing trimming:

- I-DIA joint trimming 63 mm
- Raising of units

without jointing trimming (Ambition 2220)

- Raising of units

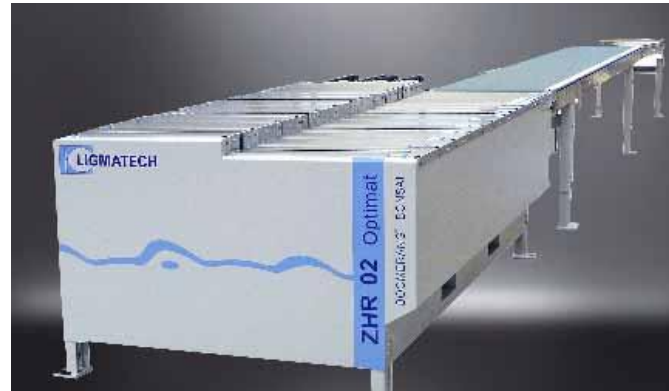

Pre-installation of LIGMATECH Boomerang return for

Models:

- ZHR 01 (0890)
- ZHR 02 (0891)
- ZHR 05 (0893)



Increased cooling capacity > 40°C

Increased cooling capacity for ambient temperatures above 40°C to protect electronics. Ensures safe, problem-free production even in extreme climatic conditions

Automation packages

Automation on demand

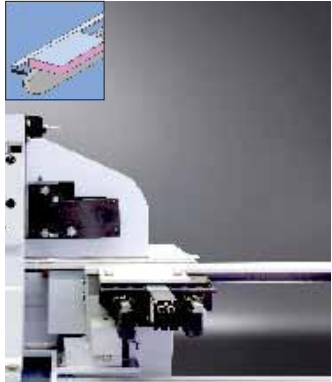

Automatic infeed fence adjustment

Precise, program-controlled adjustment when jointing, with repeated accuracy

Adjustment via servo-axis

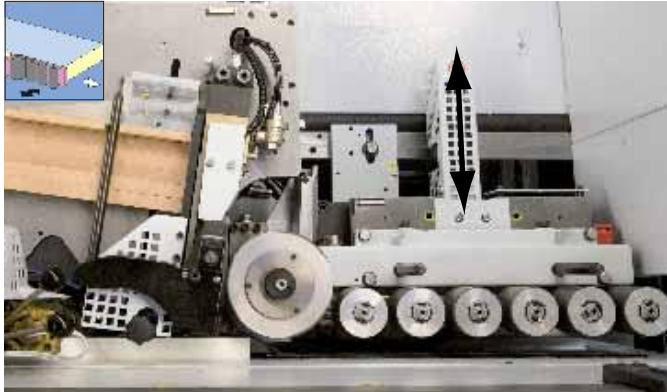

Automatic pressurezone adjustment

Program-controlled adjustment to relevant edge thickness via servo-axis

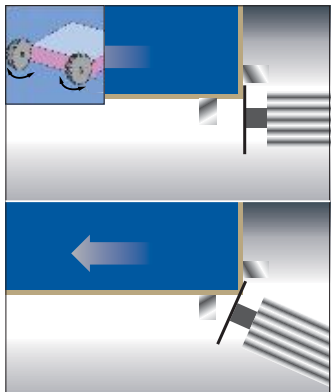

Programmable chamfer/straight adjustment of snapping motor

For quick changes between straight snipping and chamfer snipping.

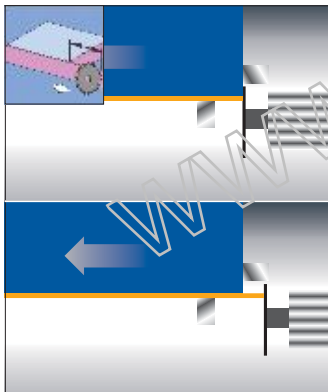

Programmable flush/overhang adjustment of snapping motor

For quick changes between flush snipping (e.g. of solid strips or shelves) and snipping with overhang (e.g. for copy-milling with profile trimming unit)

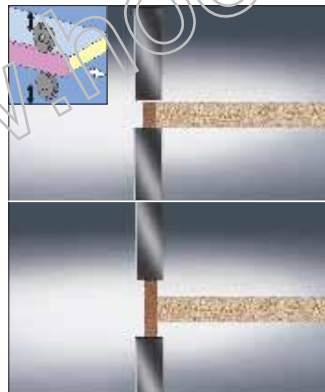

Automatic flush/overhang adjustment of rough trimming unit

For automatic switching from flush trimming to trimming with edge upstand.

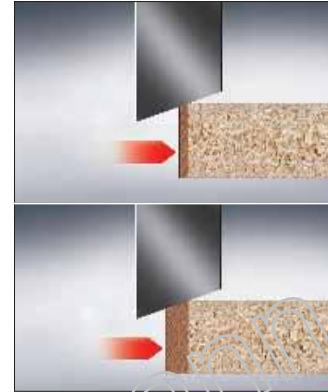

Automatic chamfer or chamfer/radius adjustment

Fine trimming

Adjustment via servo-axis

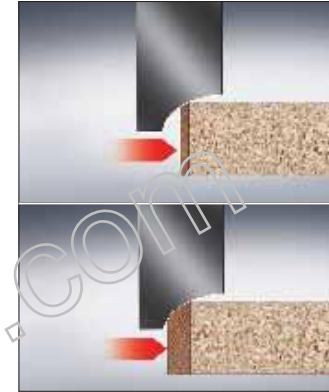

Automatic chamfer/radius adjustment

Profile trimming FF12, FK11 und FK13

Adjustment via servo-axis

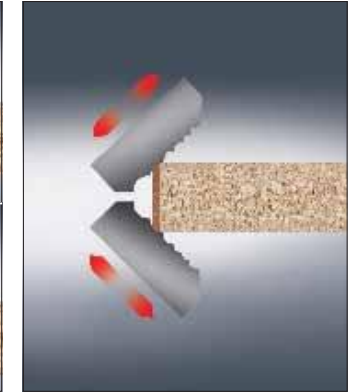

Multi scraping device MN21

Change between different profiles, e.g. chamfer 20°, R2 and R3

- Servo-axes for program-controlled horizontal and vertical adjustment
- Tracing of workpieces from above or side for precise profiling of edge

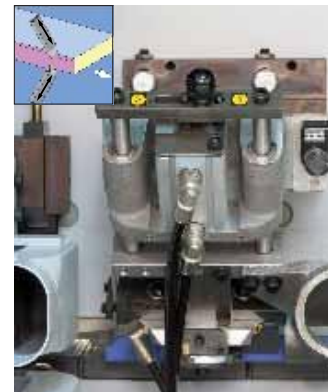

Pneumatic adjustment for PN10/FA11

Automatic engaging and disengaging from work area

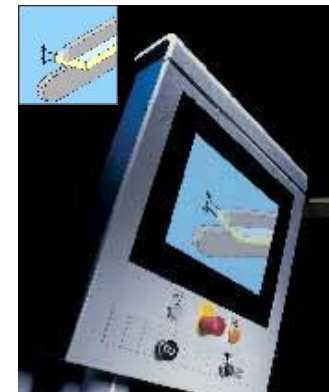

Electronic height adjustment

Automatic height adjustment of the top pressure element in the case of changes to the workpiece thickness via the program

Your advantages at a glance:

- Precise program-controlled adjustment with repeated accuracy
- Faster resetting
- Higher productivity
- All axis adjustments are made by servo motor

Ambition

Technical data

Ambition 2220

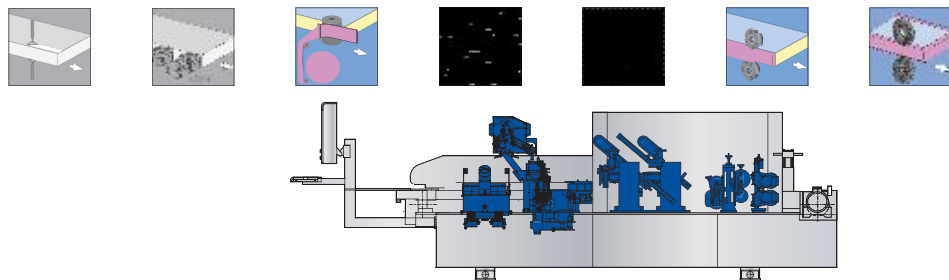

Ambition 2240

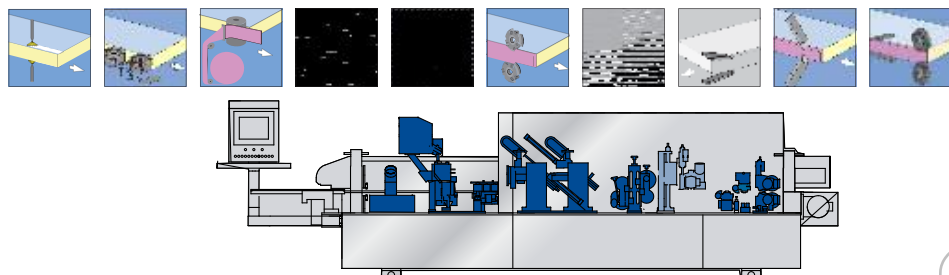

Ambition 2250

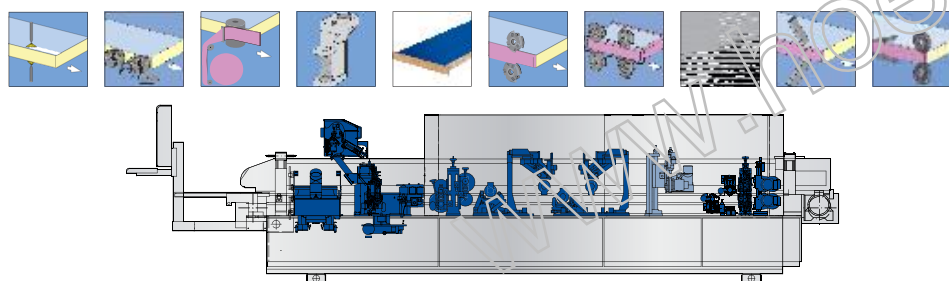

Ambition 2260

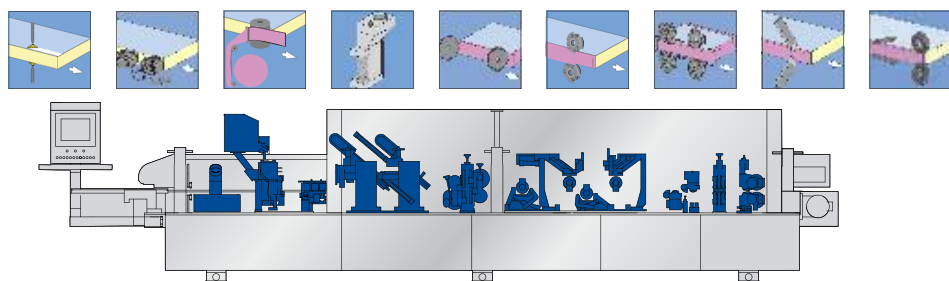

	Ambition 2220	Ambition 2240	Ambition 2250	Ambition 2260
Machine dimensions				
Total length (mm)	5.130	6.130	6.880	7.755
Total width open/closed (mm)	910/1.540			
Total height open/closed (mm)	1.820/2.250			
Working height (mm)	950			
Working dimensions				
Workpiece width (mm) for workpiece thickness 12–22 mm	min. 60			
Workpiece width (mm) for workpiece thickness 23–40 mm	min.105			
Workpiece thickness (mm)	min.12 - 40 (opt. 8 - 60)			
Edge thickness coils (mm)	0,3 - 1			0,3 - 3
Strip edge thickness (mm)	-			
Fixed workpiece overhang (mm)	30			
Edge cross section (mm)	max. 3,0 x 45 / 1,0 x 65			
Miscellaneous				
Feed adjustable (m/min.)	18-25		18-25 (opt. 32)	18-25
Connected load (kW)	19	26	28	24
Extraction connection Ø (mm)	120			
Approx. total Extraction capacity (m³/h)	2.280	4.210	7.040	6.250
Approx. total Extraction capacity (m³/h) without universal trimming	3.430		6.250	
Approx. pressure loss (Pa)	2.500			
Approx. compressed air consumption (Nl/min)	315	585	720	630
Electrical system (standard)	400 V - 3Ph - 50/60 Hz			
Pneumatic pressure (bar)	7 - 8			

Technical data and photos are not binding in every detail.
We reserve the express right to make changes in the interests of further development.

Ambition

Technical data

Ambition 2262

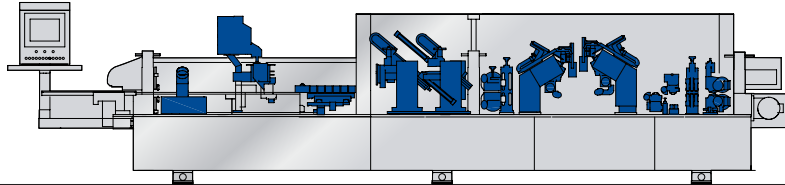
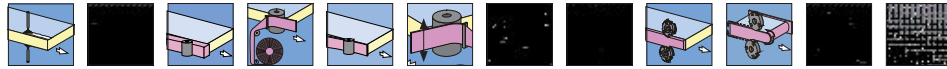

Ambition 2264

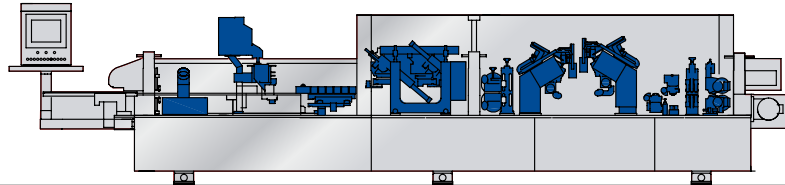
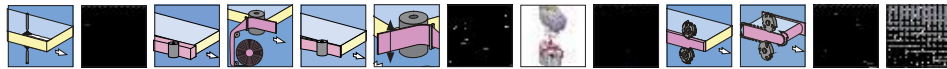

Ambition 2270

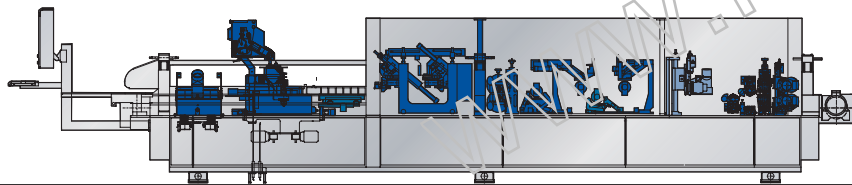
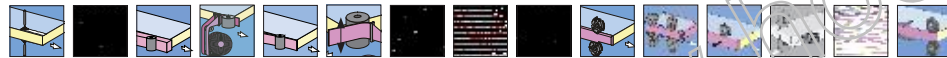

Ambition 2272

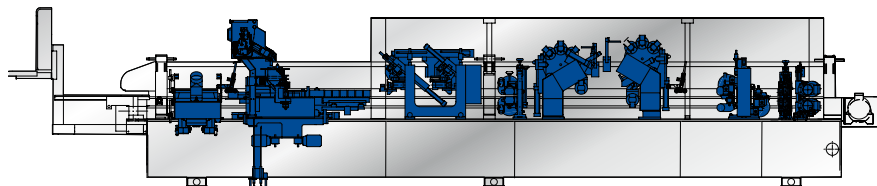

	Ambition 2262	Ambition 2264	Ambition 2270	Ambition 2272
Machine dimensions				
Total length (mm)	7.755	7.755	8.545	8.545
Total width open/closed (mm)	910/1.540			
Total height open/closed (mm)	1.820/2.250			
Working height (mm)	950			
Working dimensions				
Workpiece width (mm) for workpiece thickness 12–22 mm	min. 60 abhängig von Werkstücklänge			
Workpiece width (mm) for workpiece thickness 23–40 mm	min. 105 abhängig von Werkstücklänge			
Workpiece thickness (mm)	min. 12 - 40 (opt. 8 - 60)			
Edge thickness coils (mm)	0,3 - 3			
Strip edge thickness (mm)	0,4 - 6		0,4 - 20	
Fixed workpiece overhang (mm)	30			
Edge cross section (mm)	max. 3,0 x 45 / 1,0 x 65			
Miscellaneous				
Feed adjustable (m/min.)	18-25			
Connected load (kW)	28	28	33	30
Extraction connection Ø (mm)	120			
Approx. total Extraction capacity (m³/h)	5.250	5.250	7.040	4.070
Approx. total Extraction capacity (m³/h) without universal trimming	6.250			
Approx. pressure loss (Pa)	2.500			
Approx. compressed air consumption (Nl/min)	930	930	825	855
Electrical system (standard)	400 V - 3Ph - 50 Hz			
Pneumatic pressure (bar)	7 - 8			

Technical data and photos are not binding in every detail.
We reserve the express right to make changes in the interests of further development.

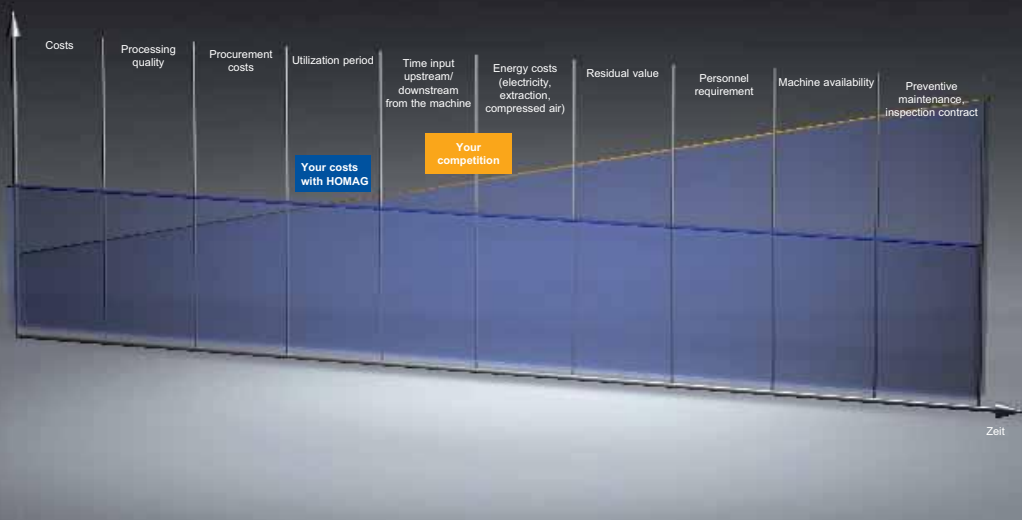

LifeCycleCost management reduces unit costs



Unit cost reduction through optimum financing

- HOMAG Finance offers optimized financing concepts on the basis of economic requirements. The high value retention of HOMAG machines offers advantages in leasing and future replacement investments

High processing quality "without" post-processing

- Perfectly adapted machine configuration

Reduction of unit labor costs

- Quick and easy operation of machines
- Simple setup procedures

High machine availability

- Worldwide, 24/7 service reduces downtimes
- TeleServiceNet — our "eye" on the

machines avoids the need for on-site visits from service technicians

- woodScout diagnostic software — intelligent self-help for all machine operators

Low energy costs*

- Intelligent standby mode reduces energy costs during breaks by up to 90%.

- Using valve control, the extraction volume flow is switched to the active processing units, thus reducing extraction costs by up to 20%.

- I-System tools reduce the extraction speed required for each individual I-tool. Power consumption is thus reduced by approx. 1250 kWh per machine. This does not include the savings resulting from non-extracted air (heating/air-conditioning).

- In the case of PC22 control, the switch cabinet is cooled by rear cooling plates/ribs without powered fans. This passive cooling does not use any energy. No filters need to be replaced. Maintenance costs are reduced. In addition, the system remains closed. No dust can get inside.

Machine service life

- With continuous functional enhancements your machine is completely future-proof

- The HOMAG retrofitting department offers solutions to suit all needs, thus ensuring long-term investment security

Preventive maintenance

- Regular inspections and preventative maintenance avoid faults and increase service life

- MDE software informs the machine operator of necessary maintenance and provides a high level of cost transparency

* Depending on configuration, operating times and workpiece spectrum.



Standard	2220	2240	2250	2260	2262	2264	2270	2272
Coil edging materials up to	1 mm	3 mm	3 mm	3 mm	3 mm	3 mm	3 mm	3 mm
Veneer	✓	✓	✓	✓	✓	✓	✓	✓
Strips up to	-	-	-	-	6 mm	20 mm	20 mm	20 mm
Feed 18 - 25 m/min.	✓	✓	✓	✓	✓	✓	✓	✓
Separating agent sprayer	option 1333	✓	✓	✓	✓	✓	✓	✓
Joining cutters incl. I-DIA-cutters 43 mm high	✓	✓	✓	✓	✓	✓	✓	✓
Servo-controlled edge feeding	option 2481	option 2481	✓	option 2481	option 2481	option 2481	option 2481	option 2481
Quickmelt unit with granulate container	✓	✓	✓	✓	✓	✓	✓	✓
Quick clamping system for glue application unit	-	-	-	-	-	✓	✓	✓
2 roll edge feeding	-	-	-	-	-	-	✓	✓
Magazine height adjustment	-	-	-	✓	✓	✓	✓	✓
Snipping unit HL81 with drawing snipping stop	✓	✓	-	-	✓	-	-	-
Snipping unit HL84 with upright snipping stop	-	-	-	-	-	-	✓	✓
Rough trimming unit	-	-	-	-	0,55 kW	1,5 kW	1,5 kW	1,5 kW
Fine trimming unit 0.4 kW manual adjustment chamfer/radius	✓	✓	✓	✓	-	-	-	-
Profile trimming unit FK11 manual adjustment chamfer/radius	-	-	-	-	✓	✓	-	-
Profile trimming unit FK13 automatic 8-fold changer	-	-	-	-	-	-	✓	✓
Profile trimming unit FF12 manual adjustment chamfer/radius	-	-	-	-	-	-	✓	-
Moving out of working position FF12 for solid strips	-	-	-	-	-	-	✓	-
Free space for universal trimming unit UF10 for grooving	-	option 3403	option 3403	-	-	-	option 3403	-
Scraping device PN10	✓	✓	✓	✓	✓	✓	✓	2x
Finish unit FA11 (FA10 + Buffing unit)	-	option FA10	✓	✓	✓	✓	✓	✓
Buffing unit	✓	-	-	-	-	-	-	-
Control PC22 with Touchscreen panel	✓	✓	✓	✓	✓	✓	✓	✓
Automation package	2220	2240	2250	2260	2262	2264	2270	2272
package no.	4009	4014	4010	4012	4016	4017	4013	4015
Automatic infeed fence adjustment (Servo)	-	-	-	-	-	✓	✓	✓
Automatic pressure zone adjustment (Servo)	-	✓	✓	✓	✓	✓	✓	✓
Automatic snipping motor adjustment (chamfer/radius)	✓	✓	-	-	-	✓	✓	standard
Automatic snipping motor adjustment (flush/overhang)	-	-	-	-	-	✓	✓	standard
Automatic adjustment of rough trimming unit (flush/overhang)	-	-	-	-	✓	✓	✓	✓
Automatic adjustment fine trimming (Servo)	chamfer	chamfer/radius	chamfer/radius	chamfer/radius	-	-	-	-
Automatic chamfer/radius adjustment profile trimming (Servo)	-	-	-	✓	-	✓	✓	✓
Multi scraping device MN21 (Servo)	-	-	-	-	-	-	-	-
Pneumatic adjustment PN10 + FA11	-	✓	✓	✓	✓	✓	✓	✓
Electronic height adjustment	✓	✓	✓	✓	✓	✓	✓	✓
Additional options	2220	2240	2250	2260	2262	2264	2270	2272
Feed speed increase up to max. 32 m/min.	-	✓	✓	-	-	-	-	-
Panel support scissor-type execution	0642	0644	0645	0646	0646	0646	0647	0647
Servo-controlled edge feeding	✓	✓	standard	✓	✓	✓	✓	✓
QA glue roller front part for exchange	-	-	-	-	✓	✓	✓	✓
QA glue roller front part for exchange (tefloncoated for PU)	-	-	-	-	✓	✓	✓	✓
PU-melting unit	-	-	-	-	✓	✓	✓	✓
Horizontal roller plate	✓	✓	✓	✓	✓	✓	✓	✓
Application of detergent	✓	✓	✓	✓	✓	✓	✓	✓
Changing device for trimming unit	✓	✓	✓	✓	-	-	-	-
Universal trimming unit UF10 with suction hood	-	✓	✓	-	-	-	✓	-
Set of change heads for FK fixed	-	-	-	-	✓	✓	-	-
Set of change heads for FK manual adjustment	-	-	-	-	✓	✓	-	-
Set of change heads for FK automatic adjustment	-	-	-	-	✓	✓	-	✓
Workpiece guide for FK	-	-	-	-	✓	✓	-	✓
Changing device for FF12 manual adjustment	-	-	✓	✓	-	-	✓	-
Changing device for FF12 automatic adjustment	-	-	✓	✓	-	-	✓	-
I-System radius/chamfer cutter 15° 1,5-3 mm Z = 6	-	✓	✓	-	-	-	-	-
I-System radius/chamfer cutter 15° 1,5-3 mm Z = 4	-	-	-	-	-	-	✓	-
Set of radius/chamfer cutter (FK) 15° 1,5-3 mm Z = 4	-	-	-	-	✓	✓	-	✓
Quick changing device R = 1,5 / 2 / 2,5 / 3 mm	-	✓	✓	✓	✓	✓	✓	✓
Preinstallation Boomerang	✓	✓	✓	✓	✓	✓	✓	✓
Overvoltage protection	✓	✓	✓	✓	✓	✓	✓	✓
Transformer for voltage adaption	✓	✓	✓	✓	✓	✓	✓	✓
Increase of cooling capacity >40°C	✓	✓	✓	✓	✓	✓	✓	✓
Remote control hand switch for single sided machines	✓	✓	✓	✓	✓	✓	✓	✓
TeleServiceNet	✓	✓	✓	✓	✓	✓	✓	✓
Software woodScout	✓	✓	✓	✓	✓	✓	✓	✓
Additional hard disc	✓	✓	✓	✓	✓	✓	✓	✓
Increase of workpiece thickness 60 mm with jointing trim.	0841	0841	0840	0840	0841	0841	0840	0841
Increase of workpiece thickness 60 mm without jointing trim.	✓	-	-	-	-	-	-	-
Package jointing trimming	✓	standard	standard	standard	Standard	standard	standard	standard