

The strapping machine for folded boxes and wide products

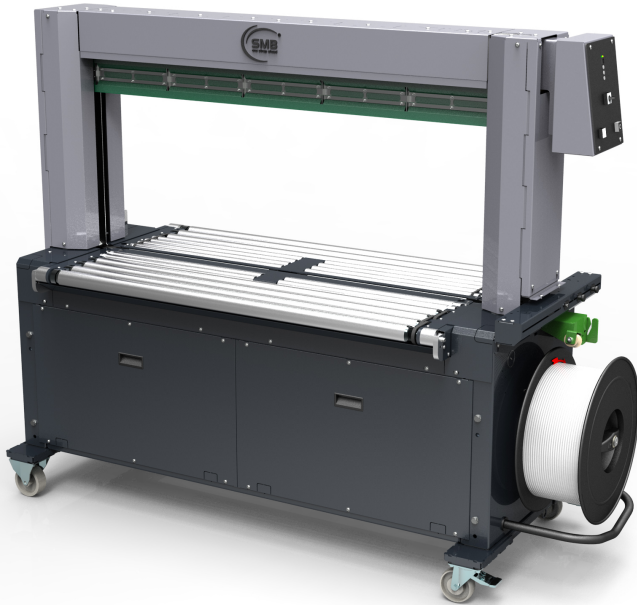

- Robust and extremely low maintenance
- 5 - 12 mm strap
- Optimal strap guide at the strapping level
- **Best cost / benefit ratio**

EQUIPMENT:

- ASLF 'Anti-Strap-Loss-Function' Constant strap control
- Automatic Strap feed
- Strap width 5 - 12 mm, either
- DAT 'Direct-Access-Technology'
- The exclusive eject function avoids strap jam
- Torque controlled strap tension, adjustable
- Upstream and downstream interlocks
- Conveyor speed steplessly adjustable
- GreenTech energy concept, low power consumption
- Intuitive operator interface
- MFT 'Mono-Frame-Technology'
- Bundle stops, optional
- Bundle press, optional
- SAO 'Safe and Open' - Safe without protection doors
- Table height steplessly adjustable
- Bundle flow control
- Wear-free, energy saving direct-drive-motors
- Low maintenance and low wear strap arch
- **Many specific options available, easily configurable**

SMB CUBE-C

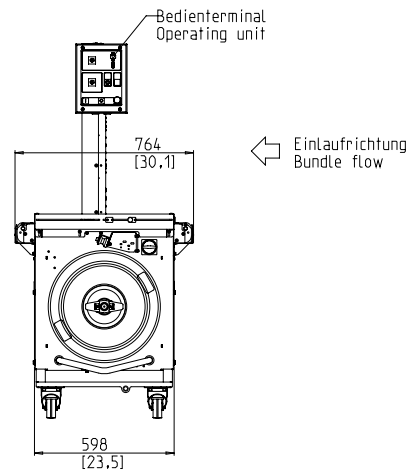
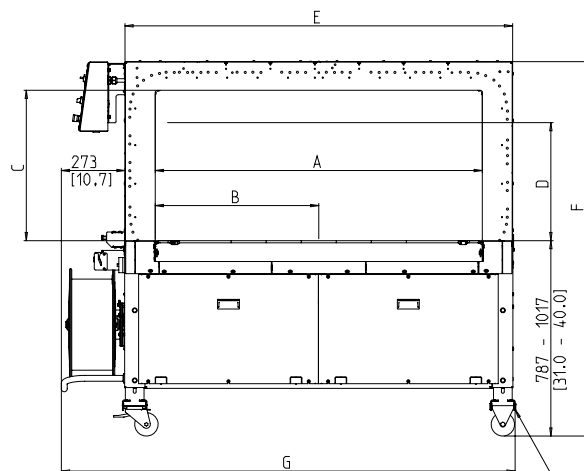

Stromanschluss / power connection
Option: Pneumatikanschluss / pneumatic connection

Maße in mm [inch]
Dimensions in mm [inch]

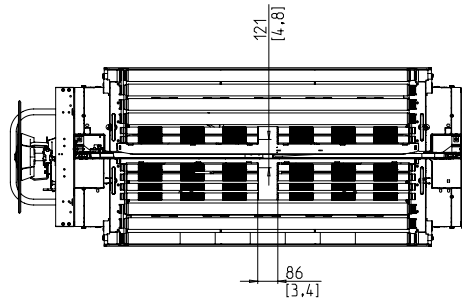

Arch Size WxH	1250x400	1250x600	1250x800	1250x1250	1650x600
Sealing head centered	X	X	X	X	X
Order number	x48083	x46000	x51794	x51866	x47515
Total length + Coil	G 1947	1947	1947	1947	2347
Total height	F 1355-1585	1555-1785	1555-1785	2005-2235	1555-1785
Position sealing head	B 700	700	700	700	900
Inner width (arch)	A 1400	1400	1400	1400	1800
Arch width	E 1709	1709	1709	1709	2109
Inner height (with press)	D 305	505	705	655-1155	505
Inner height (arch)	C 440	640	840	1290	640
Weight in kg	345	350	355	370	400

TECHNICAL SPECIFICATION:

CAPACITY:

Single strap, bundles/minute up to: max. 32
At table belt speed in m/s: 0,8
Based on bundle size l x w in mm: 300 x 210
Depending on arch size and tension force

BUNDLES:

Width in mm
Min.: 100
Max. bundle width depending on arch size
Length in mm: min. 150
Height in mm
Min.: 10
Max. bundle height depending on arch size
Weight in kg: max. 50

TRANSPORT SPEED:

m/s: 0,20 - 1,00

STRAP TENSION:

Adjustable with 10 steps
Automatic strap tensioning
Tension at bundle in N: max. 325

STRAPPING MATERIAL:

Polypropylene DIN EN 13 394
Width in mm: 5 - 12
Thickness in mm: 0,4 - 0,65

SEALING METHOD:

Heat seal. Tensile strength of welded joint is approx. 80% of the breaking strength of the strap

STRAP COIL:

Core ID in mm: 200
Core OD in mm: 420
Width in mm: 190 (160,180,200)

POWER SUPPLY:

Wide Range Input 100-240V, 1AC; 47-63 Hz
Wide Range Input 380-520V, 3AC; 47 63 Hz: optional
Maximum fusing 16A (B-character)
Protection Type: IP 22

POWER CONSUMPTION:

Power consumption in kW approx.: 0,30

OPERATING CONDITIONS:

Temperature range in °C [°F]: +5 [41] - +45 [113]



A SIGNODE BRAND

Signode Packaging Systems GmbH

Markgrafenstraße 2 | D-95497 Goldkronach | Germany
Tel.: +49 (0) 9273 / 982-201 | Fax.: +49 (0) 9273 / 982-100
www.smb.biz | sales@smb.biz

