



COMBINATA 6 OPERAZIONI
6 OPERATIONS COMBINED MACHINE
6 - FACH KOMBIMASCHINE
COMBINEE 6 OPERATIONS
COMBINADA 6 OPERACIONES



| DATI TECNICI | TECHNICAL DATA | TECHNISCHE DATEN | DONNES TECHNIQUES | DATOS TECNICOS | |
|--|--|--|--|--|--|
| PIALLA A FILO | SURFACE PLANER | ABRICHTER | DEGAUCHISSEUSE | CEPILLADORA | |
| Lunghezza piani mm Larghezza max piallabile mm Albero Ø mm Numero coltelli g/min Velocità albero HP Potenza motore HP Inclinazione guida | Length of tables mm Max planing width mm Cutterblock Ø mm Number of knives rpm Cutterblock speed HP Motor power HP Fence tilting | Tischlänge mm Abrichtbreite mm Messer-Welle Ø mm Messeranzahl U/min Wellendrehzahl PS Motorstärke PS Abrichtanschlagschwenkung | Longueur tables mm Largeur de coupe mm Arbre porte-couteaux Ø mm Nombre des couteaux t/min Vitesse rotation arbre CV Puissance moteur CV Inclinaison guide | Longitud mesas mm Ancho max de cepillado mm Eje porta-cuchillas Ø mm Cuchillas rpm Velocidad eje HP Potencia motor HP Inclinacion guja | 1850 415 • 350 95 4 • 3 5000 4 • 3 45° |
| Emissione rumore dB (A) | Noise level dB (A) | Arbeitsplatzbezogene Emissionswerte dB (A) | Pression acoustique dB (A) | Emission ruido dB (A) | 91,8 |
| PIALLA A SPESSORE | THICKNESSER | DICKENHOBEL | RABOTEUSE | REGRUESADORA | |
| Dimensioni piano mm Spessore max piallabile mm Asportazione max mm Velocità avanzamento mt/min | Table size mm Max thickening capacity mm Max depth of cut mm Feed speed mt/min | Tischgröße mm Hobelhöhe max. mm Spanabnahme max. mm Vorschubgeschwindigkeit/min | Dimensions de la table mm Hauteur de rabotage max mm Enlèvement max mm Vitesse d'avance mt/min | Mesa de trabajo mm Espesor max cepillado mm Espesor max por pasada mm Velocidad de avance mt/min | 415x630 • 350x630 230 • 220 4 7 |
| Emissione rumore dB (A) | Noise level dB (A) | Arbeitsplatzbezogene Emissionswerte dB (A) | Pression acoustique dB (A) | Emission ruido dB (A) | 90,9 |
| SEGA CIRCOLARE | CIRCULAR SAW | KREISSÄGEMASCHINE | SCIE CIRCULAIRE | SIERRA CIRCULAR | |
| Dimensioni piano Lama Ø mm Inclinazione lama mm Altezza taglio 45° mm Altezza taglio 90° mm Potenza motore HP Velocità rotazione g/min | Table size Blade Ø mm Blade tilting mm Cutting height 45° mm Cutting height 90° mm Motor power HP Speed of rotation rpm | Tischgröße Sägeblatt Ø mm Schwenkbereich Sägeblatt mm Schnitthöhe 45° mm Schnitthöhe 90° mm Motorstärke PS Drehzahl U/min | Dimensions de la table Lame Ø mm Inclinaison lame mm Hauteur de coupe à 45° mm Hauteur de coupe à 90° mm Puissance moteur CV Vitesse rotation t/min | Mesa de trabajo Hoja Ø mm Inclinacion hoja mm Altura de corte 45° mm Altura de corte 90° mm Potencia motor HP Velocidad rotacion rpm | 1100x515 300 45° 65 95 4 • 3 4000 |
| Emissione rumore dB (A) | Noise level dB (A) | Arbeitsplatzbezogene Emissionswerte dB (A) | Pression acoustique dB (A) | Emission ruido dB (A) | 89,2 |
| TOUPIE VERTICALE | SPINDLE MOULDER | FRÄSE | TOUPIE VERTICALE | TUPI VERTICAL | |
| Albero Ø mm Inclinazione albero mm Corsa verticale mm Diametro max utensile (rientrabile) mm Potenza motore HP Velocità rotazione g/min | Shaft Ø mm Shaft tilting mm Vertical stroke mm Max tool Ø (retractable) mm Motor power HP Speed of rotation rpm | Spindeldurchmesser Ø mm Spindelschwenkung mm Spindelhub mm Werkzeugdurchmesser max Ø mm Motorstärke PS Drehzahl U/min | Arbre Ø mm Inclinaison arbre mm Course verticale mm Max Ø outil (à rentrer) mm Puissance moteur CV Vitesse rotation t/min | Eje Ø mm Inclinacion eje mm Carrera vertical mm Herramienta max Ø mm Potencia motor HP Velocidad rotacion rpm | 30 -5°-0,45° 120 170 4 • 3 3500-5500-7900 |
| Emissione rumore dB (A) | Noise level dB (A) | Arbeitsplatzbezogene Emissionswerte dB (A) | Pression acoustique dB (A) | Emission ruido dB (A) | 84,4 |
| CARRELLO IN ALLUMINIO | ALUMINIUM SLIDING TABLE | ALU-SCHIEBETISCH | CHARIOT DE SCIAGE EN ALUMINIUM | CARRO DE ESCUADRAR DE ALUMINIO | |
| Dimensioni carrello mm Corsa carrello mm | Table size Table stroke mm | Tischgröße Schnitlänge mm | Dimensions de la table Course de la table mm | Dimensiones del carro Carrera del carro mm | 1500x300 • 1200x300 1600 • 1300 |
| SUPPORTO A VAGONE E PIANO LATERALE PER CARRO SCORREVOLE | TABLE SUPPORT AND SIDE-FRAME FOR SLIDING TABLE | AUFLAGEFLÄCHE U. HALTERUNG FÜR ALU-SCHIEBETISCH | CHARIOT LATERAL AVEC SUPPORT POUR TABLE ROULANTE | APOYO DE BANDERA PARA CARRO CORREDIZO | 800x550 |
| TAGLIO PARALLELO | PARALLEL CUT | SCHNITTBREITE | COUPE PARALLELE | CORTE PARALELO | 900 • 850 |
| PESO NETTO | NET WEIGHT | NETTOGEWICHT | POIDS NET | PESO NETO | 680 • 580 |
| DIMENSIONI IMBALLAGGIO Ln+Lr+A | PACKING SIZE L+W+H | VERPACKUNGSMASSE L+B+H | DIMENSIONS EMBALLAGE Ln+Lr+H | DIMENSIONES EMBALAJE L+An+Al | 1900x1500x1100 |
| (A richiesta) | (Upon request) | (Auf Wunsch) | (Sur demande) | (Sobre pedido) | |
| CAVATRICE | MORTISER | LANGLOCHBOHRER | MORTAISEUSE | TALADRO | |
| Dimensioni piano mm Corsa longitudinale mm Corsa trasversale mm Corsa verticale mm Mandrino Ø mm Peso kg | Table size Longitudinal stroke mm Transverse stroke mm Vertical stroke mm Chuck Ø mm Weight kg | Tischgröße Bohrtiefe mm Querstellung mm Höhenverstellung mm Spindel Ø mm Nettogewicht kg | Dimensions de la table Course longitudinale mm Course transversale mm Course verticale mm Mandrino Ø mm Poids kg | Mesa de trabajo Carrera longitudinal mm Carrera transversal mm Carrera vertical mm Portabrocas Ø mm Peso kg | 430x260 200 100 100 16 25 |
| CARRO SCORREVOLE | SLIDING TABLE | ALU-SCHIEBETISCH | TABLE ROULANTE | CARRO PARA ESCUADRAR | 1500-2000-2500 |
| GRUPPO INCISORE | SCORING UNIT | VORRITZAGGREGAT | GROUPE INCISEUR | GRUPO INCISOR | |
| Lama Ø mm | Blade Ø mm | Sägeblatt Ø mm | Lame Ø mm | Hoja Ø mm | 80 |



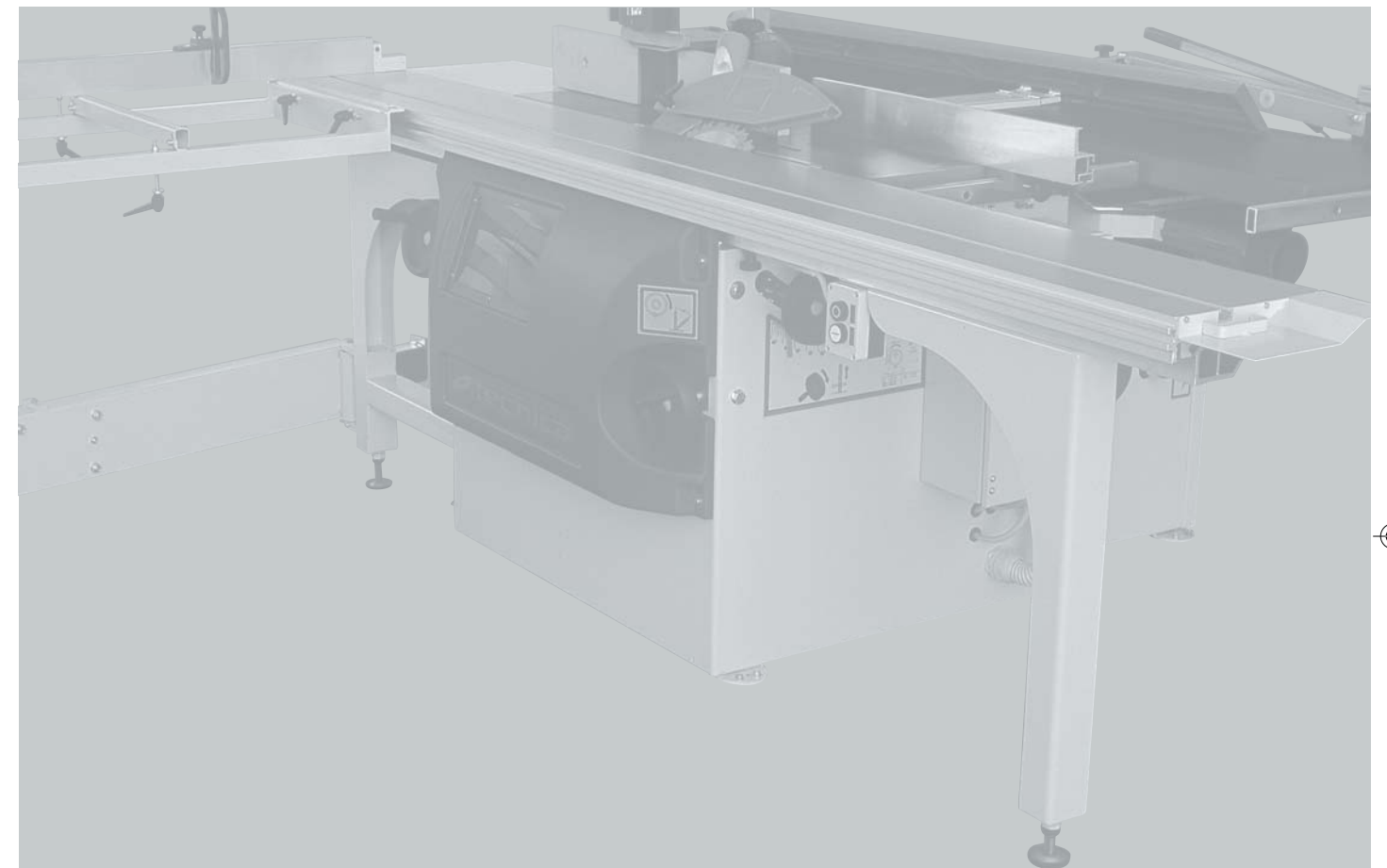

tecnica
PAOLONI GROUP



COMBINATA 6 OPERAZIONI
6 OPERATIONS COMBINED MACHINE
6 - FACH KOMBIMASCHINE
COMBINEE 6 OPERATIONS
COMBINADA 6 OPERACIONES

C 415 • C 350 SUPER



-  **DOTAZIONE STANDARD**
-  **STANDARD EQUIPMENT**
-  **STANDARDAUSRÜSTUNG**
-  **DOTATION STANDARD**
-  **EQUIPAMIENTO DE SERIE**



C 415 • C 350 SUPER



- VERSIONE
- EQUIPMENT
- AUSFÜHRUNG
- EQUIPMENT
- EQUIPAMIENTO

-  **SU RICHIESTA**
-  **UPON REQUEST**
-  **SONDERZUBEHÖR**
-  **SUR DEMANDE**
-  **SOBRE PEDIDO**



Guida per taglio pezzi corti
Angular cutting device
Gehrungsanschlag für kleine Werkstücke
Guide pour coupe de pièces courtes
Escuadra para corte de piezas pequeñas



Toupie inclinabile - 5° Ø 45° ø
Tilting spindle - 5° Ø 45° ø
Spindelschwenkung - 5° Ø 45° ø
Arbre toupie inclinable - 5° Ø 45° ø
Eje tupi inclinable - 5° Ø 45° ø

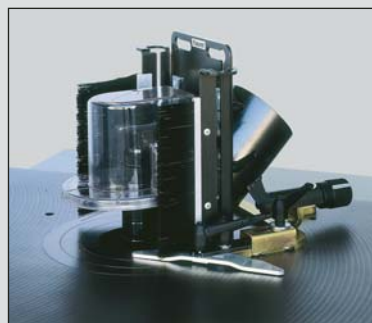

Protezione per lavorazioni all'albero
Protective hood for jobs on the spindle
Schutz für die Bearbeitung am Anlaufring
Protecteur pour travaux à l'arbre
Protector para trabajos en el eje

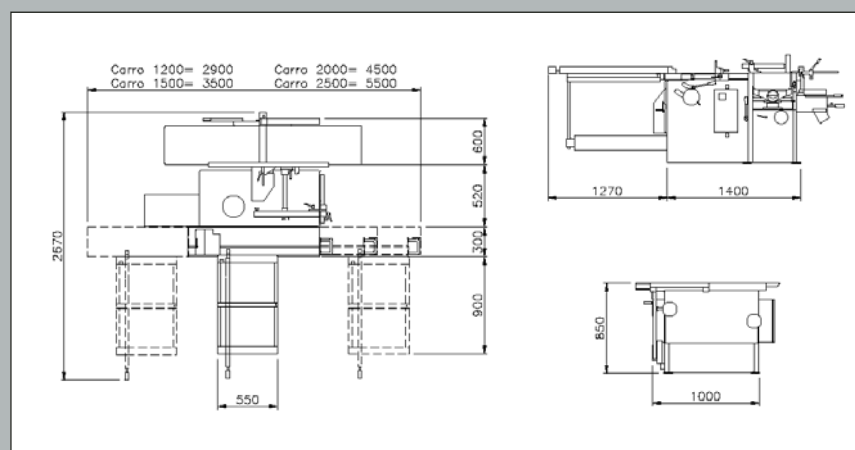
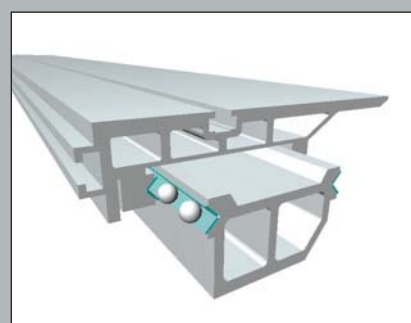

Gruppo incisore con lama ø 80 mm.
Scoring unit with blade ø 80 mm.
Vorritzaggregat kompl. mit Sägeblatt ø 80 mm.
Groupe inciseur avec lame ø 80 mm.
Grupo incisor con sierra ø 80 mm.



Cavatrice standard
Standard mortiser
Langlochbohrapparat standard
Mortaiseuse standard
Taladro standard



Cavatrice pesante in ghisa
Cast-iron mortiser
Langlochbohrapparat (Schwere Ausführung)
Mortaiseuse type fonte
Taladro pesado en fundición

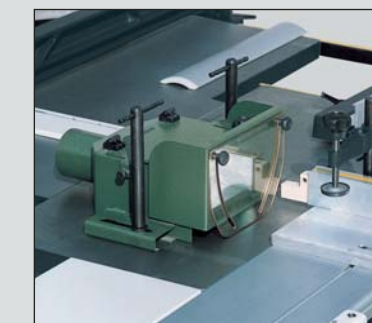

Cuffia e pianetto a tenonare
Tenoning hood and tenoning table
Zapfenschneidhaube und Zapfenschneidtisch
Capot et table à tenonner
Protector y plano para espigar