

WE ARE READY FOR THE REVOLUTION: INDUSTRY 4.0



Vitap software for BAR NESTING[®] & complete machining on all 4 workpiece edges as well as the surface

Welcome to the BAR NESTING REVOLUTION, all the nesting advantages and without limits in the execution of horizontal holes.

To go from high production to “JUST IN TIME” requires a review of the production methods, a cost reduction in order to respond to a continuing changing market.

To learn more about
[®] Vitap BAR NESTING
see the video



Why choosing new Point K2 TOP:

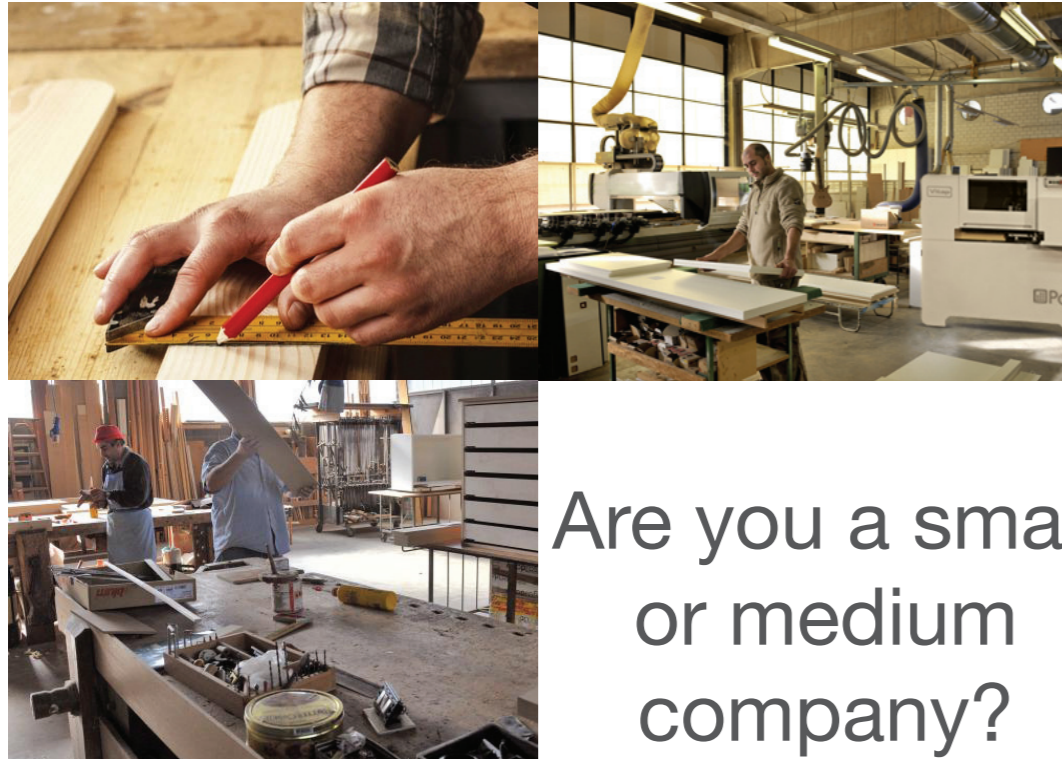

Are you a small or medium company?

The Point K2 TOP is perfect for small to medium size companies which have limited budget, availability of manufacturing and stocking space, few employees, and issues with the handling of large panels.



Are you a large company?

The Point K2 TOP has been designed and engineered for the large companies that need productive and reliable machines, without the cost and complexity of large CNC, many of which require specialized technicians which may be difficult to find and retain.

The Point K2 TOP is different from other compact CNC on the market, because most operations do not require any setup time by utilizing the unique **D-D-T (Double Dynamic Transport) ®**. This registered system consists of two clamps which continuously hold the material in place during various operations and also allows for a specialized software to optimize the work cycles – like a nesting machine but with the added advantage of being able to drill horizontal holes without having to remove the work piece for an additional operation (a major drawback in NESTING systems). As far as overall maintenance costs, the Point K2 TOP does not require a vacuum pump, saving both money and energy.

- Fast processing - **Save time**
- Take up little room - **Save space**
- Simple operation - **Save nerves**
- Great value for money - **Save money**



Point K2 TOP standard configuration

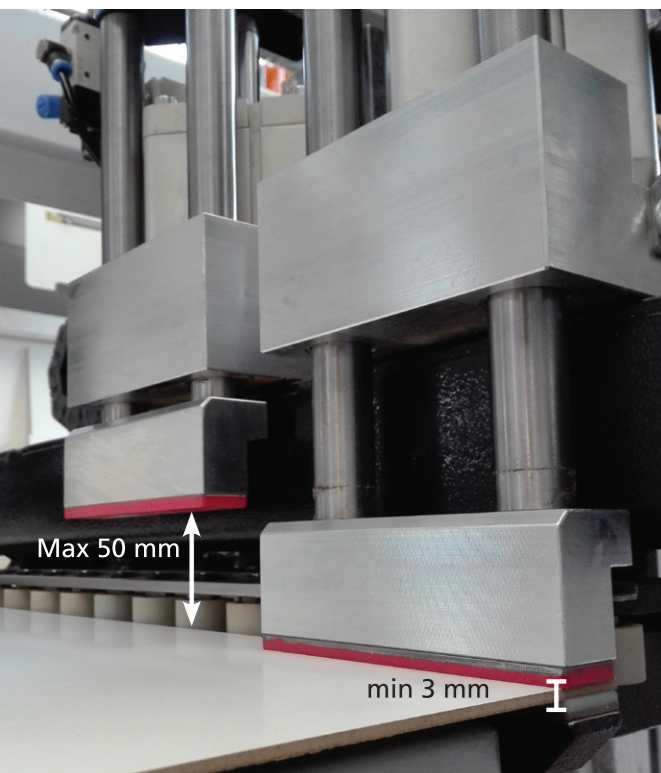

STANDARD
Patented **D-D-T** Revolutionary panel movement seamlessly by n.2 clamps "SAVE TIME"
Maximum panel locking
Panel thickness min 3 mm; Max 50 mm

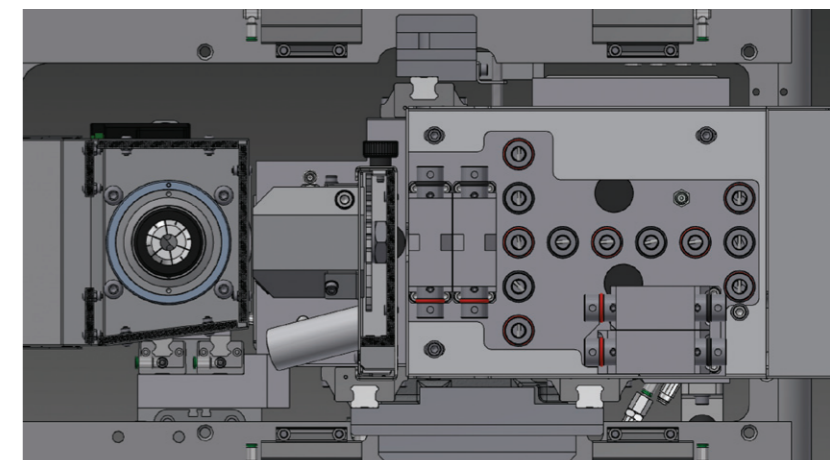

STANDARD
Independent vertical spindles n°12
Horizontal spindles on axis X (2+2)
Horizontal spindles on axis Y (2+2)
N°1 Saw blade unit for grooving
N°1 Router head 4,5 Kw (rpm 12000/24000)



STANDARD
Easy, fast and accurate introduction of the panel

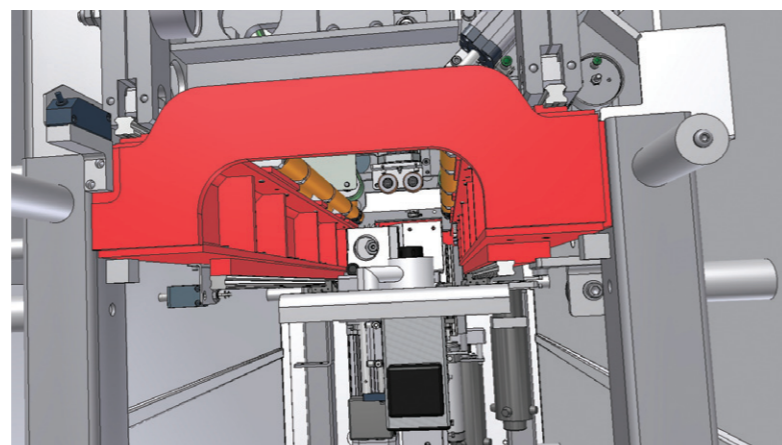

STANDARD
Reinforced frame

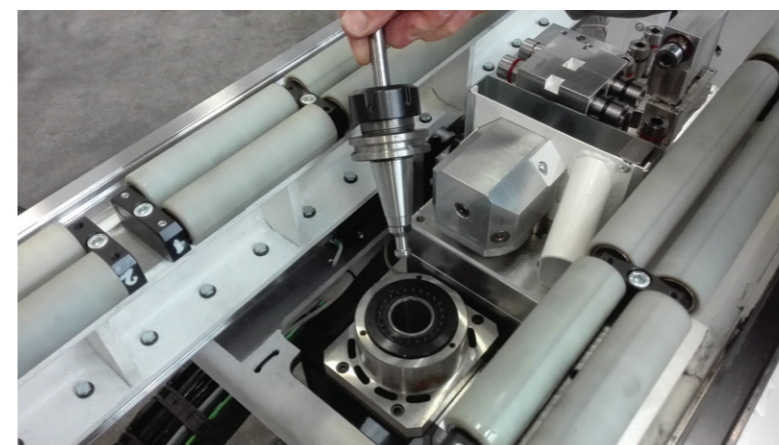

STANDARD
Electrospindle for vertical routing with ISO 30 rapid tool changer

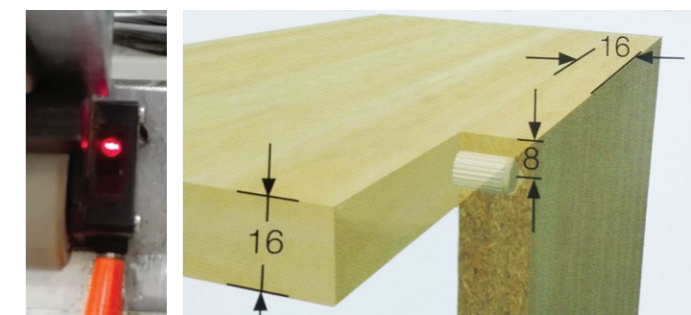

STANDARD
Equipped with laser for perfect construction of the holes

A compact CNC machine that can achieve the following functions:

Optimize panel cutting in X and Y

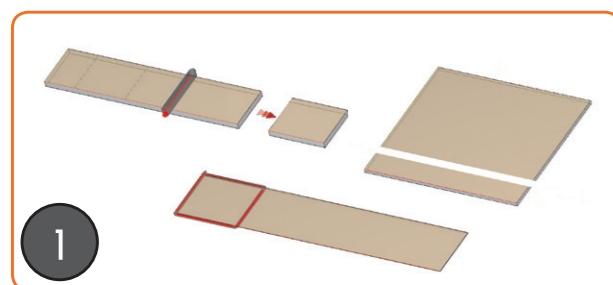

Drilling operations on 5 sides + grooving operation on X axis

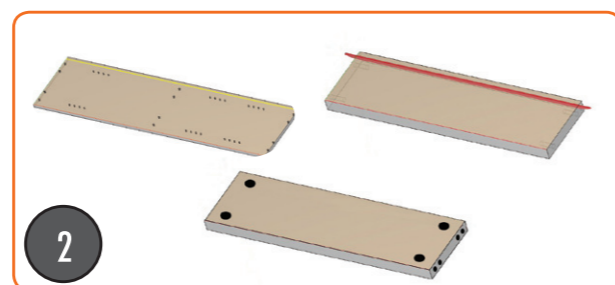

Routing operation on all 4 workpiece edges as well as the surface

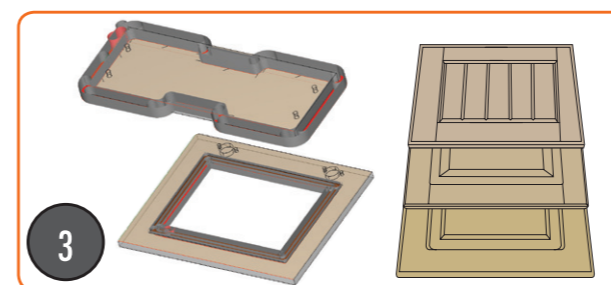

Router shape cutting

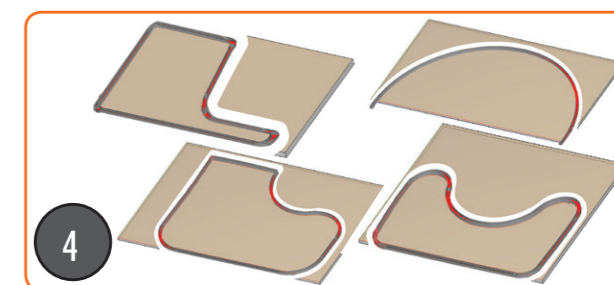

Advantages of Vitap Software **BAR NESTING**[®] againsts traditional CNC router and **NESTING** machines

- Precut parts are much more easily moved within the shop or factory than complete sheets. They can easily be moved and put into storage by just one person.
- A precut part can be utilized partially and put back into storage once finished.
- No more limits in the execution of orizontal holes.
- It is also possible to purchase precut parts to avoid having to use saws or panel saws.



with **Point K2 TOP**

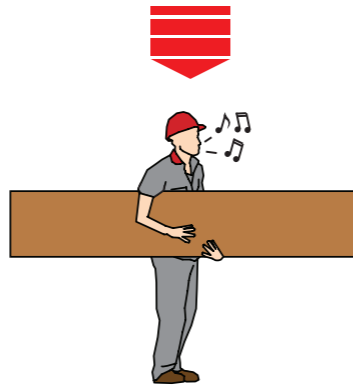

with **Nesting**

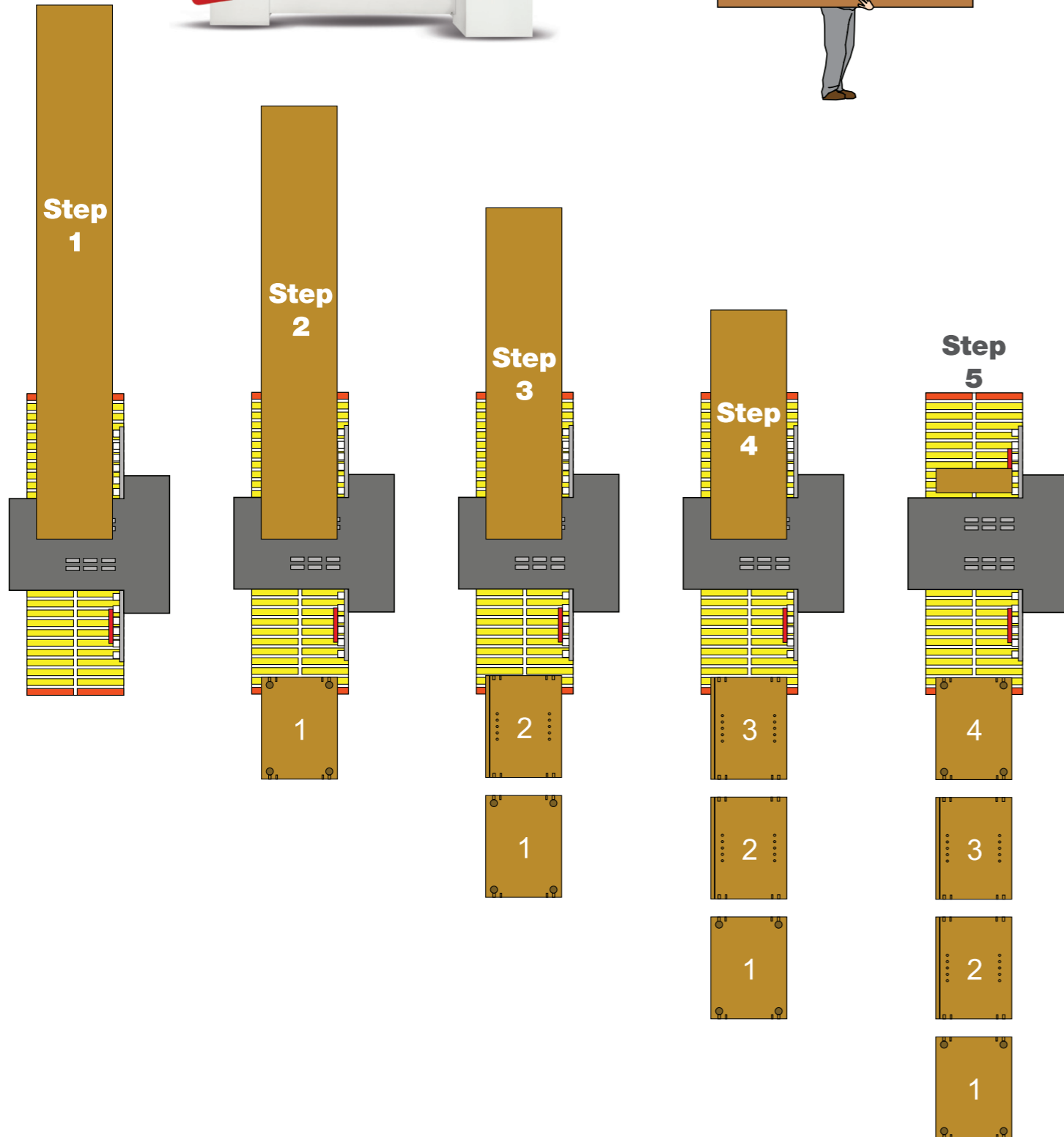
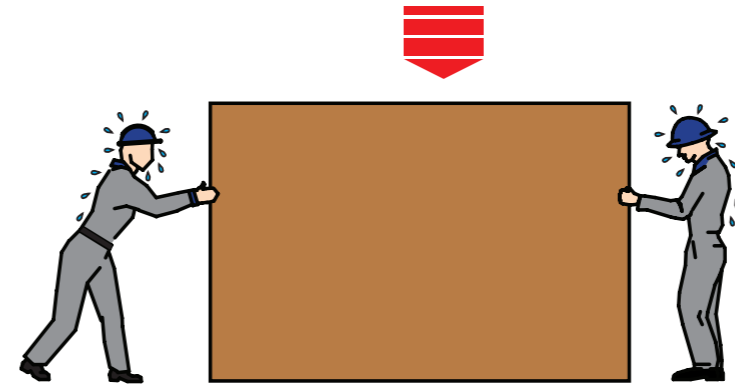

4 min.
including cutting

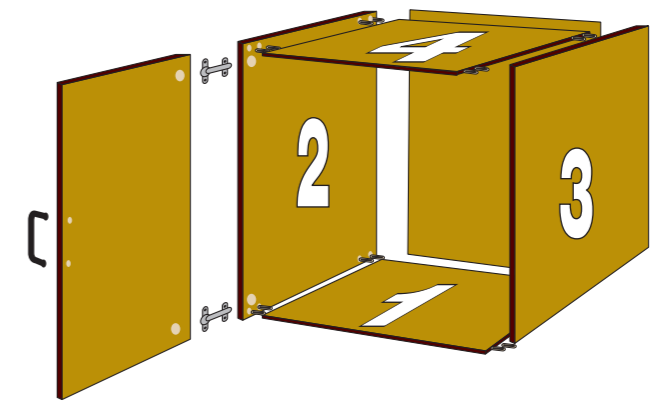

To learn more about
® Vitap BAR NESTING
see the video



COMPLETE 4 SIDES MILLING

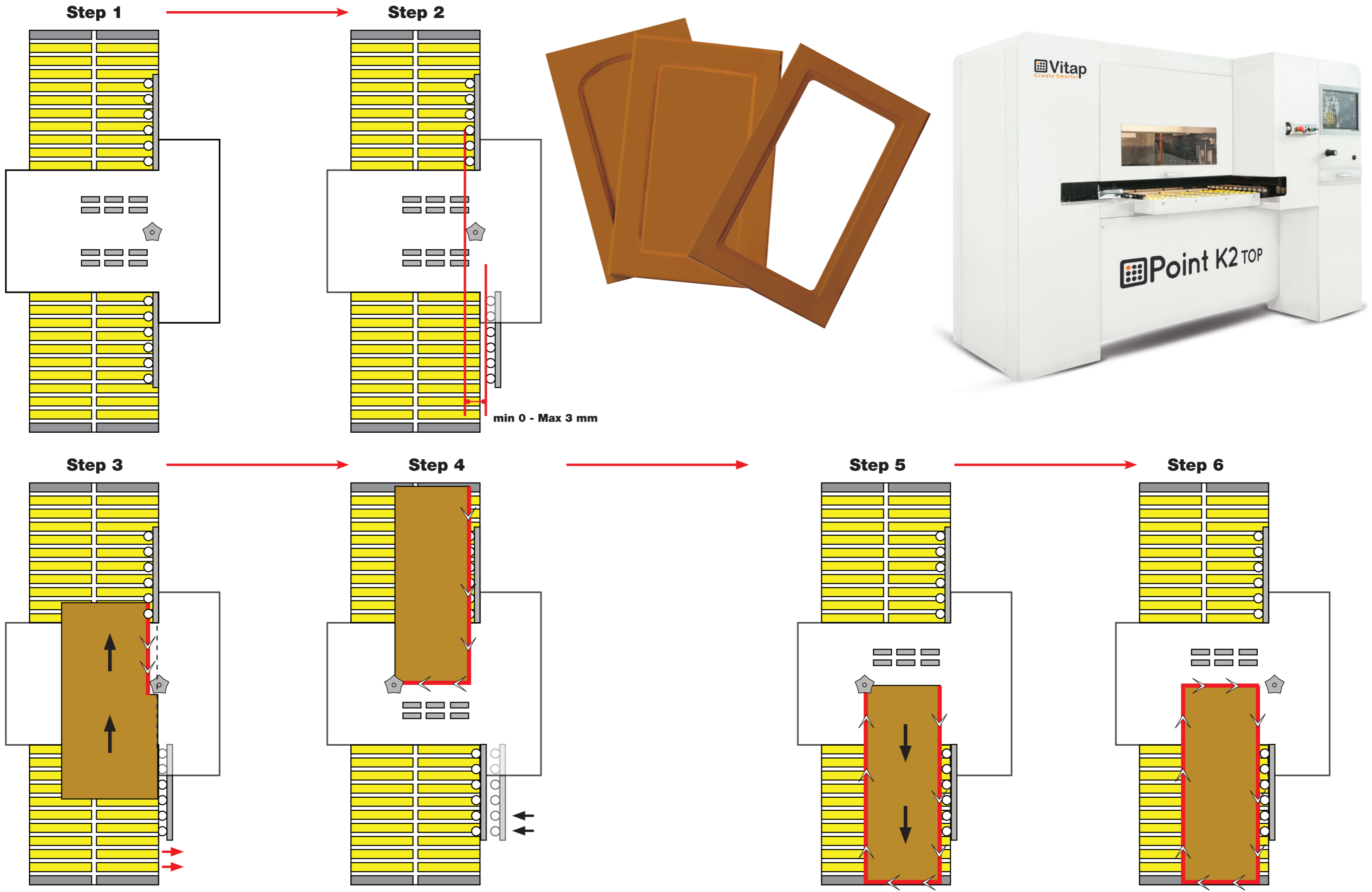

TECHNICAL DATA (standard)

Number of vertical independent spindles:	12
Number of horizontal spindles on axis X:	(2+2)
Number of horizontal spindle on axis Y:	(2+2)
N° 1 saw blade unit:	(ø 100 mm)
N° 1 Router head:	4,5 Kw ISO 30 - 12000/24000 rpm
Max. thickness of the panel:	50 mm
Control:	Full Parametric
Max weight of the panel:	Kg 80
Max panel size:	X ∞, Y 1200, Z 50 mm
Min panel size:	X 270, Y 150 (70 opt.), Z 3 mm
Number of controlled axes:	3
Panel feeding speed:	25 m/min
Spindles speed rotation:	3600 rpm
Saw blade speed rotation:	7000 rpm
Air pressure:	7 bar
Diameter of the dust extraction:	2 x ø 100 mm + 1 x ø 50 mm
Exhaust air consuntion:	(2000 mc/ora) - (30 m/s)
Max drilling depth in horiz. on X and Y axis:	30 mm
Max drilling depth in vertical:	45 mm
Max horizontal diameter of the tools:	12 mm
Max vertical diameter of the tools:	35 mm
Motor power:	1,5 kw
Total power:	6,4 Kw
Size:	2615x1640x1890 mm
Weight:	Kg 950
CE Standards	

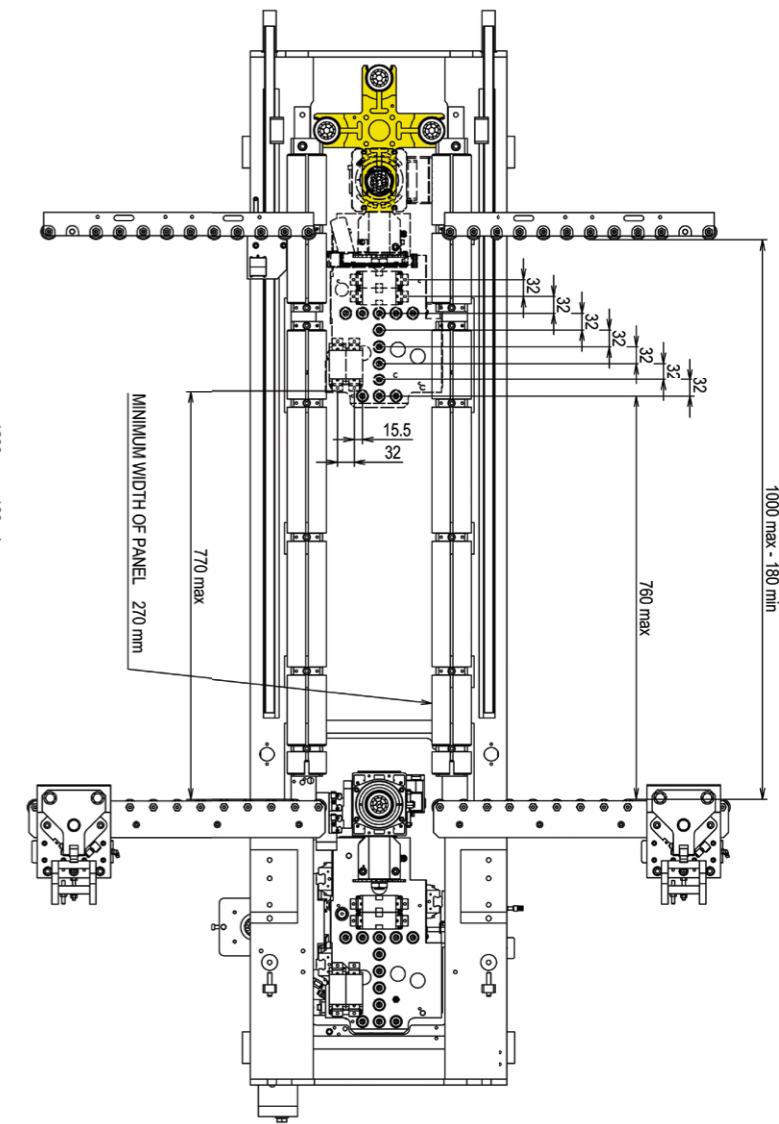
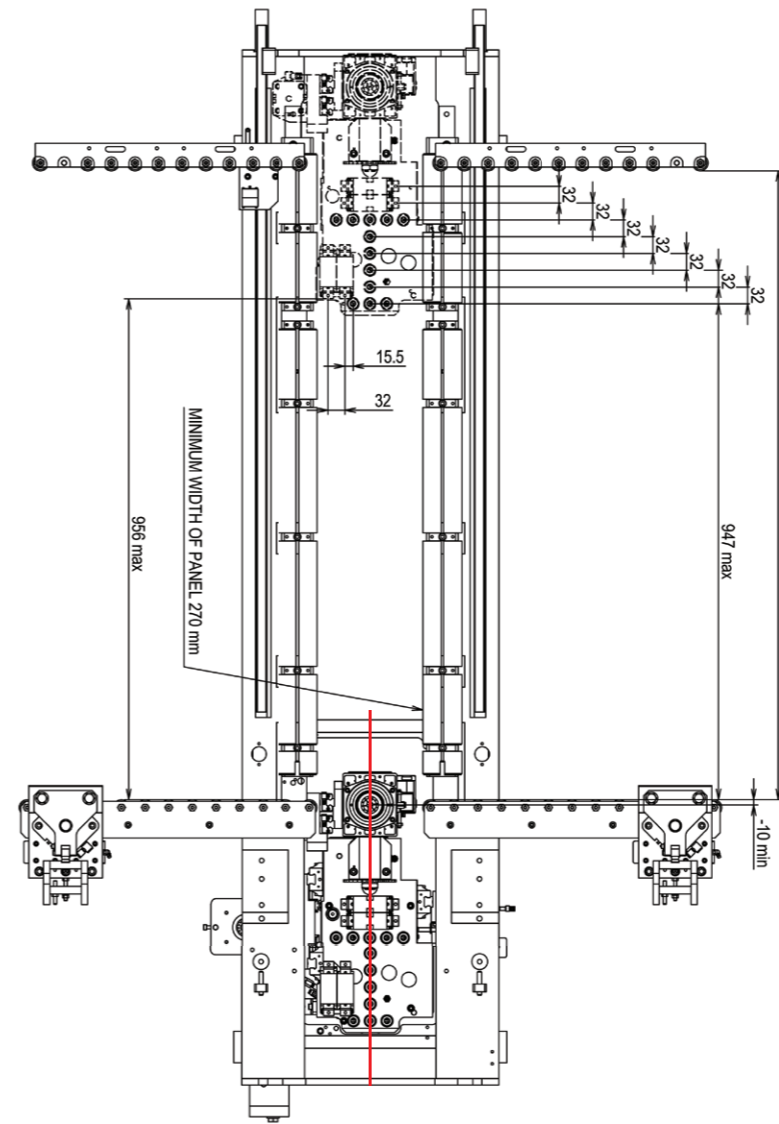
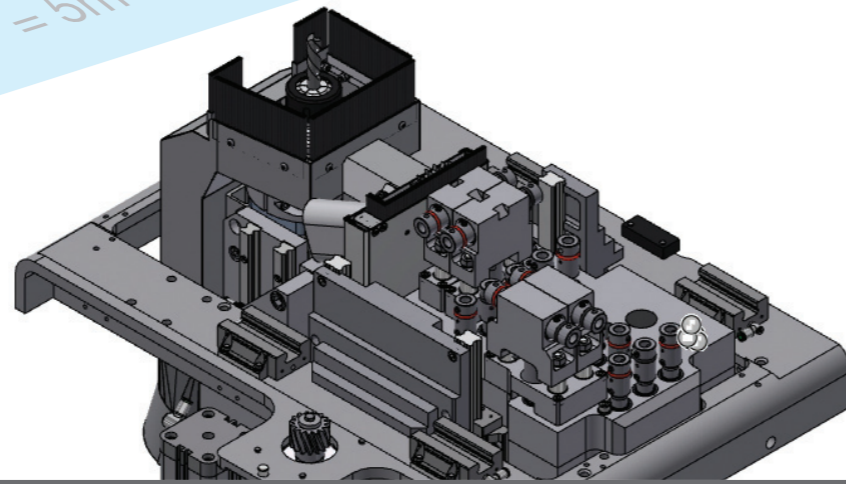
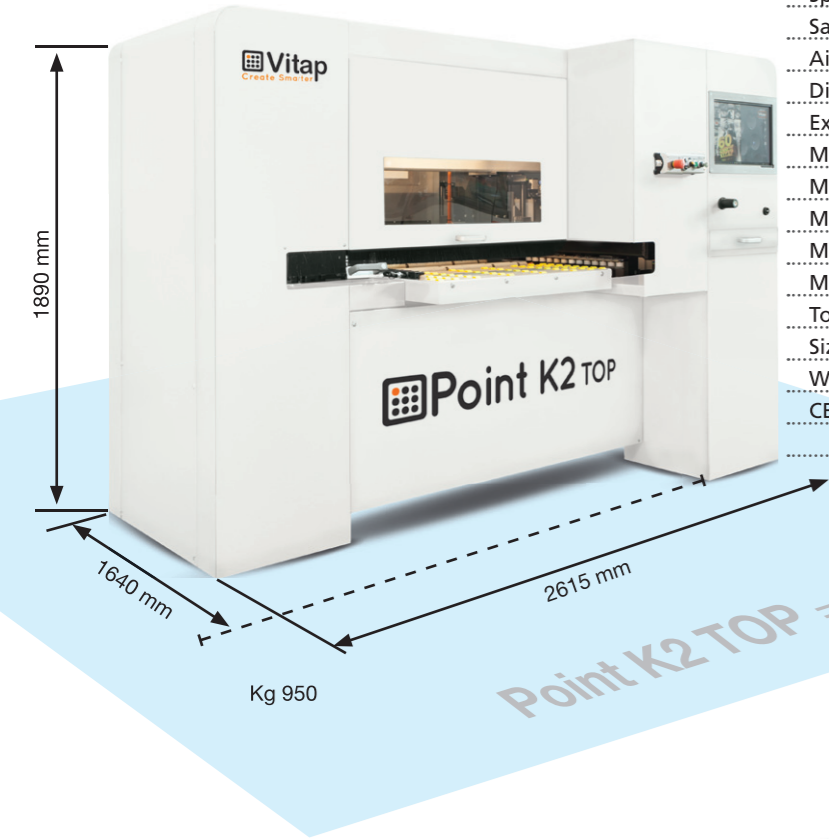

Options

Options

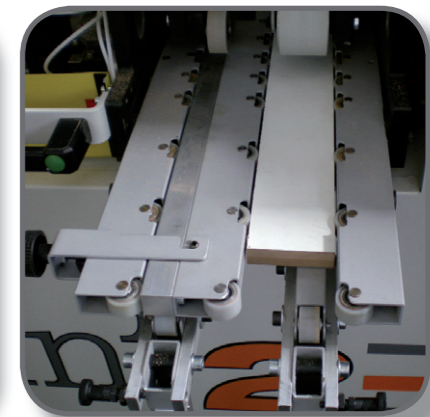
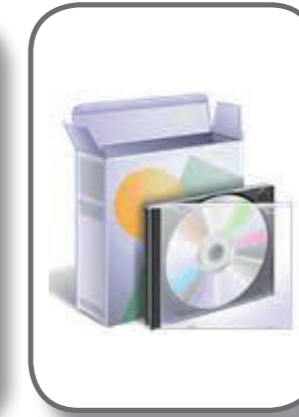
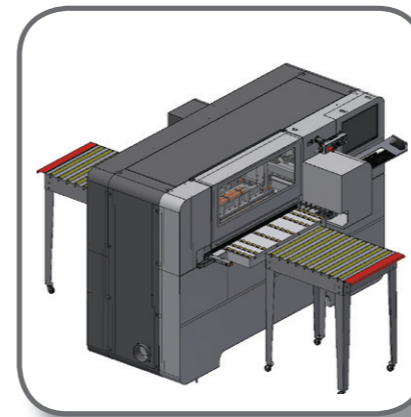
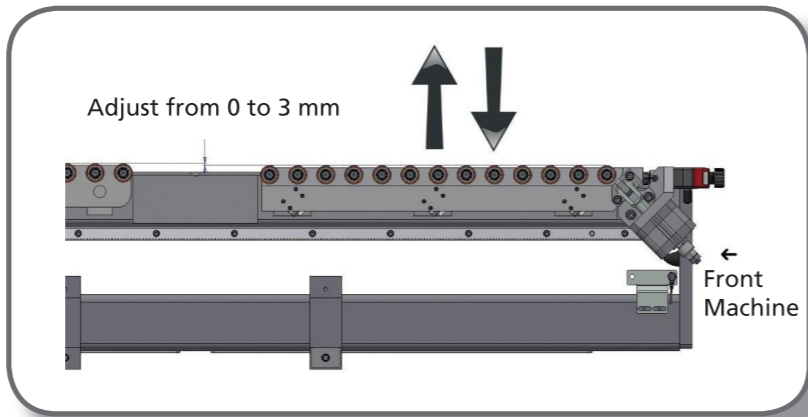
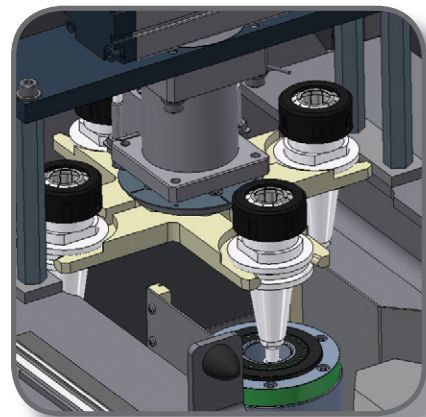

N°4 positions tool changer. (Y axis 1000 mm)

4 sides milling device

Frontal and rear rollers

Bar code reader

Software for set up from office

Min. panel width 70 mm

The Point K2 TOP can be utilized to manufacture custom cabinetry and furniture, as well as large production runs, proving its great flexibility.

To validate this information, we invite you to watch our videos on **YouTube** VITAPTUBE.

