

Precision and Performance in Batch Size 1

HE HOMAG

Our edge banding machines
EDGETEQ S-800 profilLine

YOUR SOLUTION

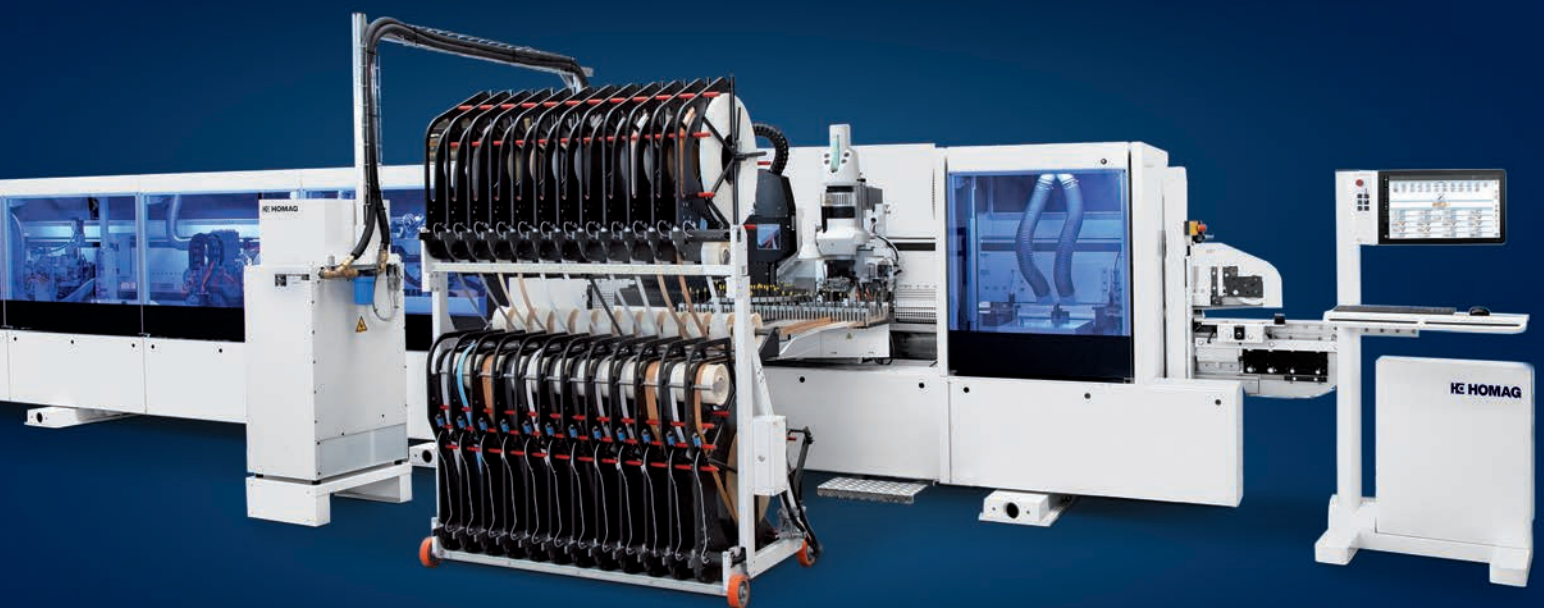



So you think there is always room for improvement? Welcome to HOMAG

In today's world, good is simply no longer good enough. Only by delivering furniture in absolute premium quality you can be sure to stay ahead of your competitors. An item of furniture tells its own story about how and on which machine it was produced. The edge progression and joint quality must be just right every time – and by producing with plants and machines from HOMAG you know they will be. The use of high-performance HOMAG machines ensures excellent efficiency. Thanks to high availability and consistent first-class quality, your customers will always receive impressive products.

YOUR SOLUTION

[MORE: HOMAG.COM](https://www.homag.com)



CONTENT

- 04 Highlights
- 10 Batch size 1 production
- 14 Edge circulation solutions
- 16 Modular units
- 33 HOMAG LIFE CYCLE SERVICES
- 34 Control system
- 36 powerTouch2 and software
- 39 tapio



Machines to place you firmly in the Champions League

The EDGETEQ S-800 profiLine series offer the ultimate in terms of freedom, performance and flexibility. After all, it was designed with the highest production category in mind. With HOMAG edge banding machines from these single-sided series you can profile, rebate and groove panel-shaped workpieces such as chipboard, MDF, coreboard panels, solid wood and plastic.

And it goes without saying that workpieces can be edged using hot-melt, PUR adhesive or zero joint technology with any kind of popular edging material: natural or plastic, coils or fixed length material. Choose between a machine, which processes pre-sized workpieces in unfinished fixed dimensions or a machine, which is capable of component sizing, edge application or finish processing.



Machines for batch size 1 production: width-independent and flexible

The gold standard for order-related production. With the series EDGETEQ S-800 profiLine an edge is banded onto the relevant workpiece side with each machine pass. These machines work independently of width and offer extreme application flexibility. Using workpiece infeed systems, they are capable of achieving high capacity levels both with pre-sized and unsized workpieces.



TECHNICAL DATA

Workpiece min. (mm) *	120 x 240
Workpiece thickness (mm) *	8 – 60
Edge thickness, coils (mm) *	0.3 – 3
Feed steplessly adjustable (m/min)*	15 – 40

* other dimensions possible upon request

Advanced profitability | due to long operational lifetime and high efficiency

The robust design of the machine frame and the advanced technology of the rolling block link chain all ensure that your workpieces are processed with maximum dimensional accuracy and efficiency.



YOUR BENEFITS AT A GLANCE

- Reduced noise emission by optimized noise protection cover
- Comfortable chip removal with integrated waste slide
- Less maintenance by using e. g. maintenance-free top pressure gears
- Simple fluid handling such as separating and detergent agent as we made them easily accessible and improved visibility of fill level
- Space saving by integrated switch cabinet
- Optimized groove position: the grooving unit SF25 allows bigger distances between groove position and glue joint
- Continuous drilling pattern on top pressure and machine frame allows easy retrofitting of units and increases investment security

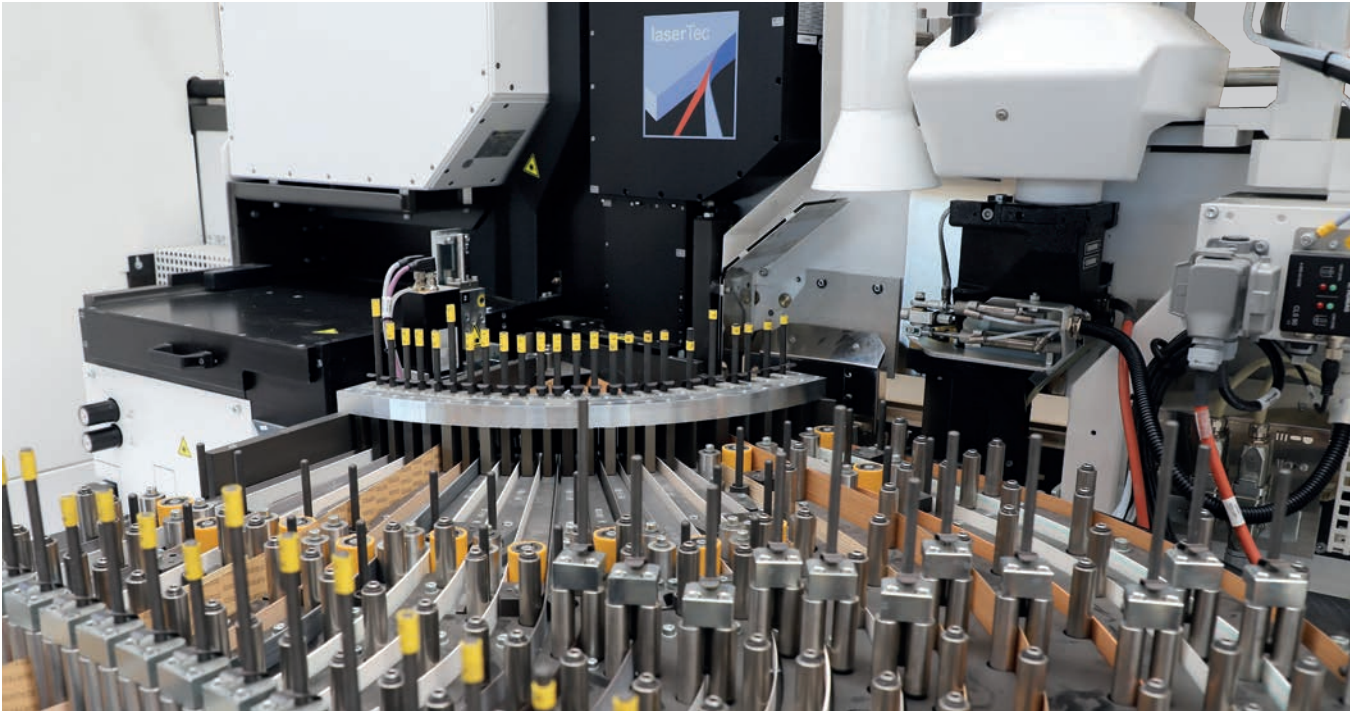

Flexibility in gluing

Gluing units for processing with EVA-, PUR glue and zero joint technology are available – it's your choice.



Sophisticated technology

All machines of the series EDGETEQ S-800 profiLine are equipped with a rolling block link chain. This progressive technology ensures that all workpieces are transported with pinpoint precision and processed with extreme dimensional and repeat accuracy. Experience has proven that the HOMAG block link chain is far less susceptible to wear than block link chain types with semi-circular rod. The proof: outstanding performance over a feed distance of more than 200 meters, even in dusty environments.

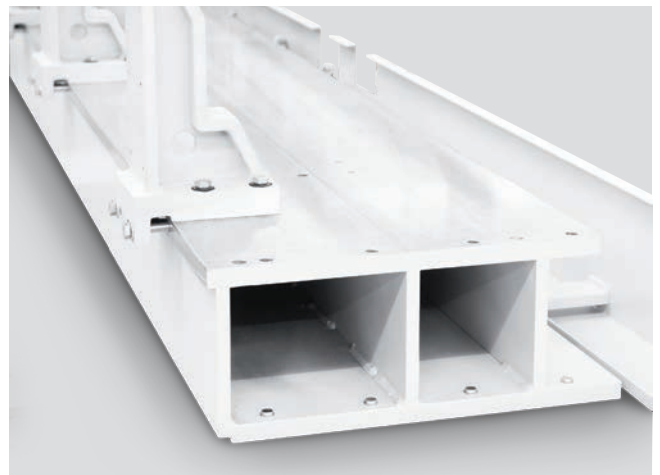

Robust and variable

The torsionally rigid dual frame construction of the machine forms the foundation for the extreme processing precision of all units. The variable frame design permits the entire HOMAG range of modular units to be accommodated on the series EDGETEQ S-800 profiLine. Simply tell us what you require.

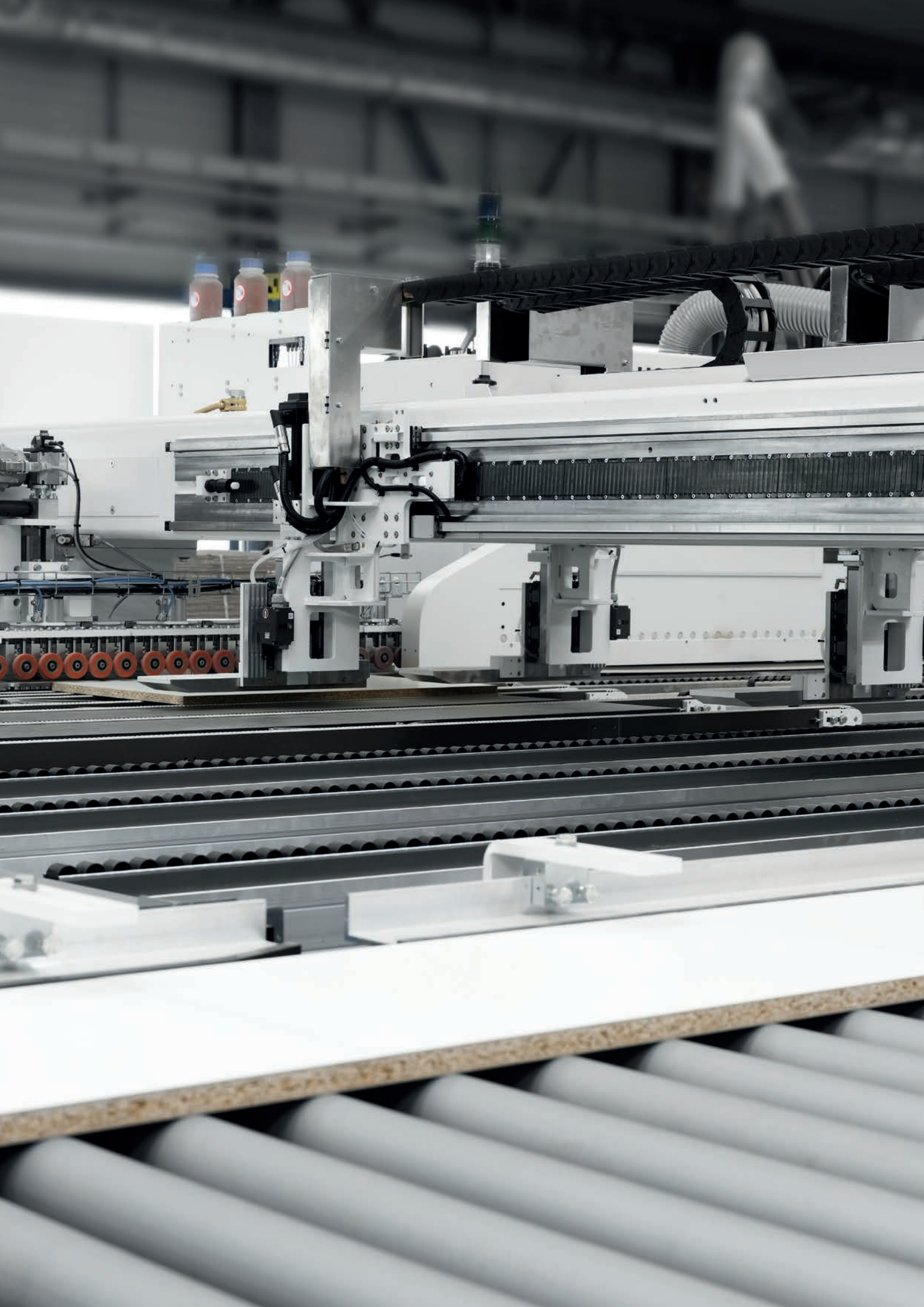

Flexible longitudinal and transverse processing with workpiece infeed systems – or simply call it “Precision Work”

This concept of multisided processing in consecutive passes enables high capacity levels to be reached, even for orderrelated production with continuously changing

dimensions. High-speed unit resetting within a minimal gap between two workpieces represents the state-of-the-art.

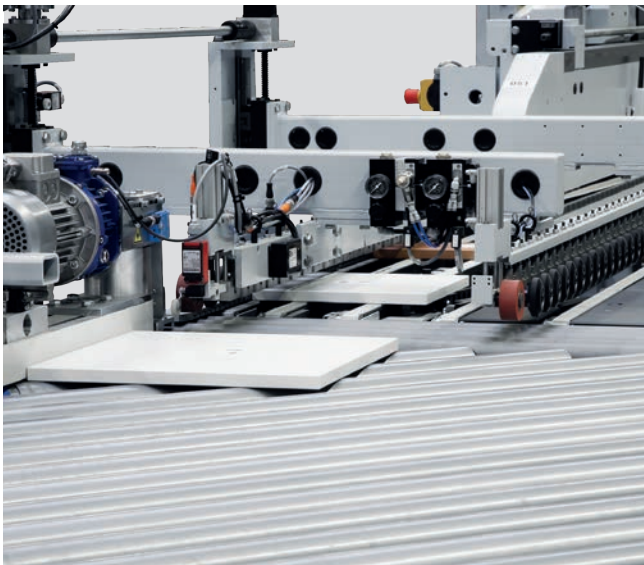

Workpiece infeed system WZ10

For workpieces which have already been cut to a high level of angular and parallel accuracy with their unfinished fixed measurement, we recommend using workpiece infeed WZ10. This is configured specifically for transporting pre-sized workpieces for flexible production. Cyclical outputs of e. g. 20 parts/min according to workpiece size.

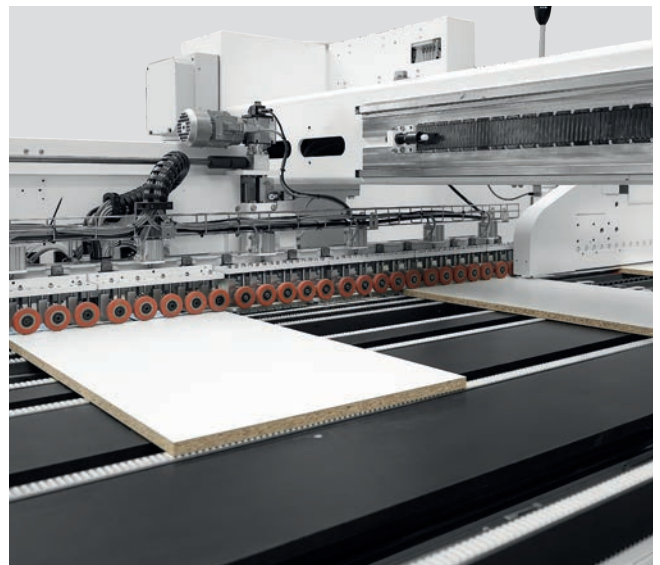

Workpiece infeed systems WZ14 and WZ24

A parallel precisely angled cut is not necessary with this workpiece infeed system. The workpieces are fed at a precise angle in the longitudinal and transverse direction and the EDGETEQ S-800 profiLine's sizing units then cut the workpieces precisely to size. Depending on the workpiece infeed system (WZ14 or WZ24), cycle outputs of 12 – 35 workpieces/min are possible.

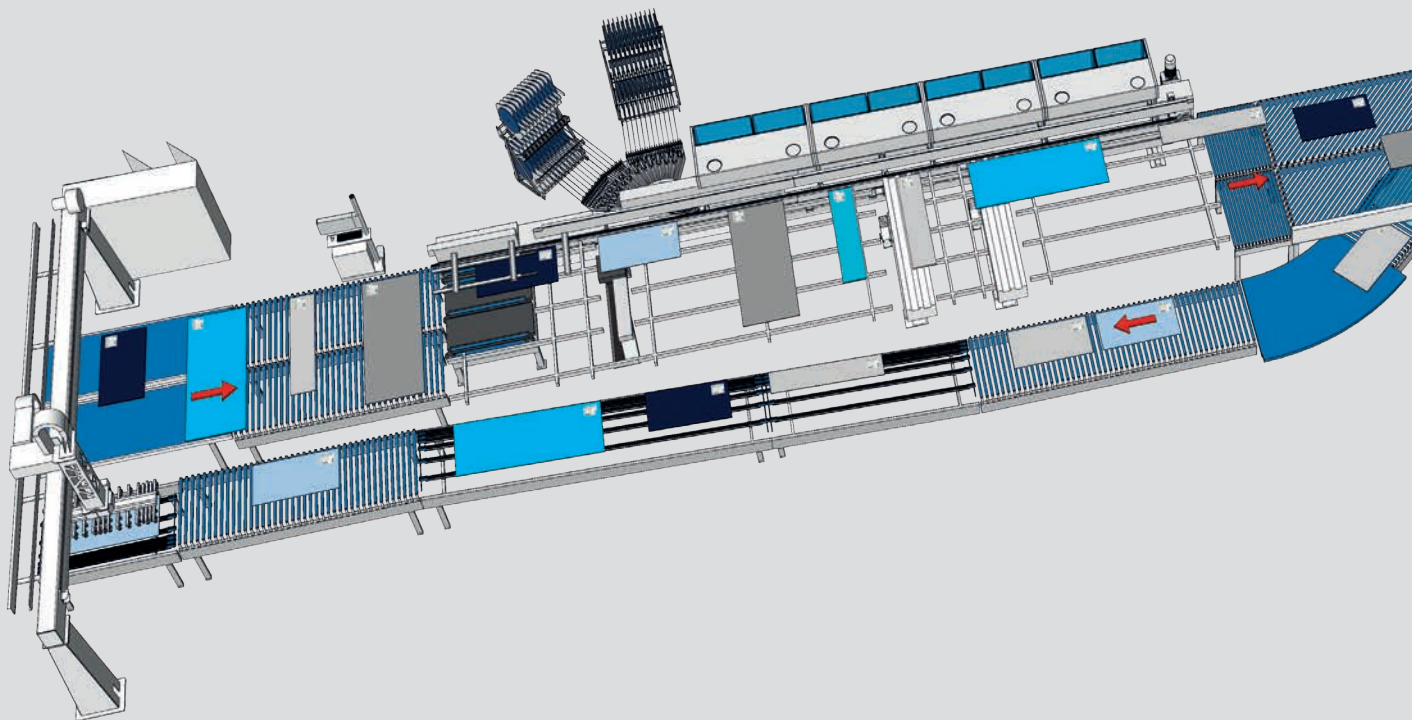
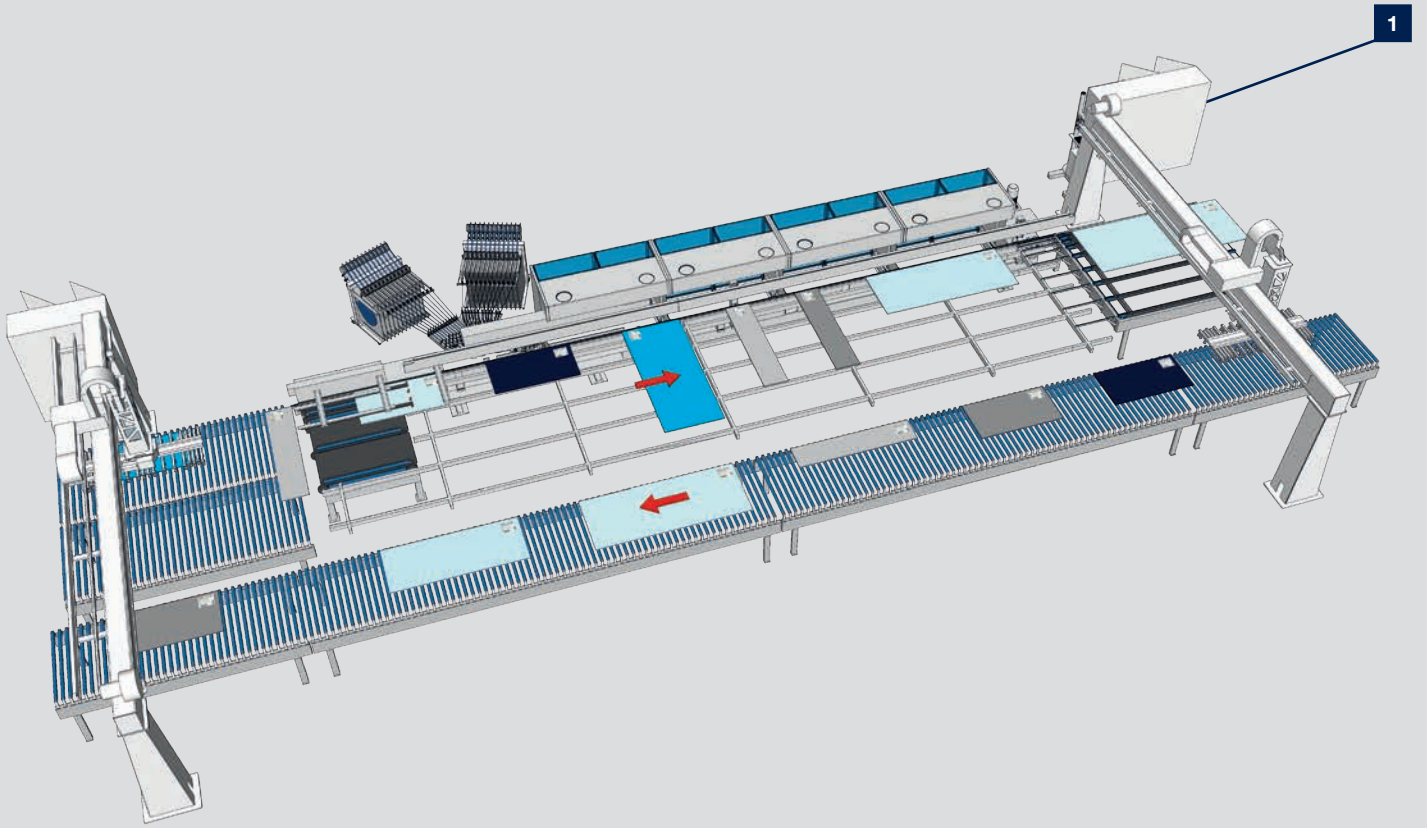

Flexible Production in batch size 1

Customers are increasingly looking for personal furniture. As a result, there is a trend towards batch size 1 production. When implementing new production lines, we aspire to combine variant diversity and batch size 1 production

with outstanding economy. The series EDGETEQ S-800 profilLine always provides the right technical solution without compromising flexibility and output. Ask for our basic concepts.

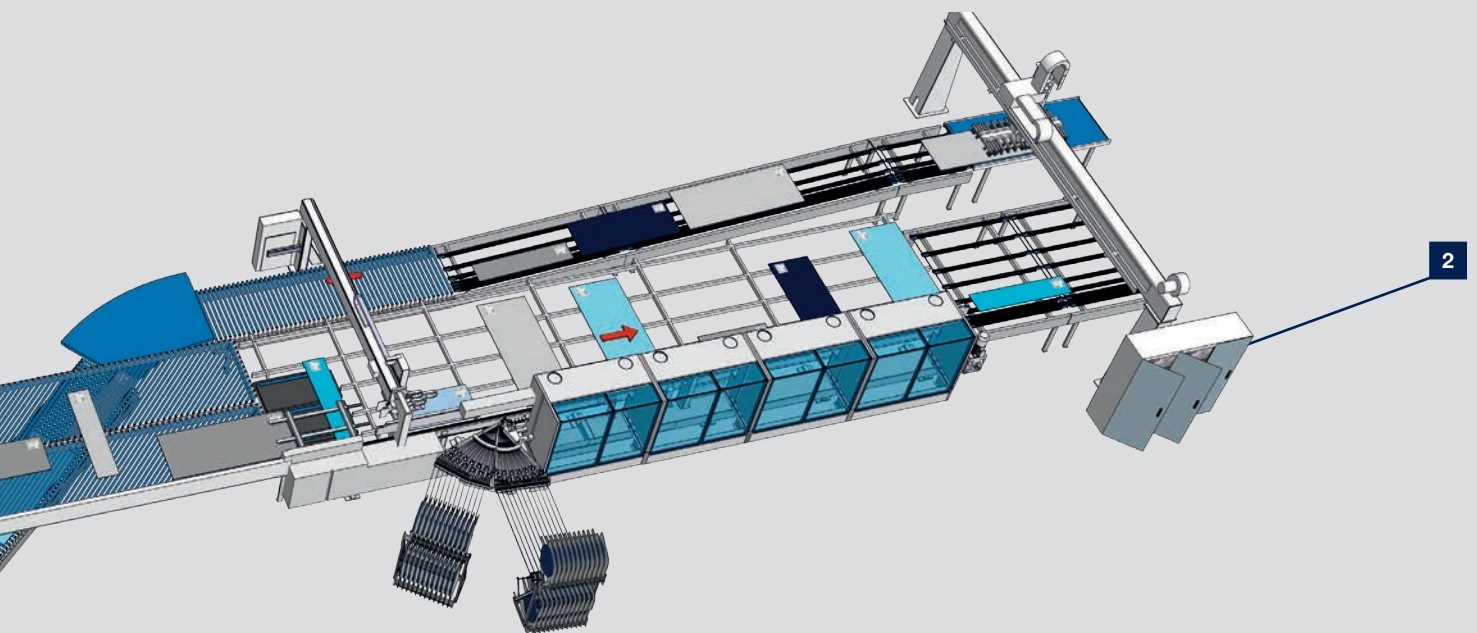

Two HOMAG basic concepts as examples

1 Basic concept 5

2 Basic concept 6



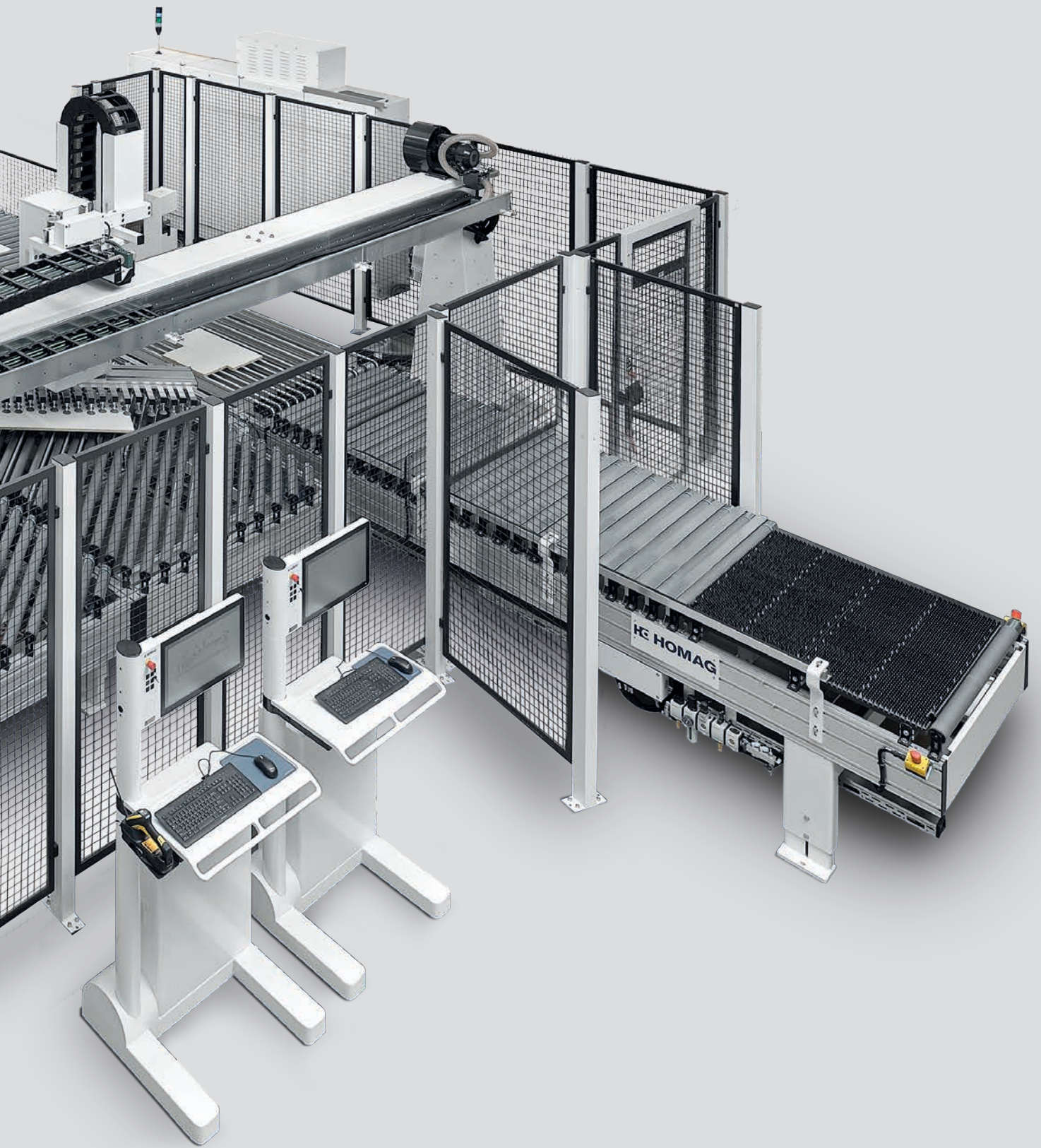



TDL 310 – Rotation on one level

Components with extreme dimensions are supported during the rotation process by lift-off rails.



TDL 310 and 510 rotary stations

- TDL 310, longitudinal to transverse rotary station
- TDL 510, transverse to longitudinal rotary station

Upgrading capability for:

- Batch size 1
- Lightweight panels
- Workpieces up to 80 kg or more



Feeding tables TBL100

With cycle fence for manually feeding of workpieces in longitudinal direction. No previous machine is necessary.

Dynamic Edge Circulation Solutions

HOMAG TRANSPORT SYSTEMS AND SIZING AND EDGE PROCESSING MACHINES WORK IN PERFECT HARMONY WHEN IT COMES TO SIZE, PERFORMANCE AND SPEED. They provide the prerequisite for flexible furniture parts production whether it be series or batch size 1 production. They improve precision and repeat accuracy

with high availability and operational reliability. The hardware and software speak the same language. The result: perfectly automated sizing and edge processing.



Edge circulation unit in 2-gantry version

- Processing machines incorporated into the circulation system, such as sizing and edge banding machines, can carry out automatic production
- Maximum repeat accuracy during collection, delivery and transport of the workpieces
- Variable workpiece positioning, longitudinal or transverse, through -90° , $+90^\circ$ and 180° rotation
- High drive dynamics with just 0.4 seconds per stroke movement and 1.3 seconds for 90° rotations
- Damage to the panel material is virtually eliminated
- The space required for transport and implementing the gap between workpieces is reduced to a minimum

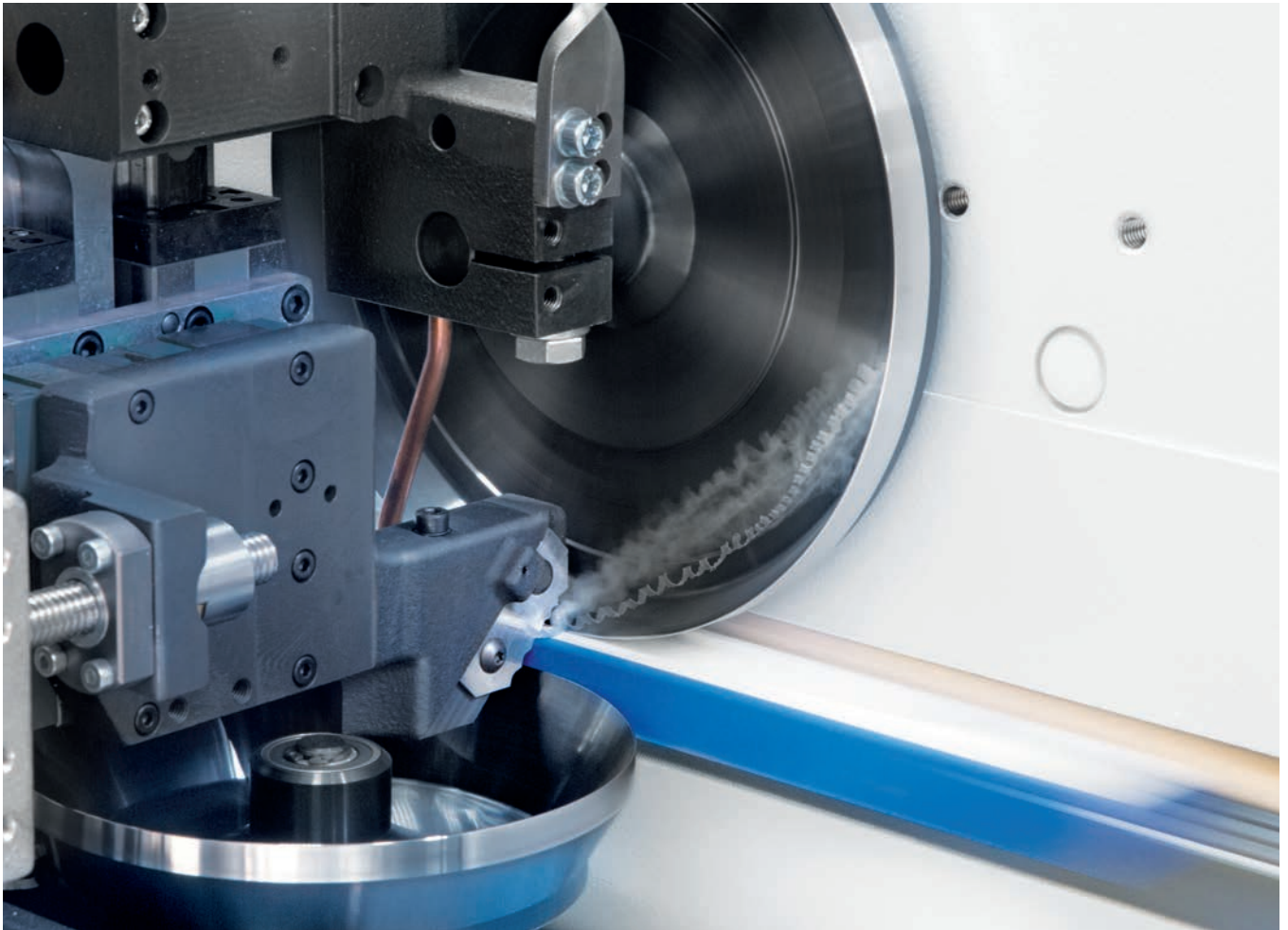

Our range of modular units – always up to date

A wide range of different units is necessary to cope with varied processing operations. By continuously extending our range of units, we ensure that you have the right solution

available to cope with changing trends. Their extreme precision and state-of-the-art technology will boost the flexibility and efficiency of your production.

Sizing units |

Your challenge, our solution

Top quality results can only be achieved through smart coordination of every production step to achieve enhanced efficiency. This is precisely what HOMAG does: the sizing units used for workpiece preparation provide the basis for perfect glue joints.

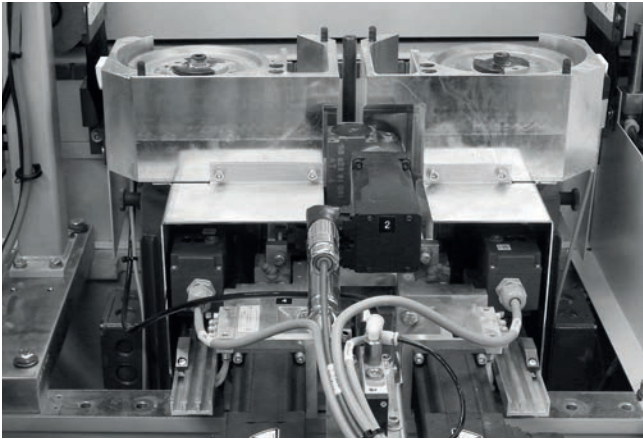

Jointing trimming S2 Power

This servo-axes controlled unit permits a high level of processing precision, is extremely hardwearing and is also designed to ensure an above-average service life. The tool diameter is 150 mm.

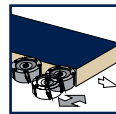

Compact double hogger KD11

With power ranging from 6.6 – 8 kW, larger processing allowances can also be reliably cut in a clean, splinter-free manner.

For hogging workpiece sizing in longitudinal and transverse operation with three high-performance motors. Two hogging units with a diameter of up to 250 mm can be mounted.

- Automation to suit every need
- Automatic height adjustment
- Program controlled automatic overhang adjustment

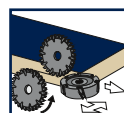

Edge feed |

Varied and precise

SERVO EDGE FEED DOES MORE THAN JUST SOUND IMPRESSIVELY HIGH-TECH – IT ACTUALLY CUTS OUT EDGING WASTE AND SO TANGIBLY REDUCES PIECE COSTS. We have actually patented this precisely dimensioned edge feed system with its ultra-minimal

workpiece corner overhang – after all, it was invented by HOMAG. HOMAG offers you a wide edge feed range, from single and dual-slot magazines right through to a changer with 48 slots.

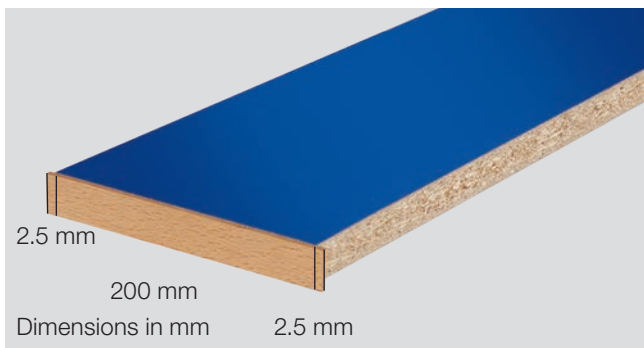
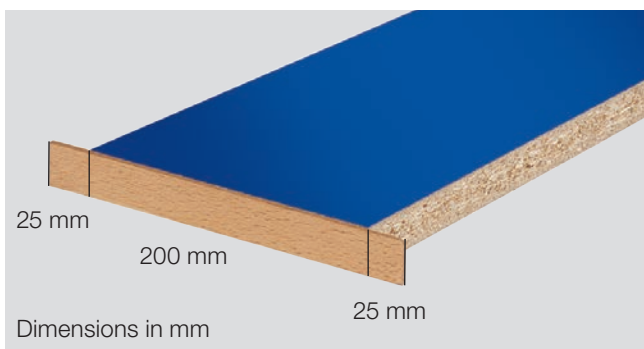

Above: Conventional gluing technique
Below: Optimized gluing technique with servo edge feed

Lower waste, fewer costs

The servo edge feed system feeds the edging material precisely dimensioned to the workpiece corner with only the barest minimum overhang.

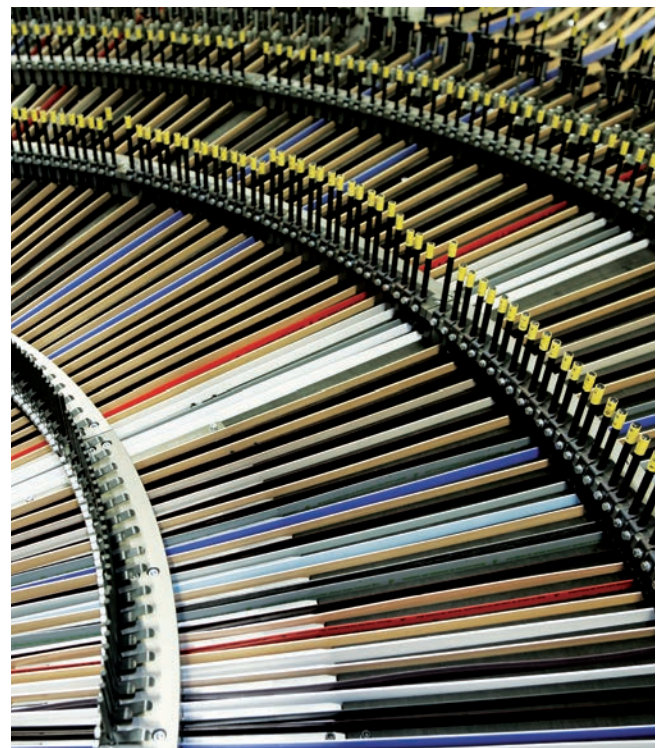

Multiple edging magazine

The range covers single and dual-slot magazines right through to changers with 48 slots, allowing edges ranging from 0.3 – 3 mm to be processed with ease.

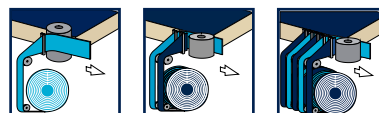

Gluing units |

Sticking with the best

HOMAG GLUING UNITS ARE IDEAL FOR A FAST, POSITIVE-LOCKING GLUE BOND. The standard gluing unit uses the pre-melt system. The heated glue roller ensures an optimum gluing temperature, while magazine

height adjustment offers scope for processing wide-ranging workpiece heights. A simple, toolless quick changeover of the application unit allows other glue colors to be deployed with minimum delay.

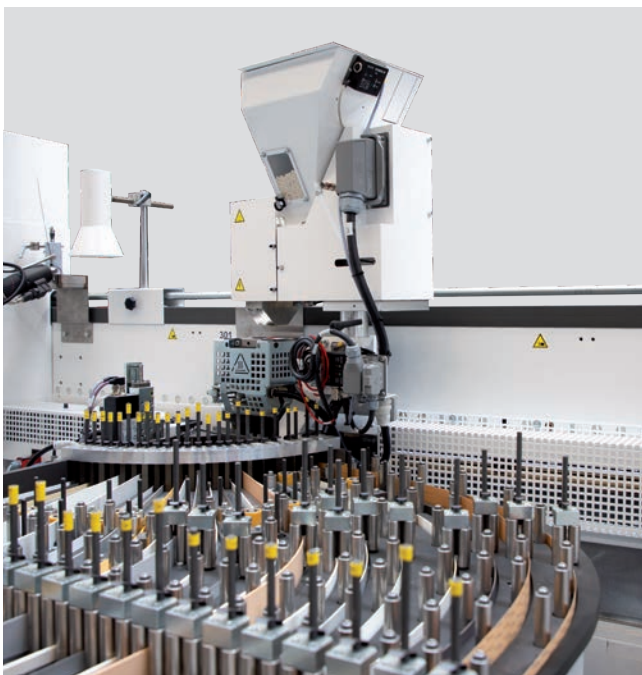

Hot-melt gluing unit

For optimum glue application on the narrow surface. Changes to workpiece thicknesses do not necessitate resetting of the glue application roller.

Quick-release clamping system for application unit with straight edge

A quick-clamping system is optionally available for the application unit which permits fast hot-melt glue color changeover. This allows hot-melt glue changeover without mixing the different glue colors.

Melting unit with granulate tank

With a melting rate of 18 – 35 kg/h, there is always plenty of hot-melt glue available. Even quantities of up to 45 kg/h pose no problem.

Pneumatic Dosing Bar

To avoid chip pollutions, cleaning of glue application roller cannot only be executed when the feed stops as the pneumatic dosing bars can open and close in a workpiece gap.

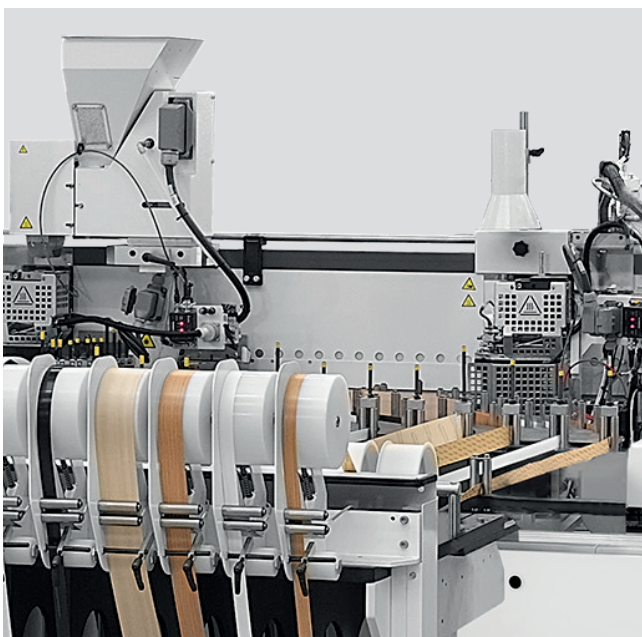

The second gluing unit

A second gluing unit can be installed which permits automatic glue color changeover or change between hot-melt glue and PUR without any manual intervention.

PUR glue and HOMAG |

A strong alliance



Gluing with PUR – when humidity and heat resistance become an issue

To cope with the special requirements when it comes to humidity and heat resistance the EDGETEQ S-800 profiLine series allows the use of Polyurethane (PUR)-glue using a standardized glue application system.

During processing, PUR reacts with the ambient humidity. While cooling down, PUR is curing to Duroplast that allows a very high bonding between workpiece and edging material.



Application unit PU65
with chem-coating



PUR pre-melting unit

- Ground equipment
- Melting capacity 6 kg/h (see photo), 10 kg/h or 20 kg/h
- Temperature control for protection against overheating



Service station XES 200

- Pre-heating and cleaning station for the application unit QA65 and PU65 with a storage area
- High flexibility through the use of 2 vacuum containers, each for one application unit
- Due to storage in a vacuum, nitrogen is not necessary



Vacuum tank

- Pressure tank for storing of application unit
- Due to storage in a vacuum, nitrogen is not necessary

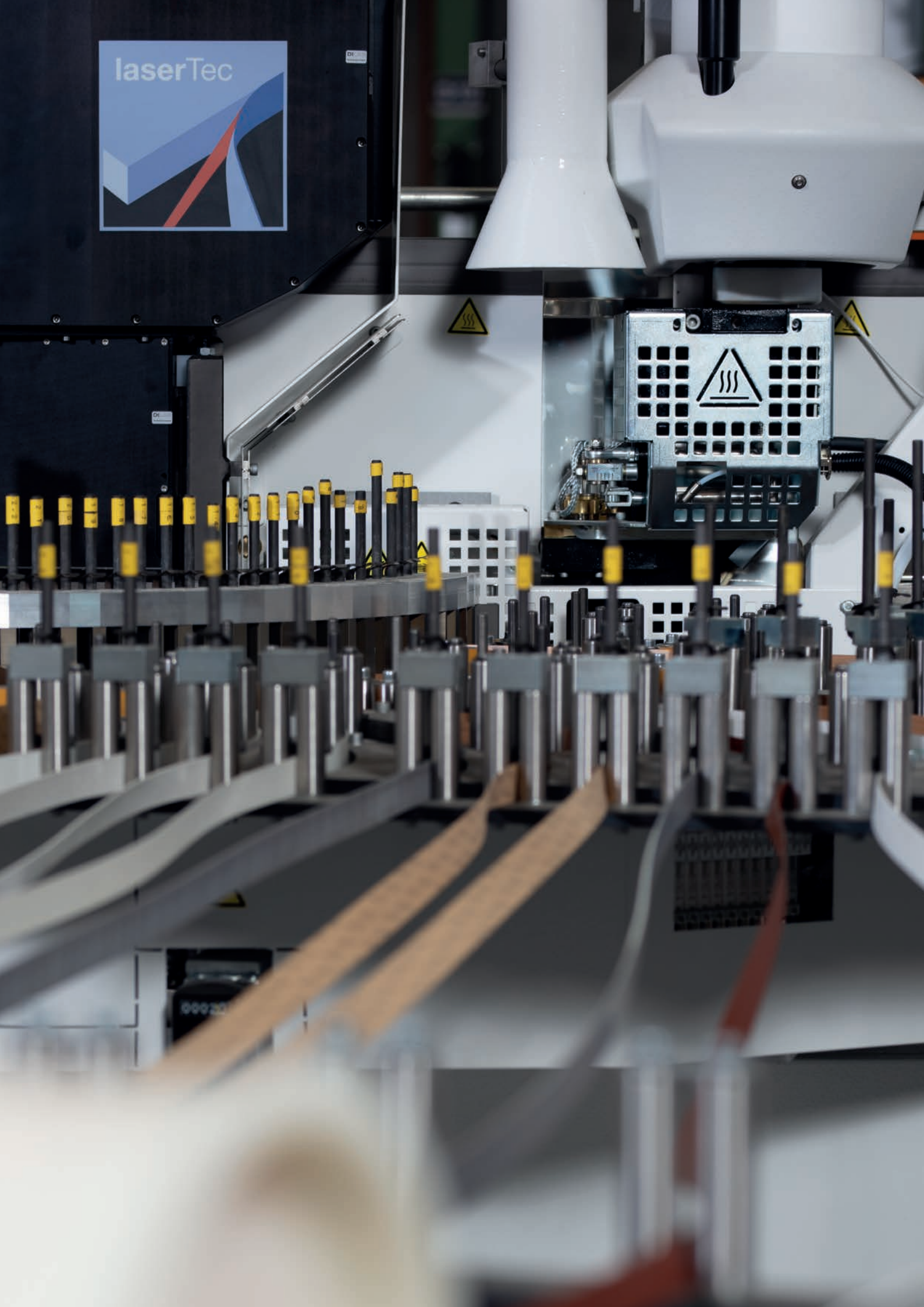



laserTec | the quantum leap in furniture production

EDGE BANDING WITH ZERO JOINT QUALITY: HOMAG laserTec is a production method which has revolutionized furniture manufacture from the ground up. With this method, a special adhesive coating on the edging strip is melted by

a laser beam and then pressed directly onto the workpiece. The result: edges complying to the highest conceivable standard of quality. Under patent law in Germany only usable with Rehau edge.



For the entire laser edge spectrum

HOMAG laserTec can be used to process all customary types of edging such as PVC, ABS, PP or PMMA. The laser-active layer can be individually adjusted in line with product and customer requirements.



HOMAG laserTec achieves extreme production economy

- Simple operating processes
- Low additional costs
- Maximum level of availability
- Reproducible production parameters
- Resource-saving production
- Extreme production reliability

Snipping units | the perfect preparation for trimming

We are presenting a range of true team players. The snipping units prepare the workpieces perfectly for subsequent trimming operation. The face side can be snipped either straight or with chamfer. If the profile trimming is used, then a

piece of edging material is left in preparation for the optimum trimming result.

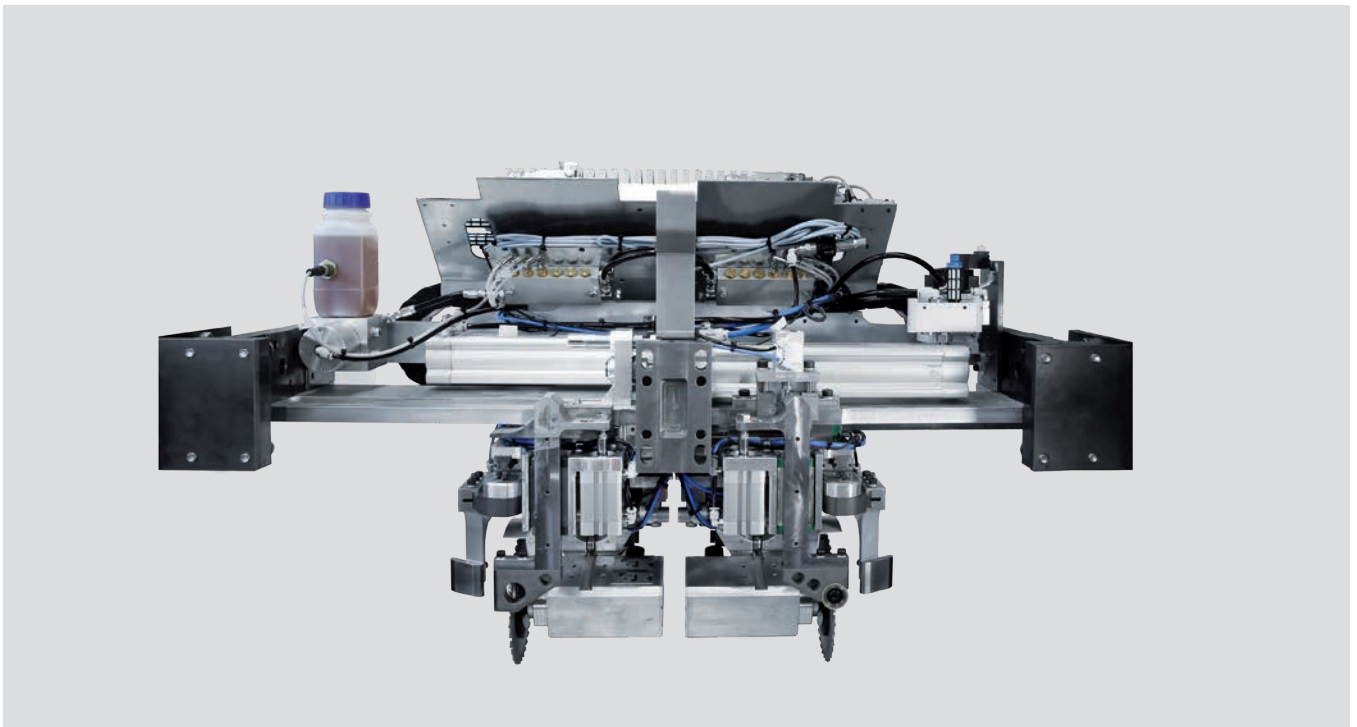

Snipping units PK25 and PK30

For snipping the overhanging edges at the leading and trailing workpiece edge with stationary snipping stop to protect sensitive workpieces from damage. The units are driven pneumatically.

Use of the snipping units PK25 and PK30

For machines with feed rates of up to
25 m/min = PK25
30 m/min = PK30

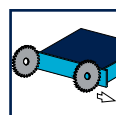

Automation as standard

Programmable chamfer/straight snipping motor adjustment for fast changeover between straight snipping and snipping with chamfer.



Automation as standard

For fast changeover between flush snipping (e.g. of solid moldings or inlay shelves) and snipping with overhang, e.g. for finish trimming with profile trimming unit.

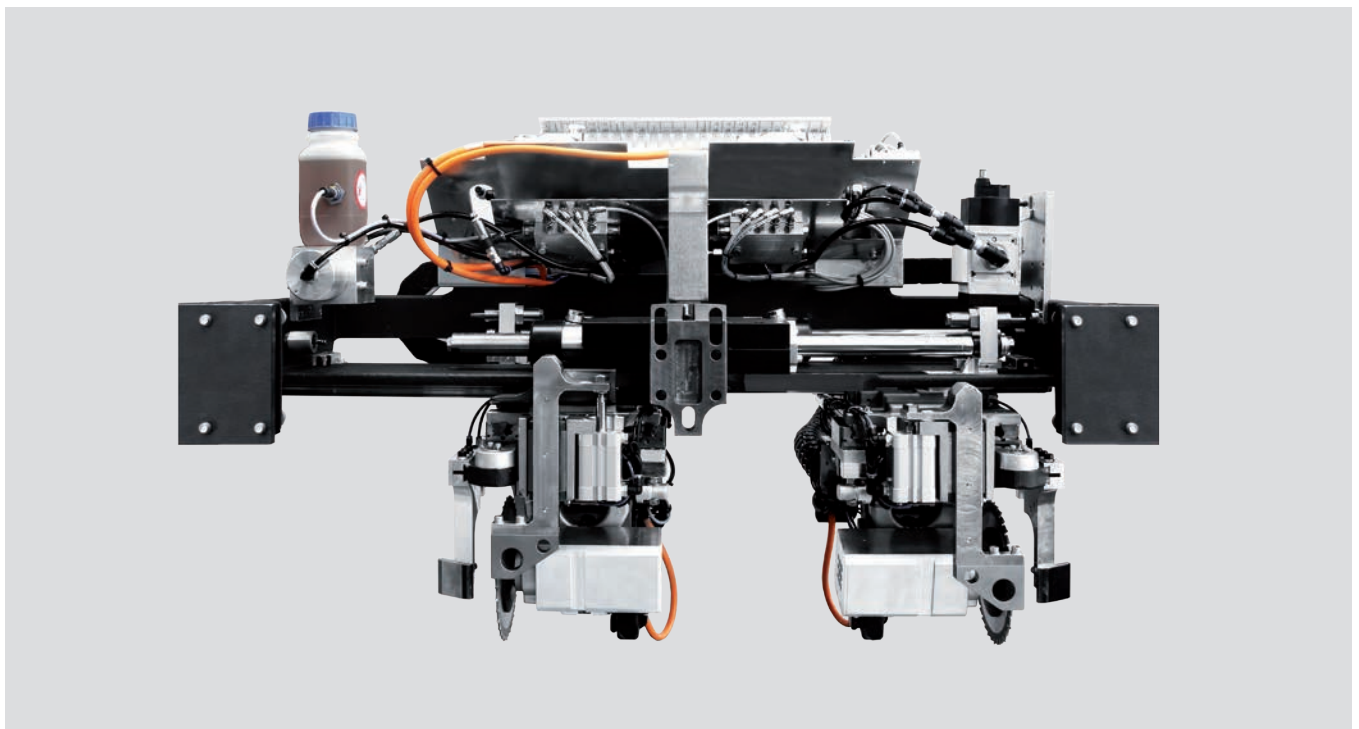

Snipping units SK25, SK30, SK35, SK40 und SK60

For snipping the overhanging edges at the leading and trailing workpiece edge with stationary snipping stop to protect sensitive workpieces from damage. The units are driven by servo motor. Advanced processing possibilities are available, e.g. rough snipping in case of laminate overhang.

Use of the snipping units

For machines with feed rates of up to
 25 m/min = SK25
 30 m/min = SK30
 35 m/min = SK35
 40 m/min = SK40
 60 m/min = SK60

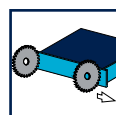

Trimming |

The solid basis for edge processing

HOMAG trimming units give the workpiece edge its required shape. Practical solutions are guaranteed, even with our basic units.

The rough trimming unit BF20 is ideal for rough trimming the upper and lower overhanging edge.



Rough trimming unit BF20

For rough trimming the upper and lower edge overhang.

Automation to suit every need

For automatic changeover from flush trimming to trimming with overhanging edge.

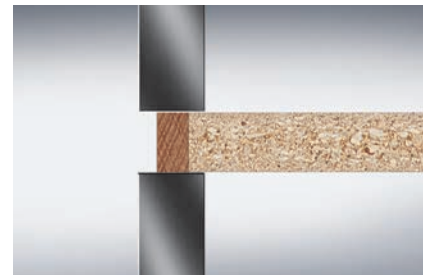

Flush



Overhang

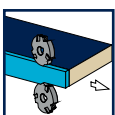



Trimming unit PF20

For trimming edge chamfers or radii above and below. Options: stepless or pneumatic adjusting devices for the trimming motor. Trimming motor exchange using exchange units.

Automation to suit every need

The automatic changeover between 2 or 3 radii and chamfer are carried out with the units PF21 or MF21. Adjustments are executed automatically or – concerning MF21 – with servo axes.



Multi-trimming unit MF21

For trimming edge chamfers or radii above and below. For automatic changeover between 3 different profiles and chamfer, e.g. chamfer 20°, R1, R1.5 and R2.

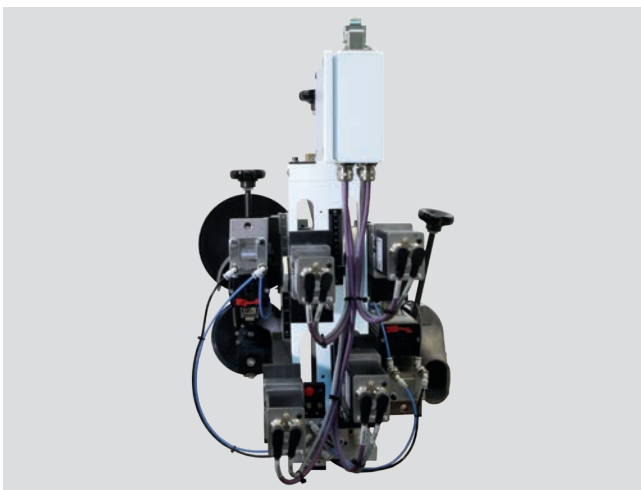

Trimming unit PF21 flexTrim

For trimming edge chamfers or radii above and below. For automatic changeover between 2 different profiles and chamfer, for instance R2 and R3.

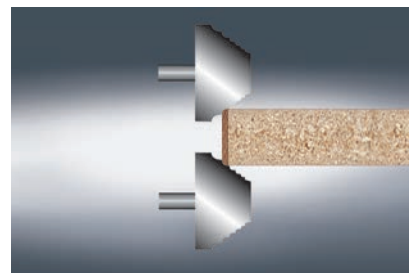

Tool MF21

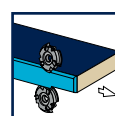

Four-motor profile trimming tools |

Take anything in their stride

THE FOUR-MOTOR HOMAG PROFILE TRIMMING UNITS ENSURE RELIABLE CORNER ROUNDING EVEN WHEN PROCESSING VENEER. Are

you looking for a unit for flush trimming the upper and lower workpiece surface?

Then you have come to the right place. The flexTrim exchangers for the fast exchange of two profiles in the gap between workpieces can be mounted on profile trimming units FF32 and FF42.

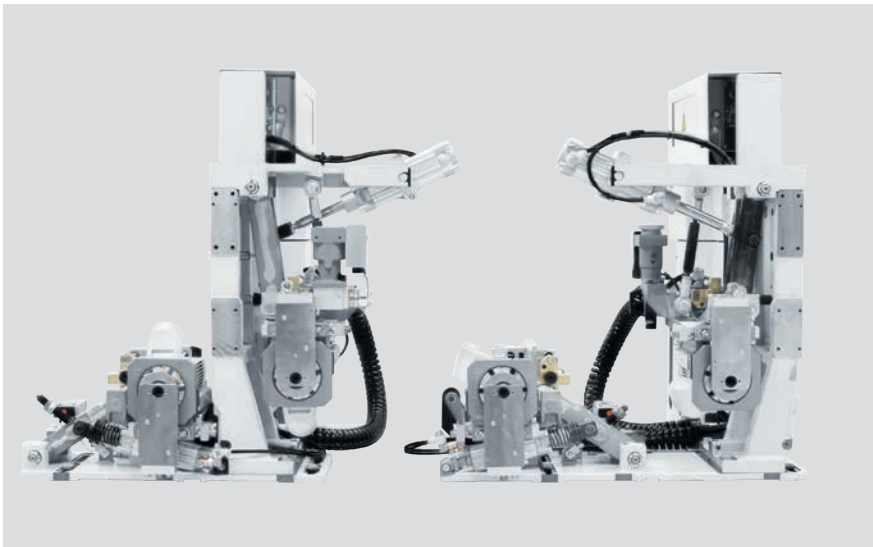

Profile trimming unit FF32

For rounding top and bottom edges on the leading and trailing workpiece edges. By dividing the cut over four motors, each corner can be processed in synchronous rotation, thus reducing the risk of splintering even with veneer.

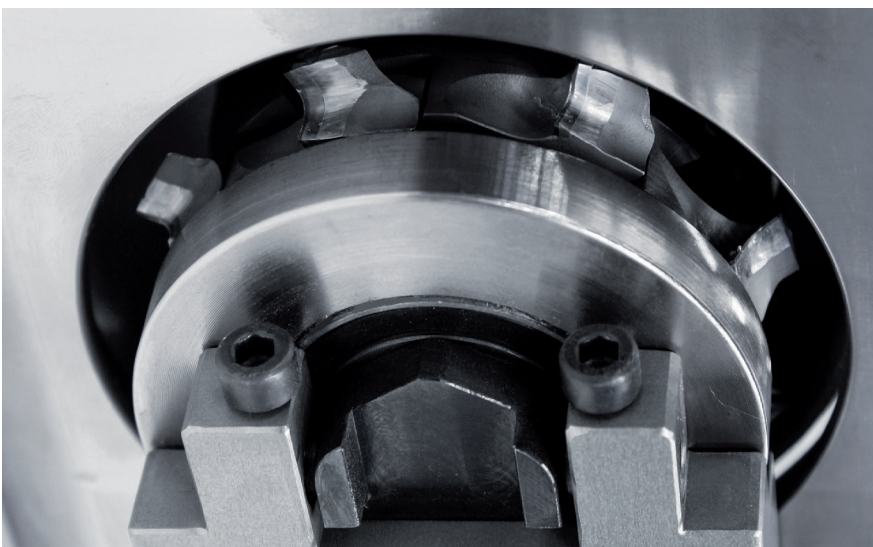
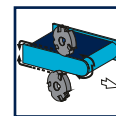

flexTrim

The flexTrim exchangers can be mounted on trimming and profile trimming units. They permit the fast exchange of two profiles within the gap between workpieces during flexible production. The change between three profiles is possible with series production.

Servo profile trimming |

Making you even more efficient

EXPECTING HIGHER PERFORMANCE, GREATER CONTOUR VARIETY AND EVEN HIGHER QUALITY? Then we recommend our servo profile trimming units FK30 profiTrim and FK31 powerTrim.

As the drive uses modern linear motors, the movement sequence is controlled by the program when trimming around the edge band on the narrow surface of your workpieces.

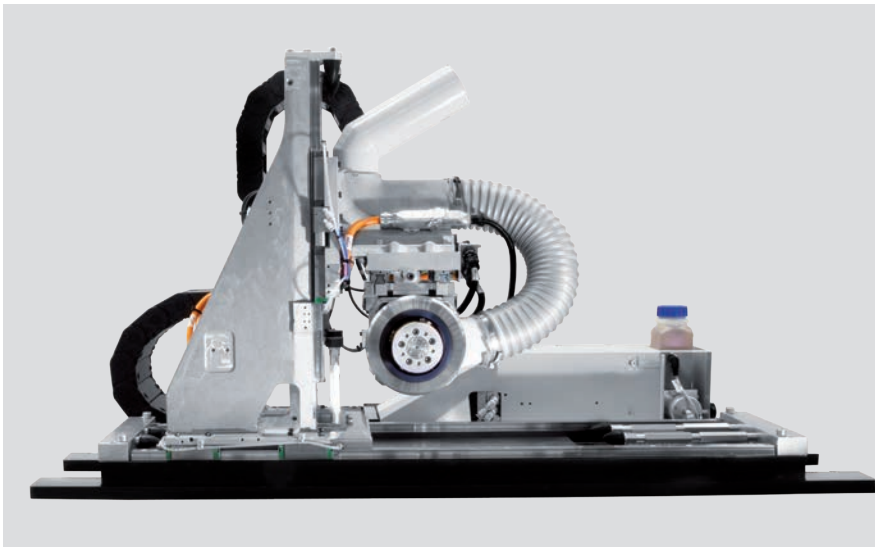

Profile trimming unit FK30 and FK31

For trimming around the leading and trailing edge. With servo motor-driven tracing axis for sensitive surfaces, softforming profiles or soft middle layers.

Use of the profile trimming units FK30 and FK31

For feed rates

20 oder 25 m/min = FK30

30 or 35 m/min = FK31

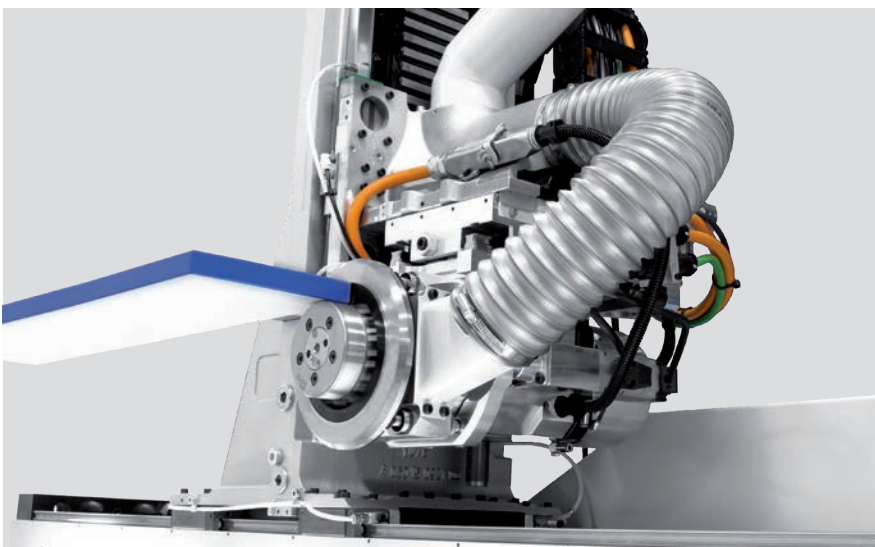
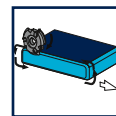

Automation to suit every need

- Adjustment to three different radii and chamfer
- Automatic adjustment of the tracing roller diameter
- Automatically adapted tracing force
- Automatically adapted speed
- Switchable between synchronous and opposite rotation

FK 31: steplessly adjustable tracing force

E.g. for honeycomb boards and soft materials

Finish |

All's well that ends well

THE FOLLOWING PRINCIPLE CAN BE APPLIED TO PRODUCTION AS WELL AS TO A MARATHON: THOSE WHO PERSEVERE TO THE VERY END WILL ACHIEVE THEIR GOAL. For a perfect finish which has you running victoriously to the winner's podium, place your trust in

HOMAG. There are a range of possibilities available to make this happen. Depending on your requirements, choose the profile scraper unit PN20, the multi scraper unit MN21 or finish processing unit FA21.



Profile scraper PN20

For smoothing trimmed edges to achieve an optimum appearance.

Automatic adjustment of PN20

To suit foil thickness for workpieces with and without protective foil.



Multi scraper MN21

For smoothing trimmed edges to achieve an optimum appearance. Changeover between max. 7 different profiles is possible.

Automation to suit every need

The changeover between 7 different profiles is executed automatically or with servo axes.

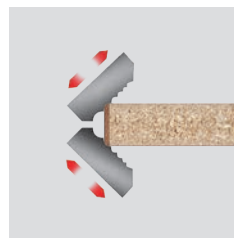
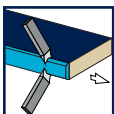

Tool MN21

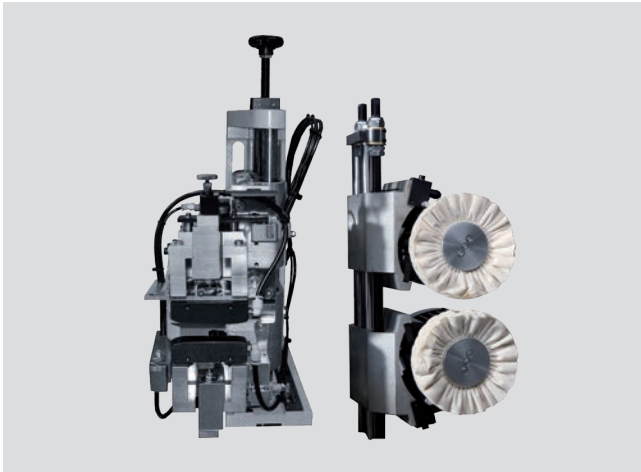

Finish processing FA21

Comprising a cleaning agent unit, glue joint scraper blade for disposal of glue residues at the top and bottom of plastic edges and a buffing unit.

Optimum surface quality

Through precision adjustment of the glue joint scraper blade to ± 0.01 mm

- Manually (as standard)
- Automatically (optional)

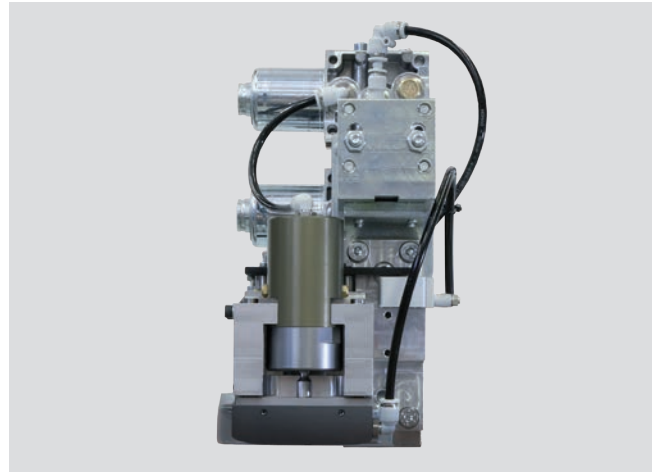

Automatic adjustment of the glue joint scraper

To suit foil thickness for workpieces with and without protective foil.

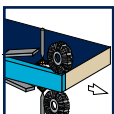



Sizing and Trimming | Neat performance

The output speaks for itself: The HOMAG standard trimming unit SF25 allows rebating, grooving and profiling – optionally also with tracing.

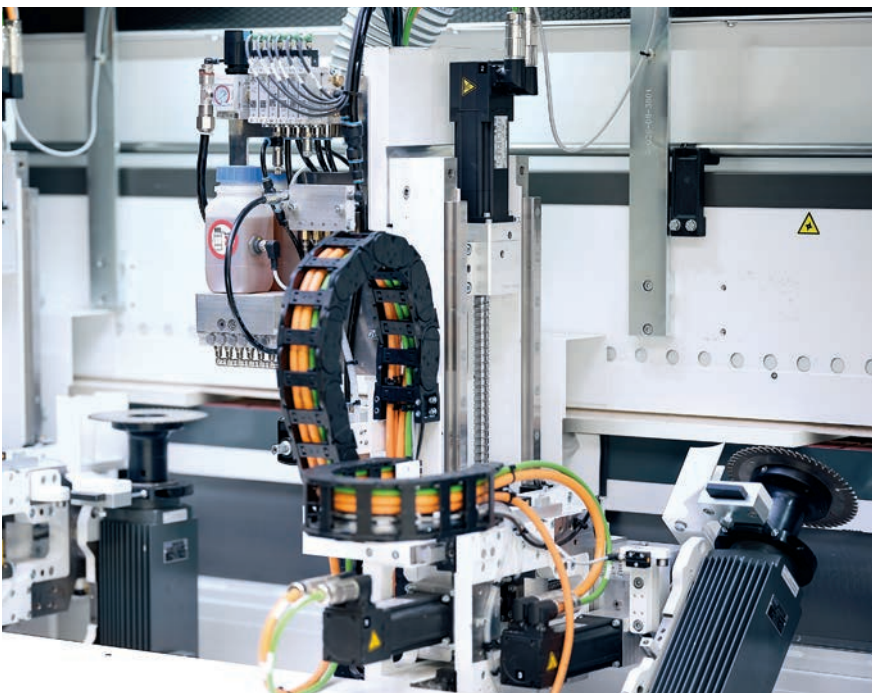

Standard trimming unit SF25 horizontal / vertical

Using the standard trimming unit SF25, grooves and rebates are trimmed precisely inside the machine without the need for an additional processing operation. Simple and quick tool change with high repeat accuracy possible with the HSK-Push-Button.

Automation to suit every need

- Automatic adjustment of groove position and / or groove depth
- Automatic changeover between: grooving in upper or bottom side of workpiece or grooving from the edge side by swiveling the grooving motor.
- Reduced chip-to-chip time: due to servo-drives when changing the groove or due to intermittent control.



For you more than ...

1,350

service employees worldwide

90 %

less on-site service thanks to successful remote diagnosis

5,000

customer training sessions per / year

150,000

machines, all electronically documented in 28 different languages – in eParts

HC LIFE CYCLE SERVICES

Optimal service and individual consultations are included in the purchase of our machines. We support you with service innovations and products which are especially tailored to your requirements. With short response times and fast

customer solutions we guarantee consistently high availability and economical production – over the entire life cycle of your machine.



TELESERVICE

- Hotline support via remote diagnosis by our trained experts regarding control, mechanics and process technology. Thus, more than 90% less on-site service required and consequently a faster solution for you!
- The ServiceBoard App helps to solve tasks in a fast, simple and concrete way. This is achieved by mobile live video diagnosis, automatic sending of service requests or the online spare parts catalog eParts.



SPARE PARTS SERVICE

- High spare parts availability and fast delivery.
- Ensuring quality by predefined spare parts and wear parts kits, comprising original spare parts.
- Identify and inquire for spare parts online under www.eParts.de 24/7, or buy even faster and more comfortably in the new HOMAG Webshop eCommerce.



FIELD SERVICE

- Increased machine availability and product quality by certified service staff.
- Regular checks through maintenance / inspection guarantee the highest quality of your products.
- We offer you the highest availability of technicians in order to reduce downtimes in case of unpredictable troubles.

Productivity – only as good as the control system

To increase the productivity of machine lines and production cells, HOMAG relies upon the PC53 production line control system. This allows more workpieces to be processed per shift, and offers scope for economical and varied production. This not only cuts out operating errors but also allows a reduced staffing requirement.

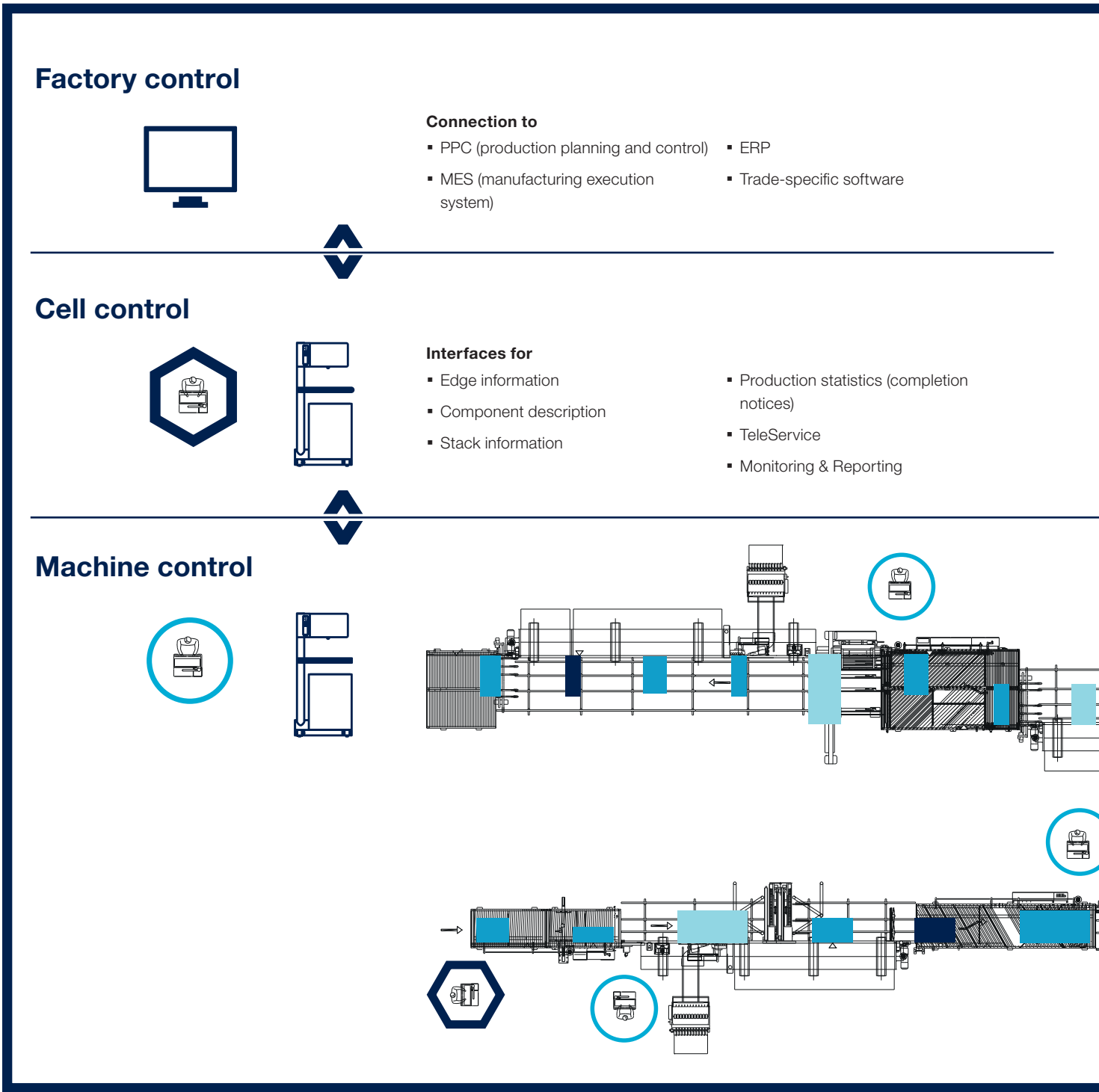

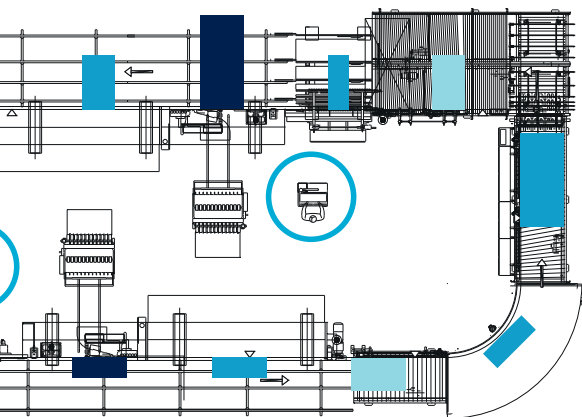
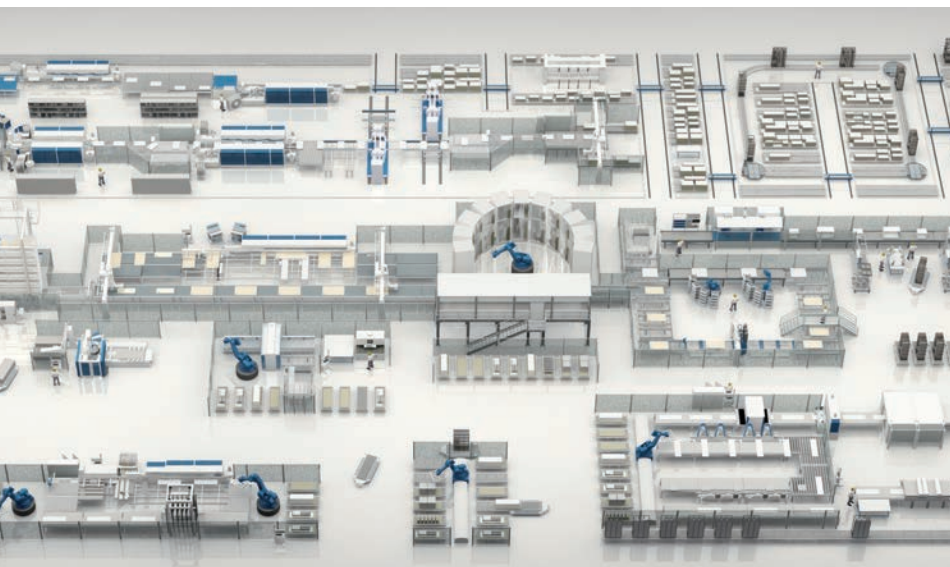

Functional characteristics for improved performance*

- Central production cell operation and monitoring
- Automatic data distribution in the production cell by part tracking and machine networking
- Production sequence control using list management
- Improved performance due to automatic cyclical output and calculation of the gap between workpieces
- Edge preview to reduce standstill times due to missing edging material

Functional characteristics for data organization*

- Central generation and management of component information in an MS-SQL database
- Component identification through automatic and manual barcode reading systems
- Component identification using labeling and ink jet solutions
- Stack management with integrated printout of stack accompanying documents

Functional characteristics to enhance availability*

- woodScout diagnostic system for central display of all line error messages at the cell master computer
- Fast, reliable troubleshooting and remedy using the worldwide teleService

*Some functional characteristics and interfaces are optional

The next generation of powerTouch: **powerTouch2**

Faster, clearer, easier to use: reap the benefits of our powerTouch touch user interface, which has been developed further. We have optimized our standardized operating concept further and adapted it to the needs of our customers. You can now control your HOMAG machines

more quickly and more intuitively. The new and contemporary design is clearly structured. The innovative touch operation is designed to enable you to get the desired result easily and comfortably.



Our successful powerTouch philosophy – **standardized, simple, ergonomic, evolutionary** – consistently further developed

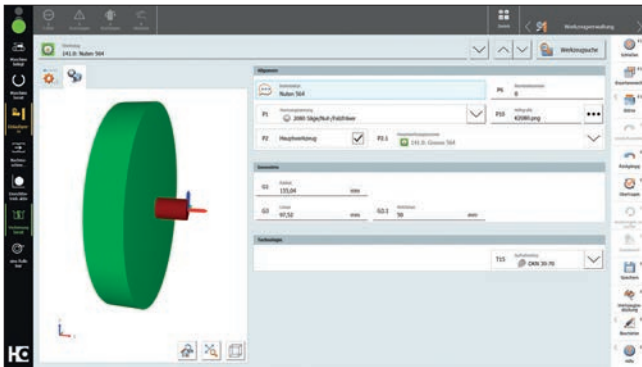

Clearer structure

The structure of the powerTouch2 screen is even clearer. You only see the information that is relevant for you. The important points at a glance – but you still have all the details. All in a fresh, attractive design.

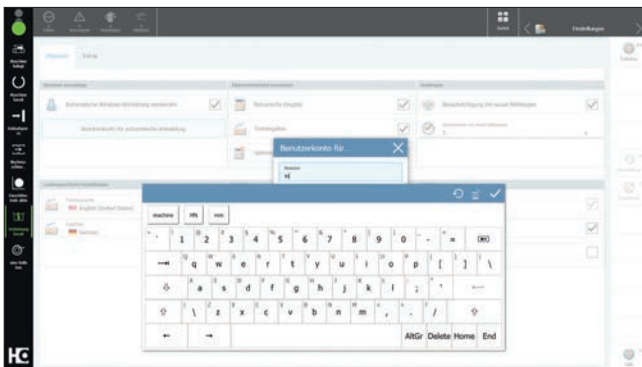

Even faster

With the new powerTouch generation, you can enter or change data on the machine more quickly. This saves you up to 30% of time compared to the previous version. This is all possible thanks to new features, such as automatic word completion, a pop-up keyboard that can be kept open, and Windows-like functions such as the ability to select frequently used actions directly via the start button.

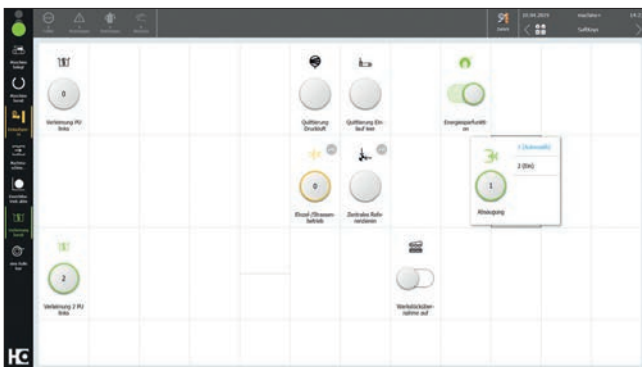

More intuitive

Operating the machine is child's play. Many of the functions are similar to those of a smartphone or tablet and will therefore be familiar to you. Even beginners will feel immediately at ease and will soon be able to control the machine comfortably.

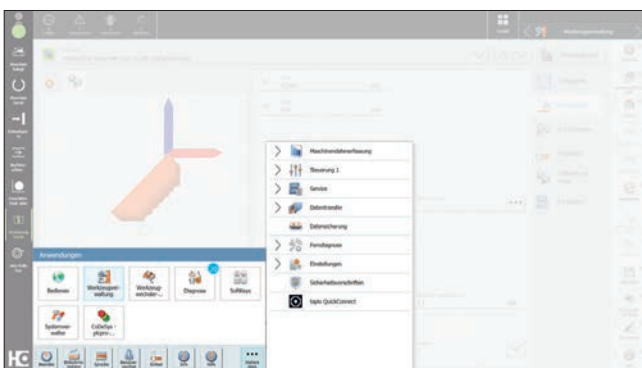

More comfortable

We have also improved the traffic light dialog and the „Start“ menu. When you press and hold the program icon, not only the possible actions are displayed, you can also access and activate them directly. Operation is therefore immediate and you do not lose any time opening applications. What's more, for the applications, illustrations and additional information can be displayed instead of simple program icons. This also provides more transparency and avoids unnecessary navigation into applications.

Software solutions with powerTouch2

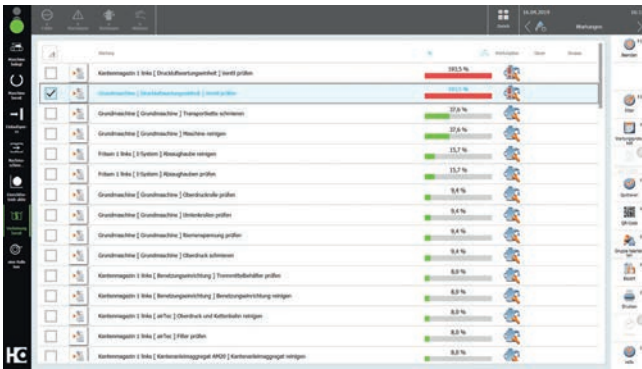

Evaluation with MMR Basic

The software evaluates the productivity of your machine and supplies usage-dependent maintenance notifications.



MMR Professional (option)

The MMR Basic upgrade additionally evaluates shifts, analyzes error messages and permits a link to be created to the data evaluation center in the office.

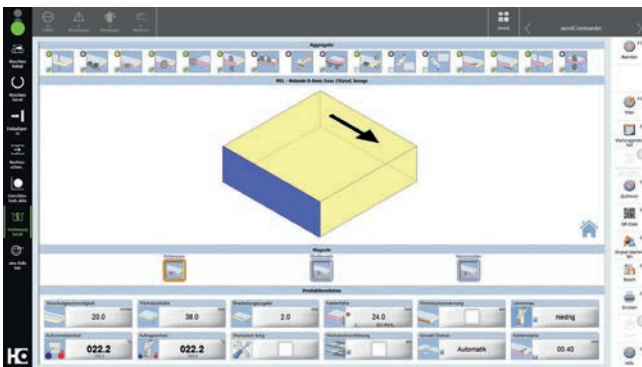

Programming with woodCommander

User-friendly programming system using graphically supported input screens.

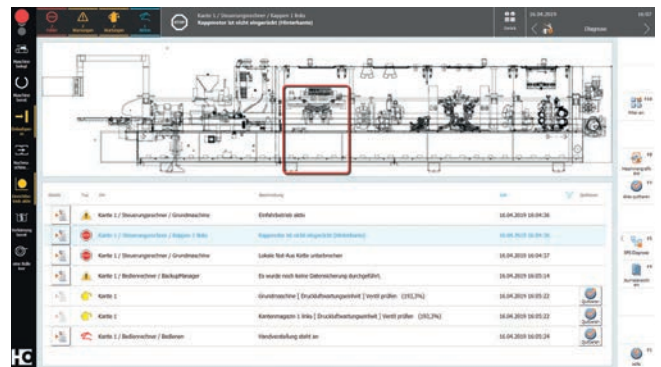

woodScout diagnostic system (option)

Alongside error messages in plain text, woodScout also provides a graphic representation of the error location. In addition to the system's expert knowledge database, users can store their own troubleshooting solutions.



Cell control woodFlex (option) Asset tracking and control of machines in cells.



Support via TeleServiceNet Soft

High-speed servicing and assistance through targeted troubleshooting and support over the Internet.

Apps that make working life easier

tapio
Partner

DataSave

- Protects machine and configuration expertise
- Faster service in case of breakdown
- Saves time when restarting production
- Saves on maintenance costs
- Automatic backups of several machines

ServiceBoard

- Create service cases quickly and easily and send them to the correct service partner
- Live video diagnostics to solve service cases with image support
- Video reduces the language and distance barriers
- Also works without a machine connection to tapio (and is therefore ideal for older machines)

MachineBoard

- Push notifications
- Machine data and status can be viewed from anywhere in real time
- Lists of errors, warnings, maintenance tasks and actions
- Displays the remaining time until the next intervention by the machine operator

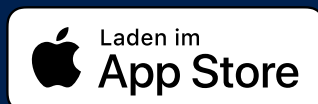

Free demo for all tapio apps, no registration required. Simply download and test.

tapio is the open wood industry ecosystem

This means that everyone involved in the wood industry can participate.
Because together with our business partners, we develop digital solutions for everyone.

Currently available in the EU and Switzerland.

(Due to the fast pace of the IT-landscape, the compatibility to the tapio platform is warranted for five years.)

HOMAG Group AG

info@homag.com

www.homag.com



YOUR SOLUTION