

HOLYTEK

Auto. Edge Banding Machine

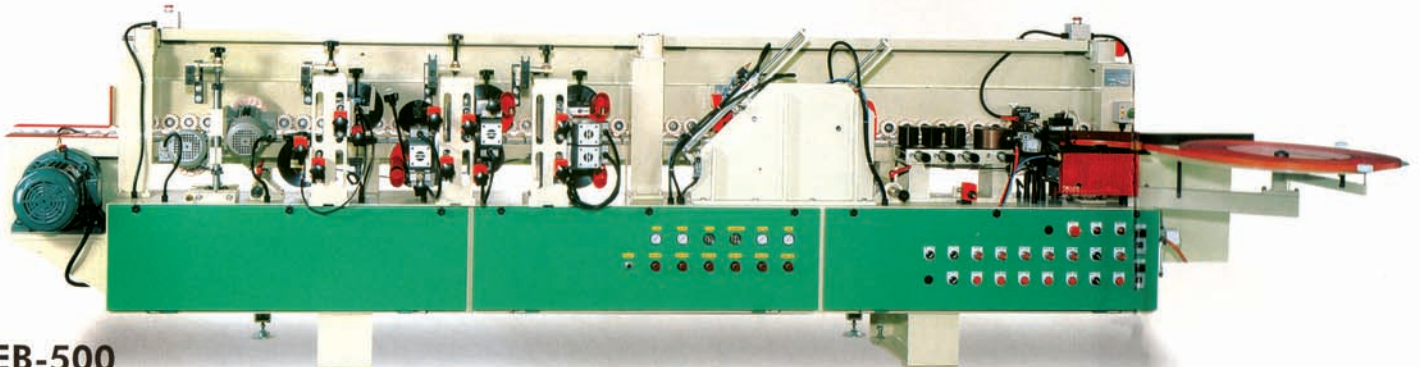

EB-500

Veneer Infeed>Coil Cut-off>Gluing and Press>End Cutting>End Trimming>Fine Trimming>Scraping>Buffing



EB-500CL

Veneer Infeed>Coil Cut-off>Gluing and Press>End Cutting>End Trimming>Fine Trimming>Scraping>Buffing

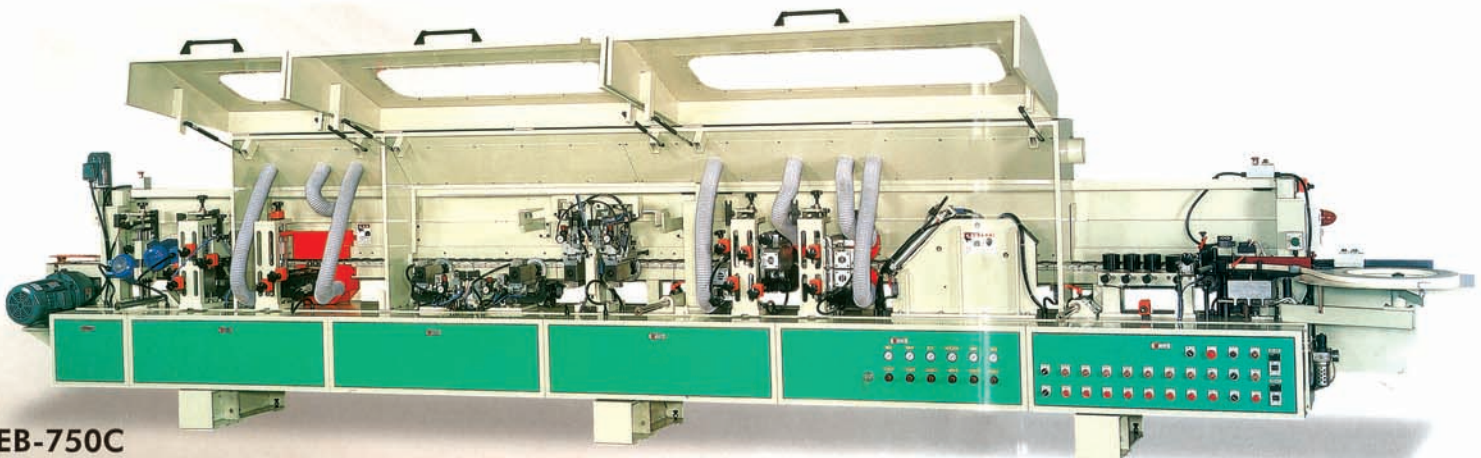

EB-750C

Veneer Infeed>Coil Cut-off>Gluing and Press>End Cutting>End Trimming>Fine Trimming>Top Profile Trimming>Bottom Profile Trimming>Scoring Saw>Scraping>Buffing

These automatic edge banding machines accommodate coiled veneer, striped veneer, 3mm edge strip and wood strip. Each machine is constructed of various working mechanisms, providing maximum flexibility of operation. The unit employs two lines of continuous pressure wheels and high tensile link chain conveyor for extremely smooth feeding performance. These quality proven automatic edge banding machines integrate many fine features such as maximum dependability, high efficiency, high banding quality, and minimum trouble.

MODEL ITEM	1	2	3	4	5	6	7	8	9	10	11
EB-350	✓	✓	✓	✓		✓					
EB-400	✓	✓	✓	✓		✓				✓	
EB-450	✓	✓	✓	✓		✓			✓	✓	
EB-500	✓	✓	✓	✓	✓	✓			✓	✓	
EB-580	✓	✓	✓	✓	✓	✓	✓		✓	✓	
EB-660	✓	✓	✓	✓	✓	✓	✓	✓	✓	✓	
EB-750	✓	✓	✓	✓	✓	✓	✓	✓	✓	✓	✓

Above table provides various basic working mechanism combinations for reference only. For models over EB-450, custom combinations of working mechanisms are available to meet specific customer requirements. Also, various optional equipment may be integrated with the working mechanisms.

Basic Working Mechanisms

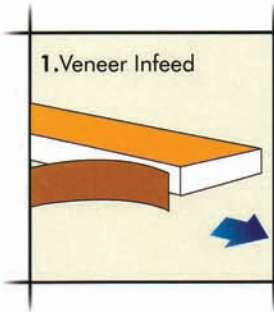

1. GLUING UNIT 3001

Employs 2.4 kW heater with 4 kg tank capacity. Glue heating can be quickly accomplished in 25 minutes. Glue tank is easy to remove, for convenient cleaning and maintenance.

2. INFEEED UNIT 3004

Features maximum stability when feeding coiled or striped veneer. Easy to change over and adjust.

3. PRESSING UNIT 3101

It consists of 4 pressure rollers with upward and downward tilting function. Correct pressure is achieved through adjustment on air system and screw, ensuring superior tightness of pressing. Also, pressure can be varied to meet edging material thickness.

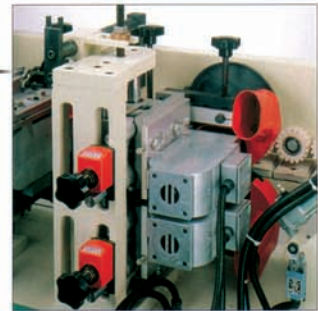
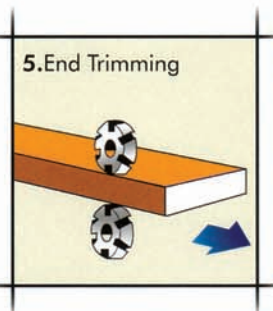
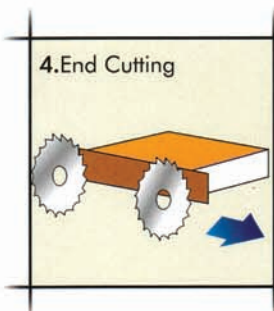
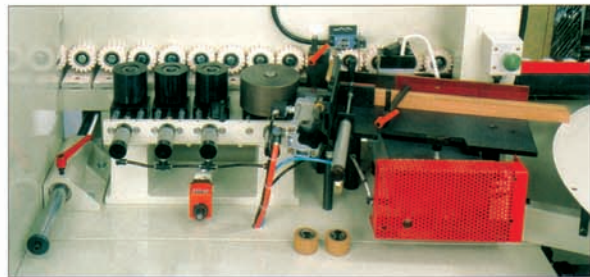
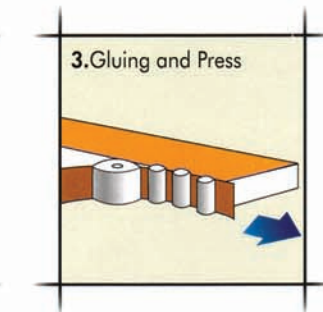
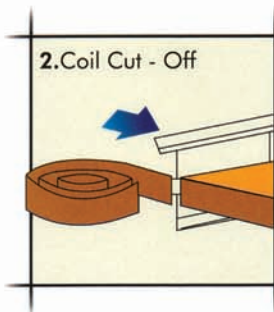

4. TILTING END CUTTING UNIT 3203

The cutting unit features double tilting spindles. The mechanism can be tilted up to 20° for chamfering and cutting. Two motors can be adjusted individually to perform front and rear end cutting operations.

5. SINGLE SIDE TOP AND BOTTOM TRIMMING UNIT 3301

Suitable for rough trimming and over 3mm surface smoothing for wood strips. This rough trimming unit is often used together with top and bottom fine trimming unit. Motor and trimming cutter are easy to remove.

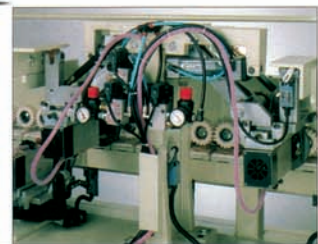
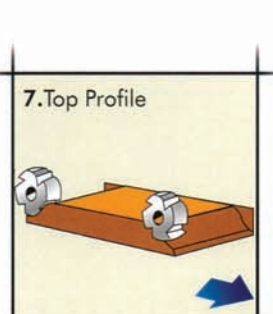
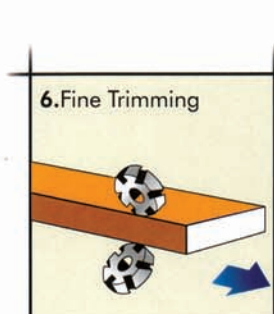

6. DOUBLE SIDE TOP AND BOTTOM TRIMMING UNIT 3303

The motor can be tilted 0°-25° to suit various types of veneer. The system can perform R2-R5 radius trimming operations. Motor and trimming cutter are easy to remove.

7. TOP PROFILE TRIMMING UNIT 3503-1

The trimming unit is suitable for single side trimming for K.D. furniture and kitchen cabinets, doors, etc. Two motors are adjusted individually.

8. Bottom Profile

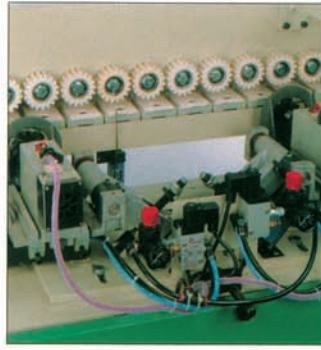
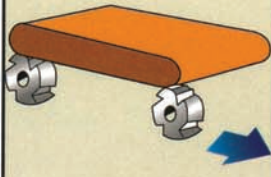

8. BOTTOM PROFILE TRIMMING UNIT 3503-2

The unit has the same function as the top profile trimming system. It is often used together with top profile trimming unit to perform trimming operations on the 3rd and 4th surface for thick PVC. Also suitable for double profile trimming operations.

9. Scraping

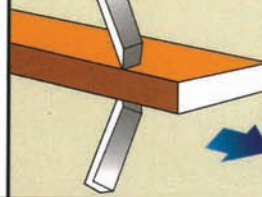

9. SCRAPING UNIT 3501

The unit is used for eliminating the cutting mark on PVC edges, or eliminating glue dust. Equipped with air blowing device for blowing off waste glue dust.

10. Buffing

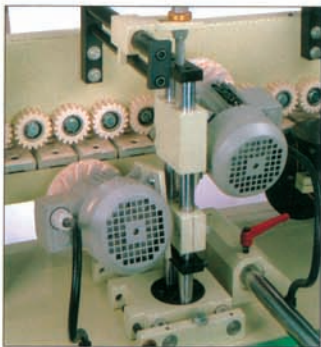
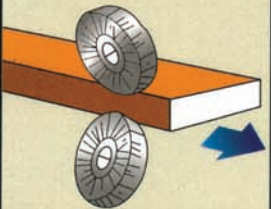

10. TOP AND BOTTOM BUFFING UNIT 3505

The buffing wheel can be tilted 0°- 45° vertically and 15° laterally. The unit is suitable for removing the glue dust and creating a smooth PVC edge. When requested, #3507 buffing wheels are available for uniform usage.

11. Scoring Saw

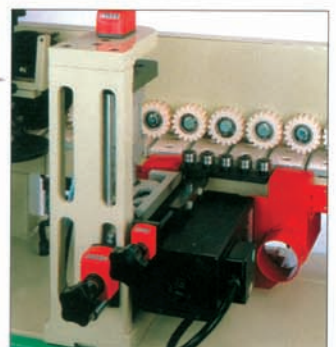
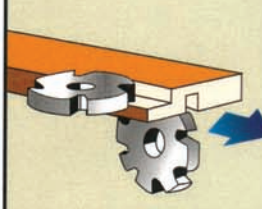

11. SCORING SAW UNIT 3401

When the scoring saw protrudes over the conveyor, the specially designed guide wheel helps to achieve straight and constant depth of groove.

Optional Accessories

12. Profile Buffing

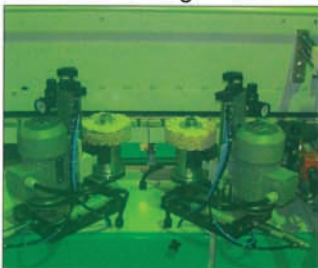

12. PROFILE BUFFING UNIT 3506

Equipped with specially designed tracing device. The profile buffing unit is often used together with top and bottom trimming unit. It is suitable for completely removing glue dust from the profile, and creates an added buffing effect.

13. Oscillating Sanding



13. OSCILLATING SANDING UNIT 3508

The cam drive sanding belt oscillation sands the edging material with ease, and allows for complete utilization of the entire sanding belt. The unit is especially ideal for fine sanding on wood veneer.

14. Rocker Arm Type End Cutting



14. ROCKER ARM TYPE END CUTTING UNIT 3201

The rocker arm motion is operated by a pneumatic device. The unit performs front and rear cutting motions. Also, it can perform end chamfering by using a chamfering sawblade. A specially designed mechanism providing 20 -25 M/min end cutting speed.

15. HOT AIR BLOWER



15. HOT AIR BLOWER

In case 3mm. PVC or ABS material is applied for edge banding, the hot air blower will maintain the original color of the banding material.

SPECIFICATIONS 說明

Workpiece Length	160-up	Edging Thickness	0.4-6 / (13)
Workpiece Width	65-up	Feed Speed	6-25 M/min
Workpiece Thickness	10-60	Air Pressure Required	6 kg/cm ²

MODEL	EB-350	EB-400	EB-450	EB-500	EB-580	EB-660	EB-750
Feed power	1.5 kw	1.5 kw	2.3 kw	2.3 kw	3.8 kw	3.8 kw	4.0 kw
Total horsepower	7 kw (9.5 hp)	8 kw (10.5 hp)	8.5 kw (11.5 hp)	11 kw (15 hp)	13.5 kw (18 hp)	14.5 kw (19.5 hp)	18 kw (24 hp)
Net weight	1,230 kgs	1,390 kgs	1,570 kgs	1,700 kgs	2,170 kgs	2,600 kgs	3,000 kgs
Gross weight	1,530 kgs	1,740 kgs	1,970 kgs	2,150 kgs	2,670 kgs	3,200 kgs	3,750 kgs
Machine dimensions	3,700x1,800x1,450	4,220x1,800x1,450	4,650x1,800x1,450	5,200x1,800x1,450	6,100x1,800x1,450	6,800x1,800x1,450	7,700x1,800x1,450
Packing dimensions	3,570x920x1,500	4,100x920x1,500	4,520x920x1,500	5,150x920x1,500	6,000x920x1,500	6,670x920x1,500	7,570x920x1,500

The model number with "C" means that the machine equips with splash guard and increases around 200-300mm in overall length.

WORKING UNIT

END CUTTING UNIT	POWER	0.67 HP x 2
	RPM	12,000
	CUTTER	120 x 20 x 2.6
FLUSH TRIMMING UNIT	POWER	1 HP x 2 (2 HP x 2)
	RPM	12,000
	CUTTER	70 x 16 x 14.3
FINE TRIMMING UNIT	POWER	1 HP x 2 (0.67 HP x 2)
	RPM	12,000 (18,000)
	CUTTER	70 x 16 x 14.3 (or 73 x 16 x 16 R2~R5)
TOP PROFILE TRIMMING UNIT	POWER	0.5 HP x 2
	RPM	12,000 (18,000)
	CUTTER	73 x 16 x 16 (R2~R5)
BOTTOM PROFILE TRIMMING UNIT	POWER	0.5 HP x 2
	RPM	12,000 (18,000)
	CUTTER	73 x 16 x 16 (R2~R5)
BUFFING UNIT	POWER	0.5 HP
	RPM	1,720
	BUFFING	150 x 22 x 24
SCORING SAW UNIT	POWER	4 HP x 1
	RPM	7,500~9,000
	CUTTER	175~200 x 25 x 3 (3~8)
CORNER BUFFING UNIT	POWER	0.5 HP
	RPM	2,780
	BUFFING	150 x 22 x 40
EDGE SANDER UNIT	POWER	2 HP
	RPM	1,720
	SANDER	100 x 635

All specifications, designs and characteristics shown on this catalogue are subject to change without prior notice.

HOLYTEK

HOLYTEK INDUSTRIAL CORP.
 9F-I, NO. 400, SEC. 1, CHANG PING RD., TAICHUNG, TAIWAN, R.O.C.
 TEL: 886-4-2245-2818(Rep.) FAX: 886-4-2243-6928
 E-mail: holytek@ms13.hinet.net http://www.holytek.com.tw