

Holzbearbeitungsmaschinen

Woodworking machines • Machines à Bois • Macchine per la lavorazione del legno



BÄUERLE



seit 1855 – 140 Jahre

Fräsmaschinen

Spindle Shapers
Toupies • Frese



SFM 101-3



SFM 102-3



SFM 200-3

5,5
7,5
5/6
7,5/9,5

5/6
7,5/9,5

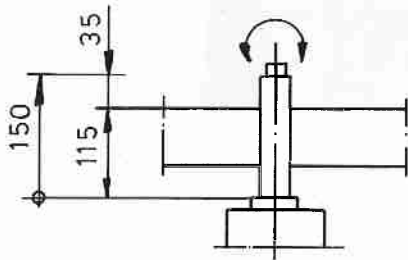
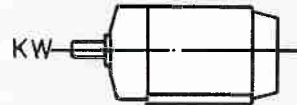

(1500)
3 000
4 500
6 000
9 000
12 000
n. 1/min.

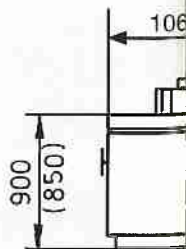
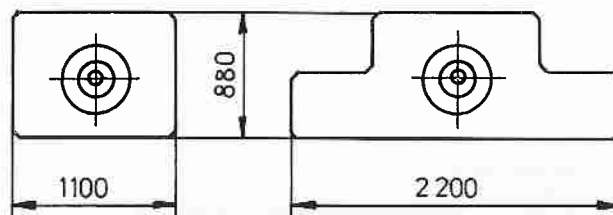
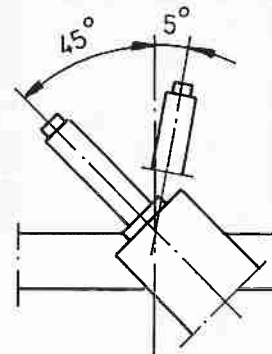

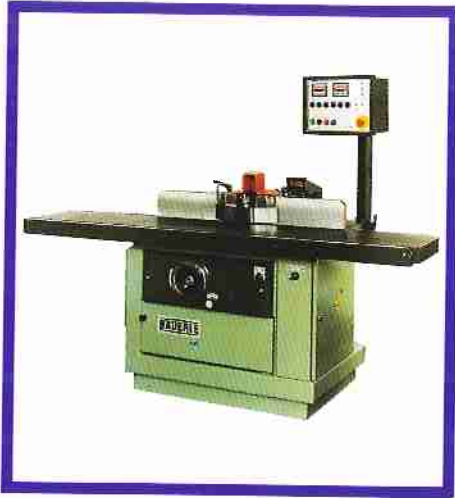

SFM 201-3



PM 250 PM 510

kW	11	15
B	260	510
H	200	200
n 1/min	6000 standard 4800 standard 4000 option	6000 standard 4800 standard 4000 option

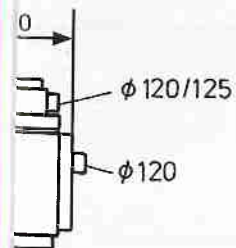
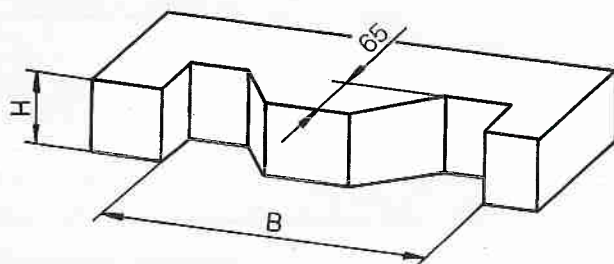
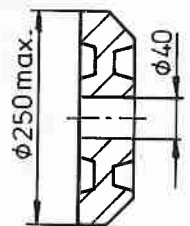
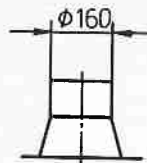
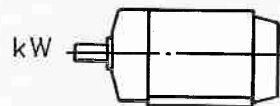

Kreissägen

Circular-Saws
Scies Circulaires • Seghe circolari



DS II



PKS

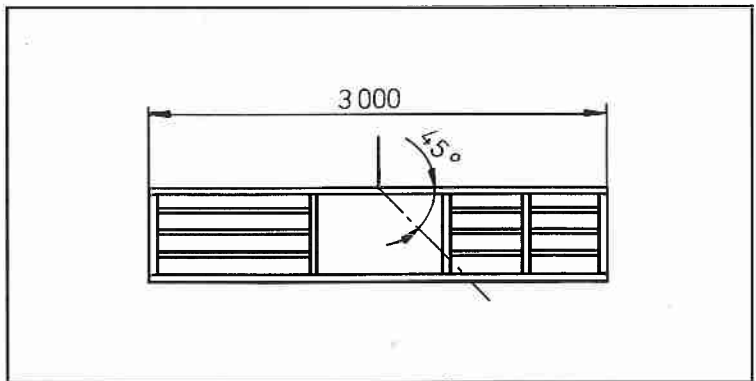
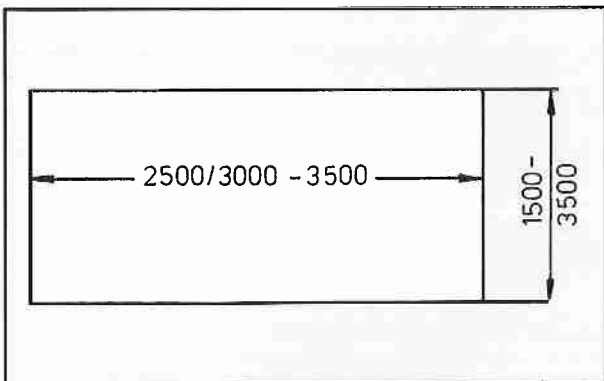
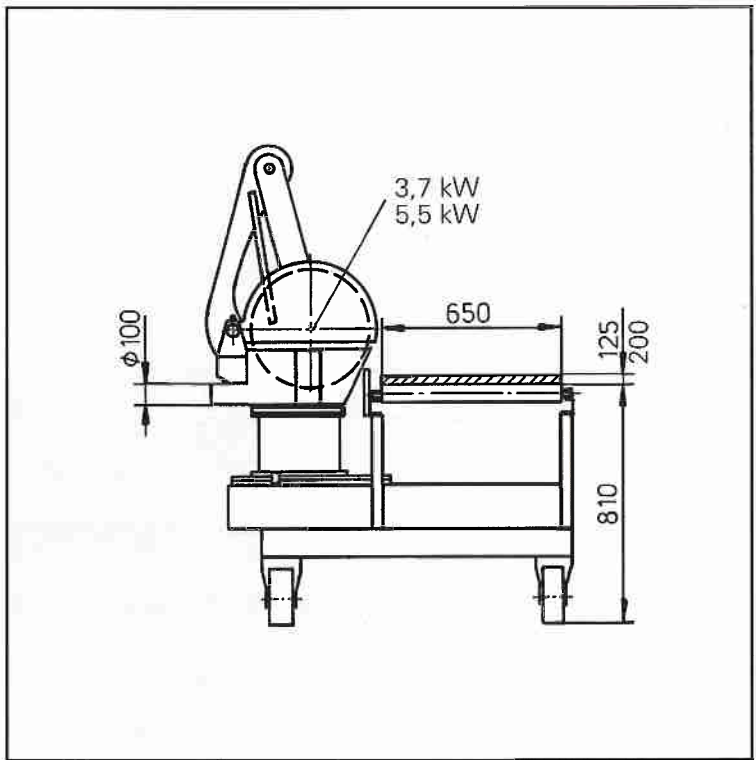
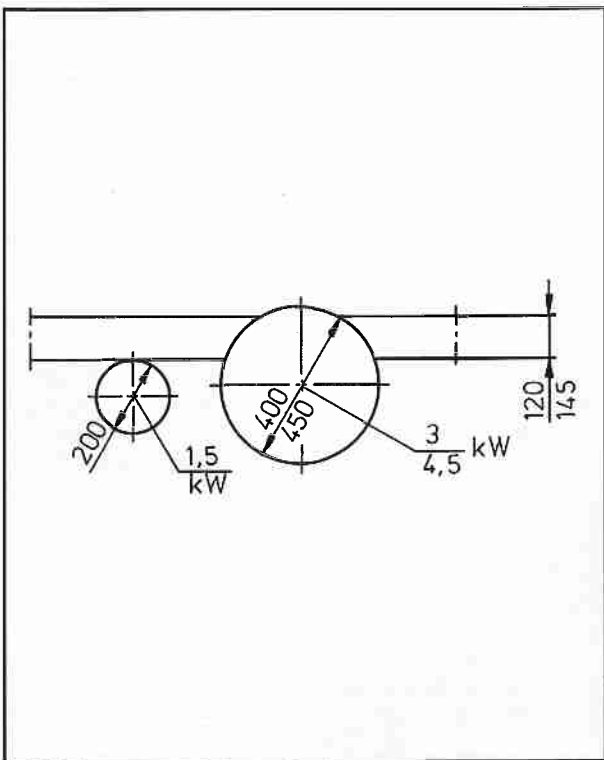

Bandsägen

Bandsaws
Scies à ruban • Seghe a nastro



B 40 B 60 B 80

BS 631 BS 801

SB	390	580	780
SH	270	370	450
kW	1,5	2,2	4
HT	860	875	970
W	20°	20°	20°
H	1790	2000	2450
LT	500	830	1100
D2	∅ 120	∅ 120	∅ 120
D3	-	-	∅ 100

610	780	SB
385	500	SH
3	3	kW
940	970	HT
30°	30°	W
2110	2460	H
925	1230	LT
∅ 100	∅ 100	D2
∅ 100	∅ 125	D3

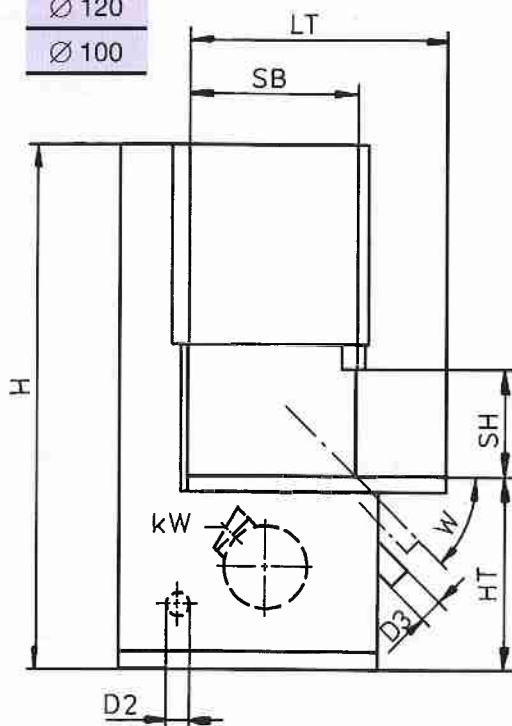

Hobelmaschinen

Planers
Raboteuses • Pialle



AS 510

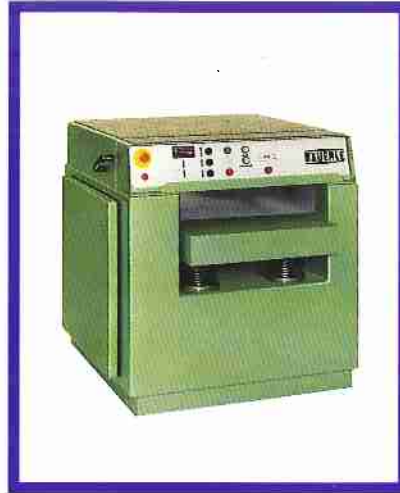

DM 630



HCH 510/630

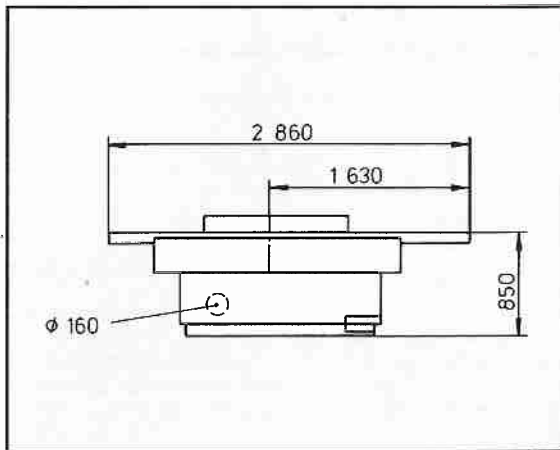

HB = 510 kW = 5,5

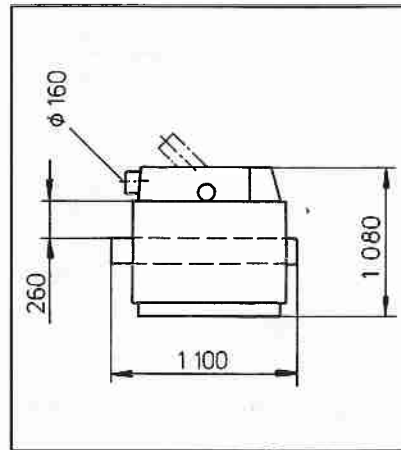

HB = 630 kW = 7,5 + 11

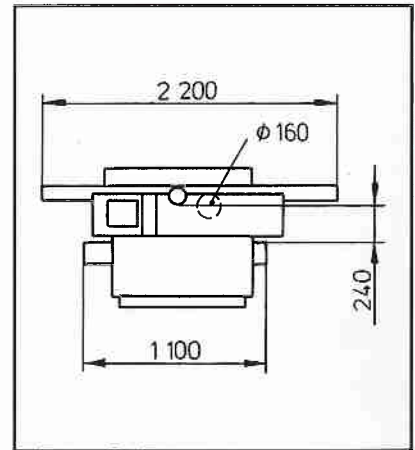

HB = 510
kW = 7,5

HB = 630
kW = 7,5

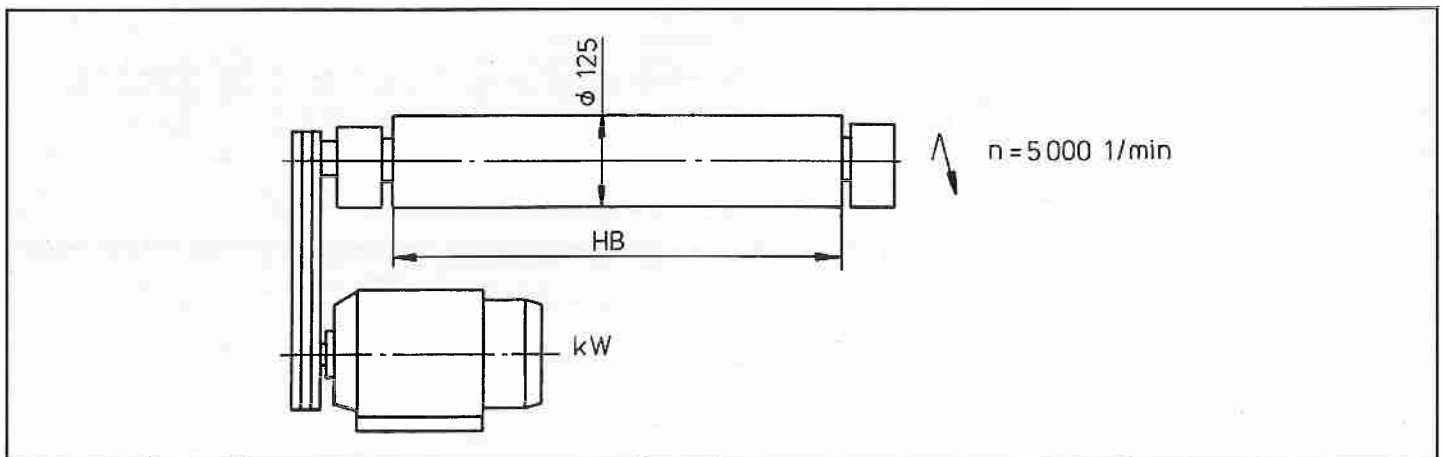

BÄUERLE MASCHINENFABRIK GMBH & CO.
73560 Böbingen/Rems · Bahnhofstraße 25 · Telefon (071 73) 1 87-0
Telefax Zentrale + VK (071 73) 1 87 12 · EK-ET-TB (071 73) 1 87 11