

The Scanhugger HL 2/7/10 shredder is designed for shredding most any type of wood waste, hardwood and softwood trim blocks, particleboard and MDF, furniture parts, paper and cardboard .

Depending on the material to be processed and the desired chip quality, the machine can be mounted with various screen sizes.

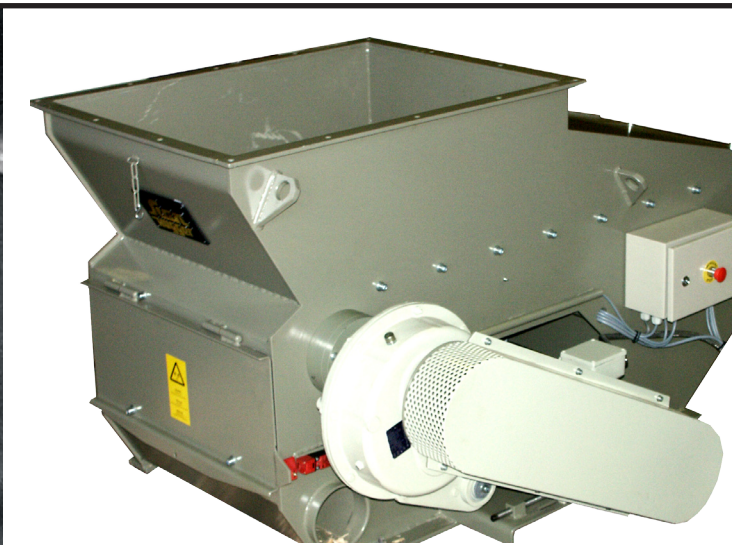

## TECHNICAL DATA:

Hopper dimension		721 x 1007 mm
Hopper volume (standard hopper)		0,6 cbm
Rotor diameter		Ø 140 mm
No. of knives	1)	20
No. of counterknives	1)	2
Rotor speed	2)	100 RPM
Main motor	2)	7,5 – 11 kW
Screen perforation	2)	15 – 30 mm
Chip length	2)	20 – 40 mm
Capacity	2)	130 - 200kg/hour
Weight		1300 kg
Sound level $L_{pa}$	3)	81 dB
1) DEPENDING ON ROTOR AND KNIFE		
2) DEPENDING ON MOTOR SIZE, MATERIAL AND SCREEN PERFORATION		
3) IN ACCORDANCE WITH ISO/DIN 11204.PREN691		



**EXCLUSIVE ROTOR AND KNIFE DESIGN [ 1-2 ]**

the knife and knife precision mounting arrangement ensure a long tool life, optimal chip quality and easy maintenance.

**CHIP QUALITY [ 3 ]**

the rotor, knife design together with the heavy duty chip screen ensure a high chip quality. The screen has square holes. Hole sizes range from 15 – 30 mm.

**OUR SCANHUGGER LINE-UP [ 4 ]** , coupled with a full range of options and auxiliary equipment enables us to build turnkey wood waste systems.

- auxiliary hopper extensions customized for each application
- pneumatic discharge systems
- auger and conveyor systems
- magnet systems for separation of ferrous metals from chips

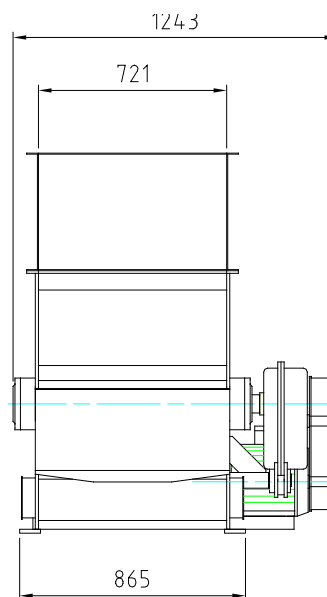
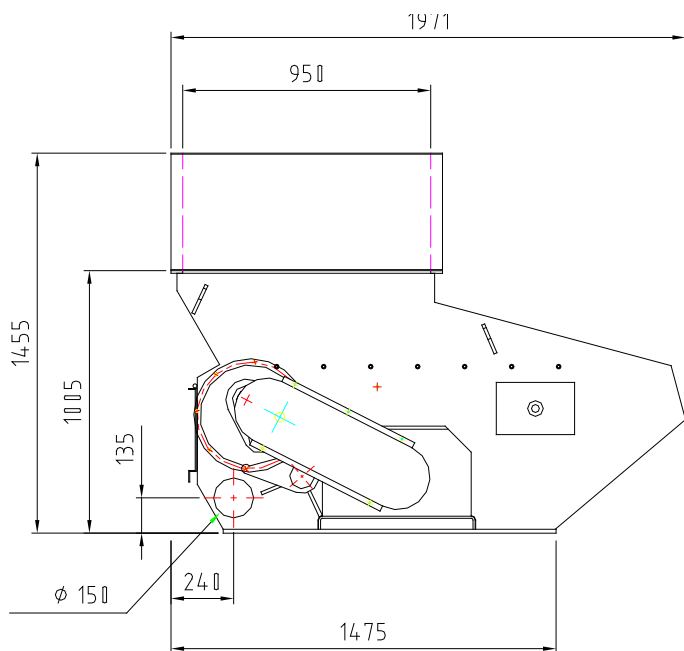

TECHNICAL ALTERATIONS RESERVED

DISTRIBUTOR: